

# ***UNIMIG***



# ***T-SERIES TIG TORCHES***

# Contents

<b>1. Installation</b> .....	<b>3</b>
1.1 T-Series TIG Torch.....	3
1.2 T-Series TIG Torch Head Replacement.....	5
<b>2. TIG Torch &amp; Consumables</b> .....	<b>6</b>
2.1 T2 TIG Torch.....	6
2.2 T3 TIG Torch.....	7
2.3 T3W TIG Torch.....	8
2.4 T4W TIG Torch.....	9

# 1. Installation

## 1.1 T-Series TIG Torch

1. Place the head gasket on to the torch head.

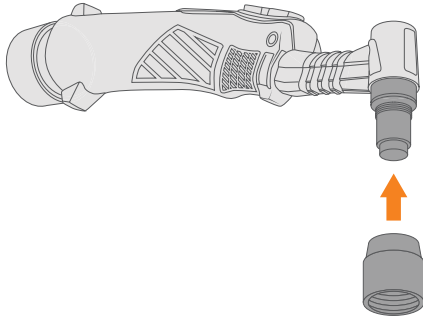

2. Screw the heat zone isolator on to the torch head. Fasten securely.

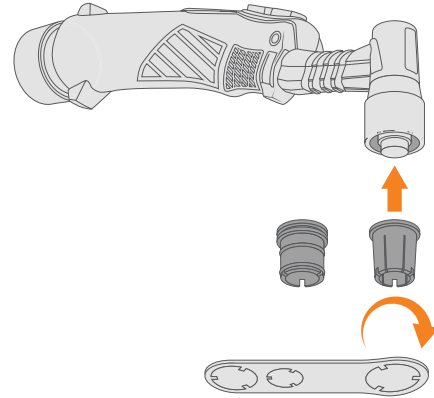

3. Insert the collet body into the torch head. Align the groove with the inside of the torch head.

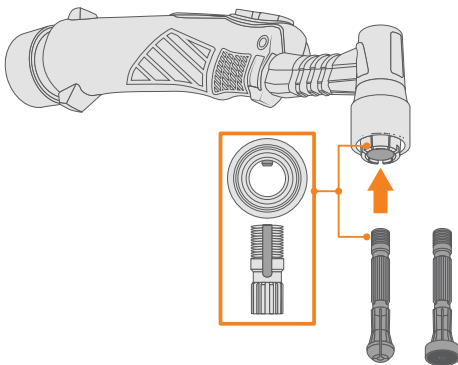

4. Screw the back cap on to the torch head, don't tighten completely.

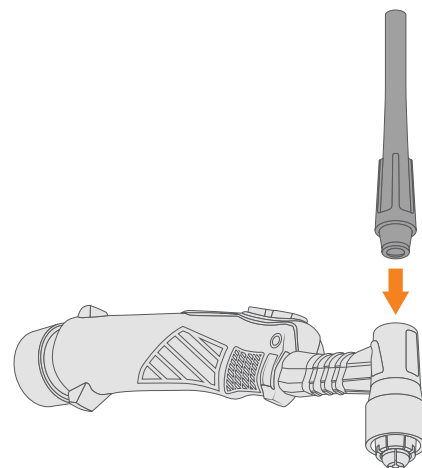

- 5.** Insert the tungsten electrode into the collet body.

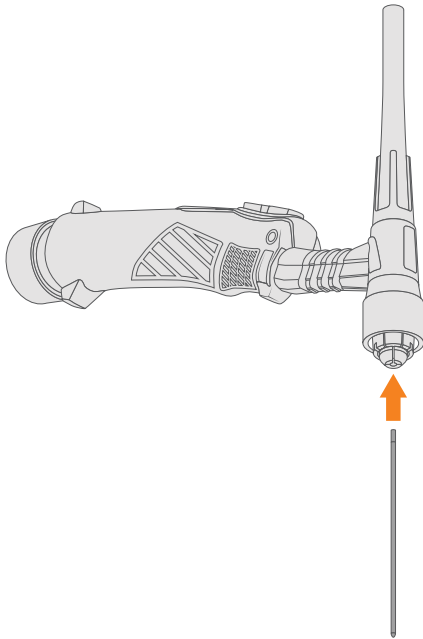

- 6.** Slide on the ceramic cup over the collet body. Twisting the ceramic cup can aid in securing the consumables in place.

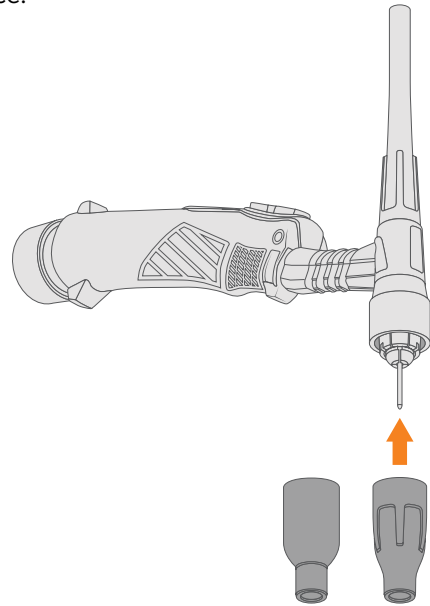

- 7.** Adjust the tungsten to the desired length, then tighten the back cap. securely.

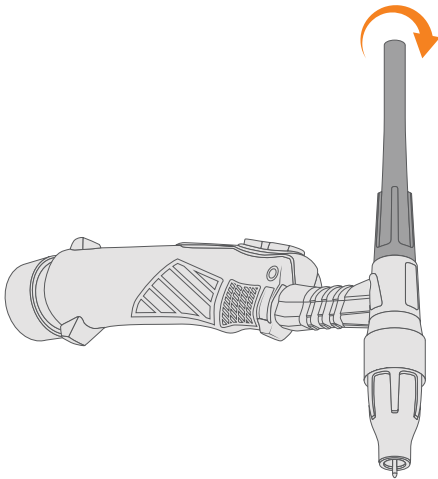

## 1.2 T-Series TIG Torch Head Replacement

1. Remove all screws on the torch body.

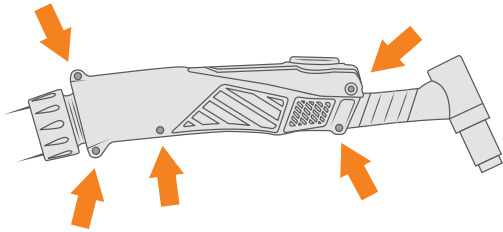

2. Remove the torch body from the torch assembly.

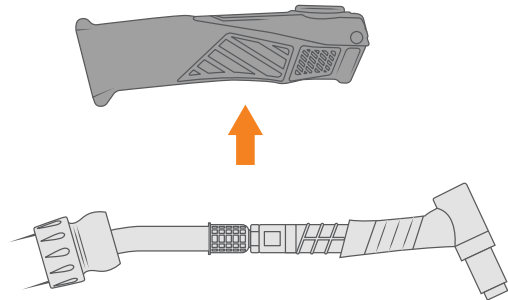

3. Unscrew the T2 torch head from the torch assembly.

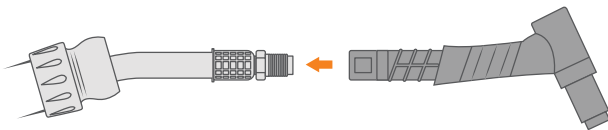

4. Screw the replacement torch head on to the torch assembly.

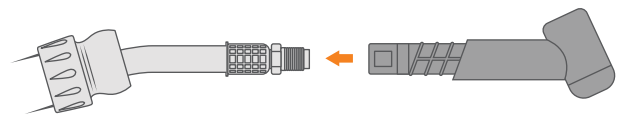

5. Replace the torch body over the torch assembly.

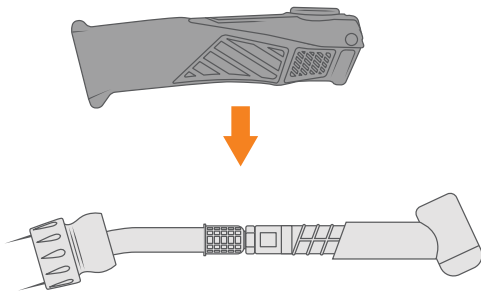

6. Replace all screws on the torch body. Fasten securely.

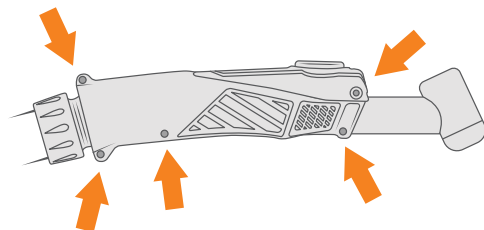

# 2. TIG Torch & Consumables

## 2.1 T2 TIG Torch

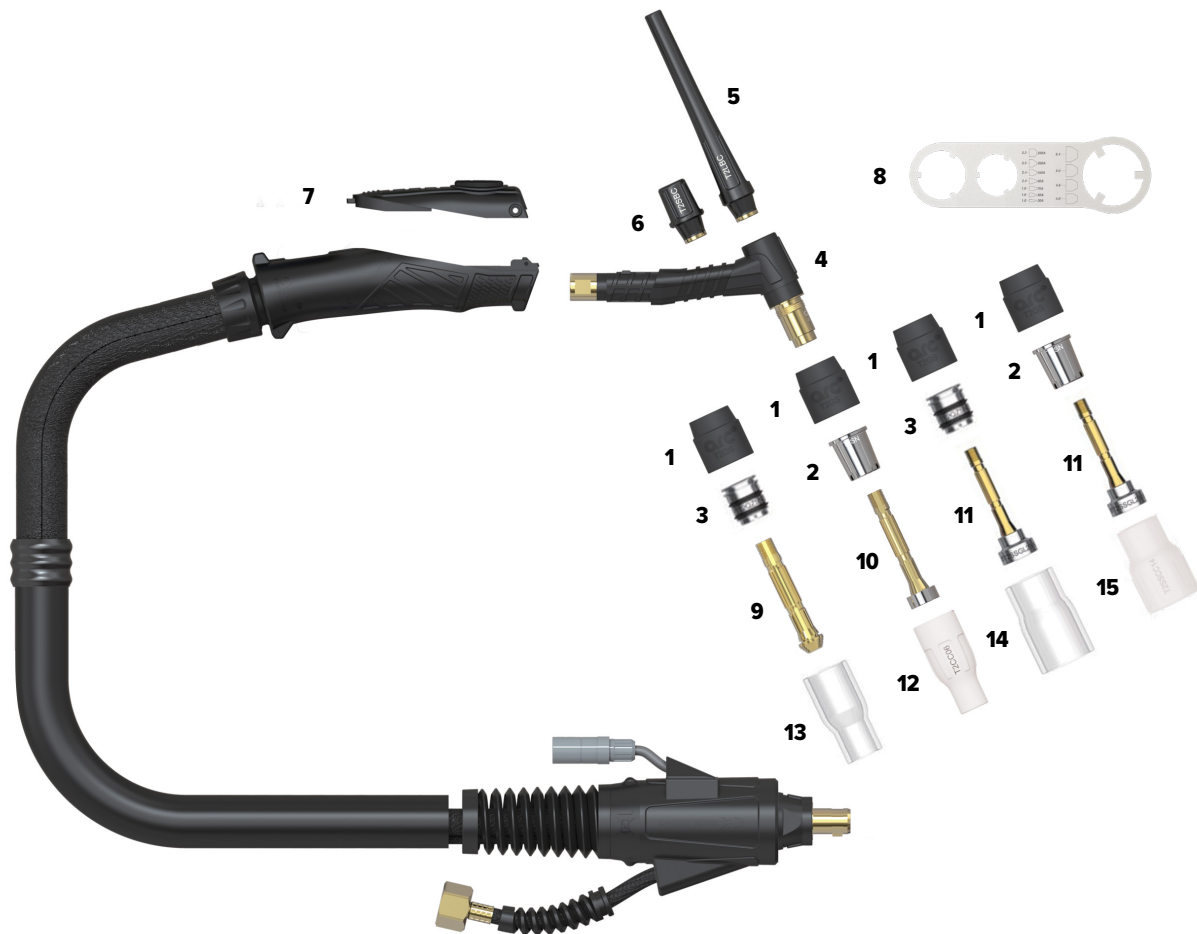

Length	Dinse 4m	Dinse 8m	Euro 4m
SKU	UMT2F4M	UMT2F8M	UMT24ME

1	UMCT2HG	HEAD GASKET SUIT T2/T3W/T4W QTY 1
2	UMCT2SN	HEAT ZONE ISOLATOR SUIT T2/T3W/T4W QTY 1
3	UMCT2QZSN	QUARTZ ZONE ISOLATOR SUIT T2/T3W/T4W QTY 1
4	UMCT2THF	TORCH HEAD FLEXIBLE SUIT T2
4	UMCT2TH	TORCH HEAD SUIT T2
5	UMCT2LBC	LONG BACK CAP SUIT T2/T3W/T4W QTY 1
6	UMCT2SBC	SHORT BACK CAP SUIT T2/T3W/T4W QTY 1
7	UMCTMS	TIG TORCH SWITCH SINGLE BUTTON SUIT T2/T3/T3W/T4W
7	UMCTMK10KP	TIG TORCH SWITCH HORIZONTAL ADJUSTMENT 10K POT SUIT T2/T3/T3W/T4W
7	U11539	TIG TORCH MODULE DIGITAL 4 BUTTON SUIT T2/T3/T3W/T4W
7	U11196	TIG TORCH MODULE BLANK SUIT T2/T3/T3W/T4W

8	UMCTSPAN	SPANNER SUIT T2/T3/T3W/T4W
9	See page 10-11	COLLET BODY
10	See page 10-11	GAS LENS COLLET BODY
11	See page 10-11	SUPER GAS LENS COLLET BODY
12	See page 10-11	CERAMIC CUP
13	See page 10-11	QUARTZ CUP
14	See page 10-11	SUPER CERAMIC CUP
15	See page 10-11	SUPER QUARTZ CUP

COOLING METHOD	Air-Cooled
DUTY CYCLE - CO2	35% @ 190A
DUTY CYCLE - MIXED GAS	35% @ 135A
DINSE SIZE	35/50
ELECTRODE SIZE	1.0-4.0mm
STANDARD	EN60974-7

### 2.2 T3 TIG Torch

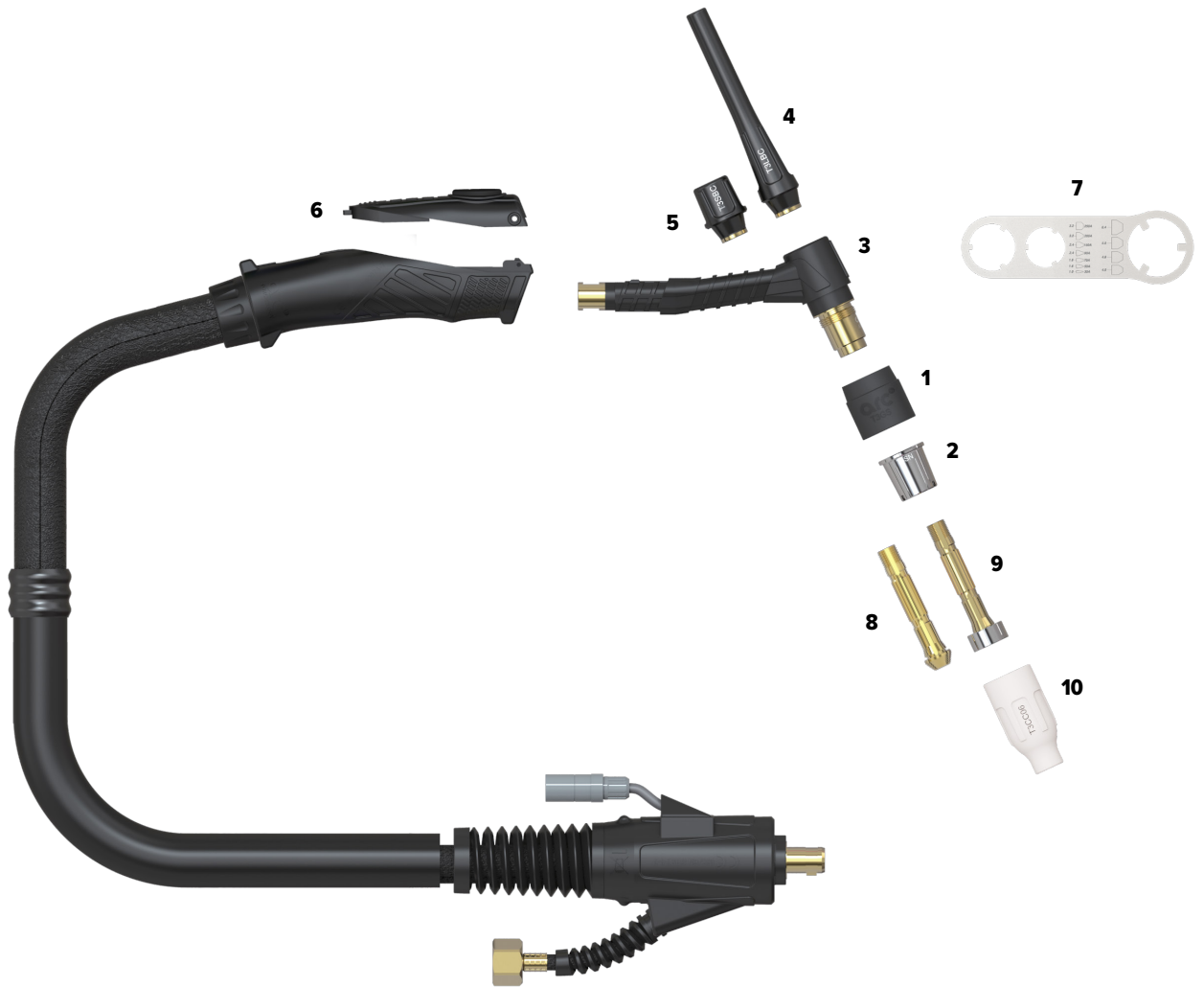

Length	4m	8m
SKU	UMT3F4M	UMT3F8M

1	UMCT3HG	HEAD GASKET SUIT T3 QTY 1
2	UMCT3SN	HEAT ISOLATOR SUIT T3 QTY 1
3	UMCT3THF	TORCH HEAD FLEXIBLE SUIT T3 QTY 1
3	UMCT3TH	TORCH HEAD SUIT T3
4	UMCT3LBC	LONG BACK CAP SUIT T3 QTY 1
5	UMCT3SBC	SHORT BACK CAP SUIT T3 QTY 1
6	UMCTMS	TIG TORCH SWITCH SINGLE BUTTON SUIT T2/T3/T3W/T4W
6	UMCTMK10KP	TIG TORCH SWITCH HORIZONTAL ADJUSTMENT 10K POT SUIT T2/T3/T3W/T4W
6	U11539	TIG TORCH MODULE DIGITAL 4 BUTTON SUIT T2/T3/T3W/T4W
6	U11196	TIG TORCH MODULE BLANK SUIT T2/T3/T3W/T4W
7	UMCTSPAN	SPANNER SUIT T2/T3/T3W/T4W
8	See page 10-11	COLLET BODY
9	See page 10-11	GAS LENS COLLET BODY
10	See page 10-11	CERAMIC CUP

COOLING METHOD	Air-Cooled
DUTY CYCLE - CO2	35% @ 240A
DUTY CYCLE - MIXED GAS	35% @ 170A
DINSE SIZE	35/50
ELECTRODE SIZE	1.0-4.0mm
STANDARD	EN60974-7

### 2.3 T3W TIG Torch

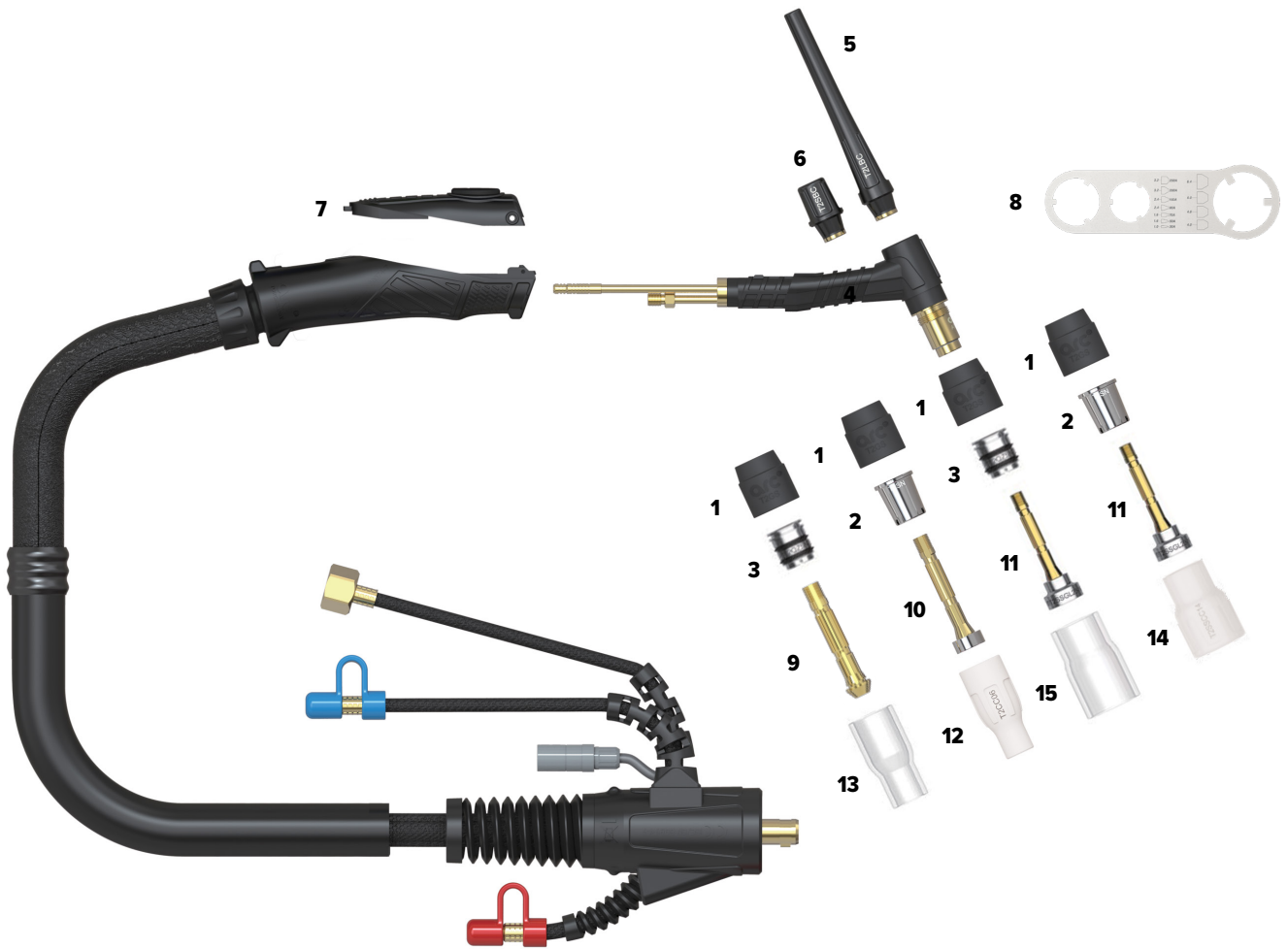

Length	4m	8m
SKU	T3W-3KHL-4M	T3W-3KHL-8M

1	UMCT2HG	HEAD GASKET SUIT T2/T3W/T4W QTY 1
2	UMCT2SN	HEAT ZONE ISOLATOR SUIT T2/T3W/T4W QTY 1
3	UMCT2QZSN	QUARTZ ZONE ISOLATOR SUIT T2/T3W/T4W QTY 1
4	UMCT3WTHF	TORCH HEAD FLEXIBLE SUIT T3W/T4W
4	UMCT2TH	TORCH HEAD SUIT T2
5	UMCT2LBC	LONG BACK CAP SUIT T2/T3W/T4W QTY 1
6	UMCT2SBC	SHORT BACK CAP SUIT T2/T3W/T4W QTY 1
7	UMCTMS	TIG TORCH SWITCH SINGLE BUTTON SUIT T2/T3/T3W/T4W
7	UMCTMK10KP	TIG TORCH SWITCH HORIZONTAL ADJUSTMENT 10K POT SUIT T2/T3/T3W/T4W
7	U11539	TIG TORCH MODULE DIGITAL 4 BUTTON SUIT T2/T3/T3W/T4W
7	U11196	TIG TORCH MODULE BLANK SUIT T2/T3/T3W/T4W
8	UMCTSPAN	SPANNER SUIT T2/T3/T3W/T4W
9	See page 10-11	COLLET BODY

10	See page 10-11	GAS LENS COLLET BODY
11	See page 10-11	SUPER GAS LENS COLLET BODY
12	See page 10-11	CERAMIC CUP
13	See following page	QUARTZ CUP
14	See following page	SUPER CERAMIC CUP
15	See following page	SUPER QUARTZ CUP

COOLING METHOD	Water-Cooled
DUTY CYCLE - DC	100% @ 400A
DUTY CYCLE - AC	100% @ 280A
DINSE SIZE	35/50
ELECTRODE SIZE	1.0-4.0mm
STANDARD	EN60974-7
MINIMUM WATER FLOW	1.5L/min
MINIMUM WATER INLET PRESSURE	3.0 Bar
MAXIMUM WATER INLET PRESSURE	5.0 Bar
MAXIMUM WATER INLET TEMPERATURE	50°C
MINIMUM COOLING POWER	900W

### 2.4 T4W TIG Torch

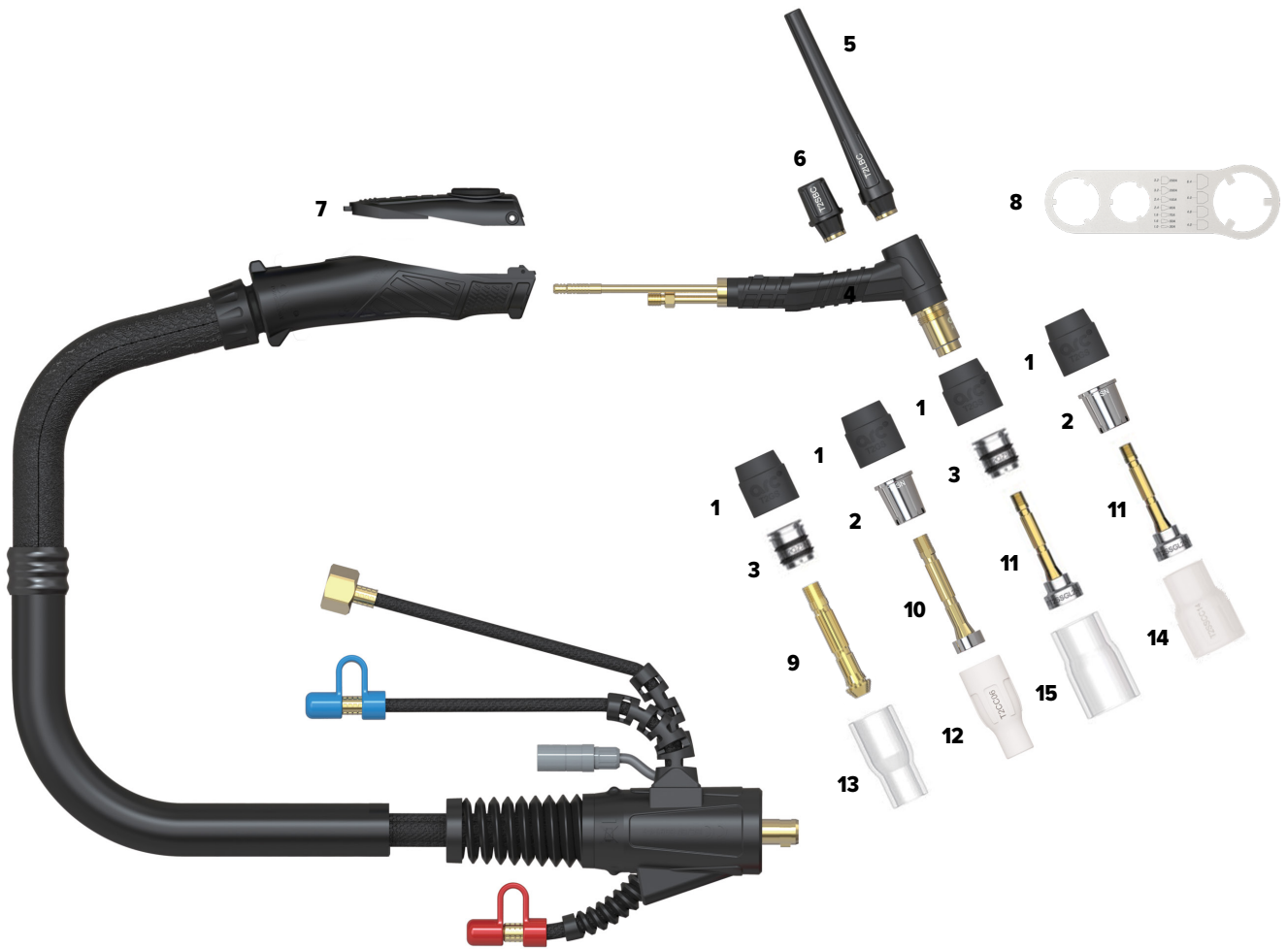

Length	4m	8m
SKU	U11209	U11210

1	UMCT2HG	HEAD GASKET SUIT T2/T3W/T4W QTY 1
2	UMCT2SN	HEAT ZONE ISOLATOR SUIT T2/T3W/T4W QTY 1
3	UMCT2QZSN	QUARTZ ZONE ISOLATOR SUIT T2/T3W/T4W QTY 1
4	UMCT3WTHF	TORCH HEAD FLEXIBLE SUIT T3W/T4W
4	UMCT2TH	TORCH HEAD SUIT T2
5	UMCT2LBC	LONG BACK CAP SUIT T2/T3W/T4W QTY 1
6	UMCT2SBC	SHORT BACK CAP SUIT T2/T3W/T4W QTY 1
7	UMCTMS	TIG TORCH SWITCH SINGLE BUTTON SUIT T2/T3/T3W/T4W
7	UMCTMK10KP	TIG TORCH SWITCH HORIZONTAL ADJUSTMENT 10K POT SUIT T2/T3/T3W/T4W
7	U11539	TIG TORCH MODULE DIGITAL 4 BUTTON SUIT T2/T3/T3W/T4W
7	U11196	TIG TORCH MODULE BLANK SUIT T2/T3/T3W/T4W
8	UMCTSPAN	SPANNER SUIT T2/T3/T3W/T4W
9	See page 10-11	COLLET BODY

10	See page 10-11	GAS LENS COLLET BODY
11	See page 10-11	SUPER GAS LENS COLLET BODY
12	See page 10-11	CERAMIC CUP
13	See following page	QUARTZ CUP
14	See following page	SUPER CERAMIC CUP
15	See following page	SUPER QUARTZ CUP

COOLING METHOD	Water-Cooled
DUTY CYCLE - DC	100% @ 450A
DUTY CYCLE - AC	100% @ 315A
DINSE SIZE	35/50
ELECTRODE SIZE	1.0-4.0mm
STANDARD	EN60974-7
MINIMUM WATER FLOW	1.5L/min
MINIMUM WATER INLET PRESSURE	3.0 Bar
MAXIMUM WATER INLET PRESSURE	5.0 Bar
MAXIMUM WATER INLET TEMPERATURE	50°C
MINIMUM COOLING POWER	1600W

## T2/T3W/T4W TIG Torch Consumables

### Standard

### Quartz

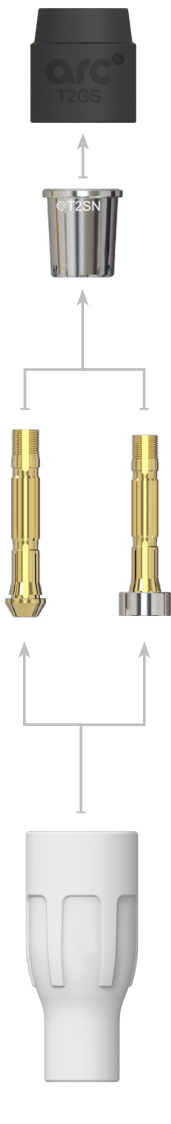

**Head Gasket**

<b>UMCT2HG</b>	HEAD GASKET SUIT T2/T3W/T4W QTY 1
----------------	-----------------------------------

**Heat Zone Isolator**

<b>UMCT2SN</b>	HEAT ZONE ISOLATOR SUIT T2/T3W/T4W QTY 1
----------------	--

**Collet Body**

<b>UMCT2CB10</b>	COLLET BODY SUIT T2/T3W/T4W 1.0MM QTY 1
<b>UMCT2CB16</b>	COLLET BODY SUIT T2/T3W/T4W 1.6MM QTY 1
<b>UMCT2CB24</b>	COLLET BODY SUIT T2/T3W/T4W 2.4MM QTY 1
<b>UMCT2CB32</b>	COLLET BODY SUIT T2/T3W/T4W 3.2MM QTY 1
<b>UMCT2GL10</b>	GAS LENS COLLET BODY SUIT T2/T3W/T4W 1.0MM QTY 1
<b>UMCT2GL16</b>	GAS LENS COLLET BODY SUIT T2/T3W/T4W 1.6MM QTY 1
<b>UMCT2GL24</b>	GAS LENS COLLET BODY SUIT T2/T3W/T4W 2.4MM QTY 1
<b>UMCT2GL32</b>	GAS LENS COLLET BODY SUIT T2/T3W/T4W 3.2MM QTY 1

**Ceramic Cup**

<b>UMCT2C04</b>	CERAMIC CUP SUIT T2/T3W/T4W SIZE 4 6MM QTY 1
<b>UMCT2C05</b>	CERAMIC CUP SUIT T2/T3W/T4W SIZE 5 8MM QTY 1
<b>UMCT2C06</b>	CERAMIC CUP SUIT T2/T3W/T4W SIZE 6 10MM QTY 1
<b>UMCT2C07</b>	CERAMIC CUP SUIT T2/T3W/T4W SIZE 7 11MM QTY 1
<b>UMCT2C08</b>	CERAMIC CUP SUIT T2/T3W/T4W SIZE 8 12.5MM QTY 1
<b>UMCT2C10</b>	CERAMIC CUP SUIT T2/T3W/T4W SIZE 10 16MM QTY 1

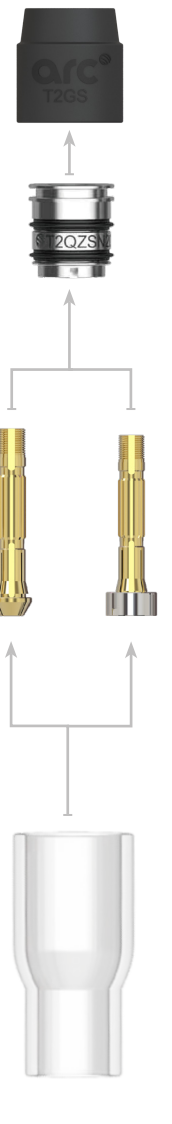

**Head Gasket**

<b>UMCT2HG</b>	HEAD GASKET SUIT T2/T3W/T4W QTY 1
----------------	-----------------------------------

**Heat Zone Isolator**

<b>UMCT2QZSN</b>	QUARTZ ZONE ISOLATOR SUIT T2/T3W/T4W QTY 1
------------------	--

**Collet Body**

<b>UMCT2CB10</b>	COLLET BODY SUIT T2/T3W/T4W 1.0MM QTY 1
<b>UMCT2CB16</b>	COLLET BODY SUIT T2/T3W/T4W 1.6MM QTY 1
<b>UMCT2CB24</b>	COLLET BODY SUIT T2/T3W/T4W 2.4MM QTY 1
<b>UMCT2CB32</b>	COLLET BODY SUIT T2/T3W/T4W 3.2MM QTY 1
<b>UMCT2GL10</b>	GAS LENS COLLET BODY SUIT T2/T3W/T4W 1.0MM QTY 1
<b>UMCT2GL16</b>	GAS LENS COLLET BODY SUIT T2/T3W/T4W 1.6MM QTY 1
<b>UMCT2GL24</b>	GAS LENS COLLET BODY SUIT T2/T3W/T4W 2.4MM QTY 1
<b>UMCT2GL32</b>	GAS LENS COLLET BODY SUIT T2/T3W/T4W 3.2MM QTY 1

**Quartz Cup**

<b>UMCT2QZ06</b>	QUARTZ CUP SUIT T2/T3W/T4W SIZE 6 QTY 1
<b>UMCT2QZ08</b>	QUARTZ CUP SUIT T2/T3W/T4W SIZE 8 QTY 1
<b>UMCT2QZ10</b>	QUARTZ CUP SUIT T2/T3W/T4W SIZE 9 QTY 1

## T3 TIG Torch Consumables

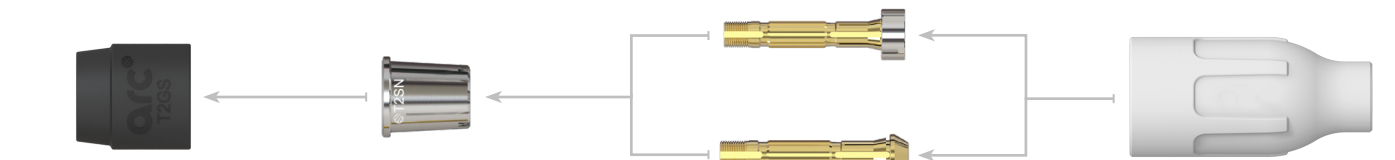

**Head Gasket**

<b>UMCT3HG</b>	HEAD GASKET SUIT T3 QTY 1
----------------	---------------------------

**Heat Zone Isolator**

<b>UMCT3SN</b>	HEAT ZONE ISOLATOR SUIT T3 QTY 1
----------------	----------------------------------

**Collet Body**

<b>UMCT3CB16</b>	COLLET BODY SUIT T3 1.6MM QTY 1
<b>UMCT3CB24</b>	COLLET BODY SUIT T3 2.4MM QTY 1
<b>UMCT3CB32</b>	COLLET BODY SUIT T3 3.2MM QTY 1
<b>UMCT3GL16</b>	GAS LENS COLLET BODY SUIT T3 1.6MM QTY 1
<b>UMCT3GL24</b>	GAS LENS COLLET BODY SUIT T3 2.4MM QTY 1
<b>UMCT3GL32</b>	GAS LENS COLLET BODY SUIT T3 3.2MM QTY 1

**Ceramic Cup**

<b>UMCT3C04</b>	CERAMIC CUP SUIT T3 SIZE 4 6MM QTY 1
<b>UMCT3C05</b>	CERAMIC CUP SUIT T3 SIZE 5 8MM QTY 1
<b>UMCT3C06</b>	CERAMIC CUP SUIT T3 SIZE 6 10MM QTY 1
<b>UMCT3C07</b>	CERAMIC CUP SUIT T3 SIZE 7 11MM QTY 1
<b>UMCT3C08</b>	CERAMIC CUP SUIT T3 SIZE 8 12.5MM QTY 1
<b>UMCT3C10</b>	CERAMIC CUP SUIT T3 SIZE 10 16MM QTY 1

## T2/T3W/T4W TIG Torch Consumables

### SUPER Series



#### Head Gasket

<b>UMCT2HG</b>	HEAD GASKET SUIT T2/T3W/T4W QTY 1
----------------	-----------------------------------



#### Heat Zone Isolator

<b>UMCT2SN</b>	HEAT ZONE ISOLATOR SUIT T2/T3W/T4W QTY 1
----------------	--

#### Collet Body

<b>UMCT2SSGL2016</b>	GAS LENS COLLET BODY SUPER12 SUIT T2/T3W/T4W 1.6MM QTY 1
<b>UMCT2SSGL2024</b>	GAS LENS COLLET BODY SUPER12 SUIT T2/T3W/T4W 2.4MM QTY 1
<b>UMCT2SSGL2032</b>	GAS LENS COLLET BODY SUPER12 SUIT T2/T3W/T4W 3.2MM QTY 1
<b>UMCT2SSGL2316</b>	GAS LENS COLLET BODY SUPER14 SUIT T2/T3W/T4W 1.6MM QTY 1
<b>UMCT2SSGL2324</b>	GAS LENS COLLET BODY SUPER14 SUIT T2/T3W/T4W 2.4MM QTY 1
<b>UMCT2SSGL2332</b>	GAS LENS COLLET BODY SUPER14 SUIT T2/T3W/T4W 3.2MM QTY 1
<b>UMCT2SSGL2816</b>	GAS LENS COLLET BODY SUPER18 SUIT T2/T3W/T4W 1.6MM QTY 1
<b>UMCT2SSGL2824</b>	GAS LENS COLLET BODY SUPER18 SUIT T2/T3W/T4W 2.4MM QTY 1
<b>UMCT2SSGL2832</b>	GAS LENS COLLET BODY SUPER18 SUIT T2/T3W/T4W 3.2MM QTY 1



#### Ceramic Cup

<b>UMCT2SSCC12</b>	CERAMIC CUP SUPER12 SUIT T2/T3W/T4W SIZE 12 QTY 1
<b>UMCT2SSCC14</b>	CERAMIC CUP SUPER14 SUIT T2/T3W/T4W SIZE 14 QTY 1
<b>UMCT2SSCC18</b>	CERAMIC CUP SUPER18 SUIT T2/T3W/T4W SIZE 18 QTY 1

### SUPER Series Quartz



#### Head Gasket

<b>UMCT2HG</b>	HEAD GASKET SUIT T2/T3W/T4W QTY 1
----------------	-----------------------------------



#### Heat Zone Isolator

<b>UMCT2QZSN</b>	QUARTZ ZONE ISOLATOR SUIT T2/T3W/T4W QTY 1
------------------	--

#### Collet Body

<b>UMCT2SSGL2016</b>	GAS LENS COLLET BODY SUPER12 SUIT T2/T3W/T4W 1.6MM QTY 1
<b>UMCT2SSGL2024</b>	GAS LENS COLLET BODY SUPER12 SUIT T2/T3W/T4W 2.4MM QTY 1
<b>UMCT2SSGL2032</b>	GAS LENS COLLET BODY SUPER12 SUIT T2/T3W/T4W 3.2MM QTY 1
<b>UMCT2SSGL2316</b>	GAS LENS COLLET BODY SUPER14 SUIT T2/T3W/T4W 1.6MM QTY 1
<b>UMCT2SSGL2324</b>	GAS LENS COLLET BODY SUPER14 SUIT T2/T3W/T4W 2.4MM QTY 1
<b>UMCT2SSGL2332</b>	GAS LENS COLLET BODY SUPER14 SUIT T2/T3W/T4W 3.2MM QTY 1
<b>UMCT2SSGL2816</b>	GAS LENS COLLET BODY SUPER18 SUIT T2/T3W/T4W 1.6MM QTY 1
<b>UMCT2SSGL2824</b>	GAS LENS COLLET BODY SUPER18 SUIT T2/T3W/T4W 2.4MM QTY 1
<b>UMCT2SSGL2832</b>	GAS LENS COLLET BODY SUPER18 SUIT T2/T3W/T4W 3.2MM QTY 1



#### Quartz Cup

<b>UMCT2SSQZ12</b>	QUARTZ CUP SUPER12 SUIT T2/T3W/T4W SIZE 12 QTY 1
<b>UMCT2SSQZ14</b>	QUARTZ CUP SUPER14 SUIT T2/T3W/T4W SIZE 14 QTY 1
<b>UMCT2SSQZ18</b>	QUARTZ CUP SUPER18 SUIT T2/T3W/T4W SIZE 18 QTY 1

# **UNIMIG**



**100%**  
**AUSTRALIAN**  
**OWNED**

**unimig.com.au**

**f @ UNIMIG**