

# SC120 Plasma Torch

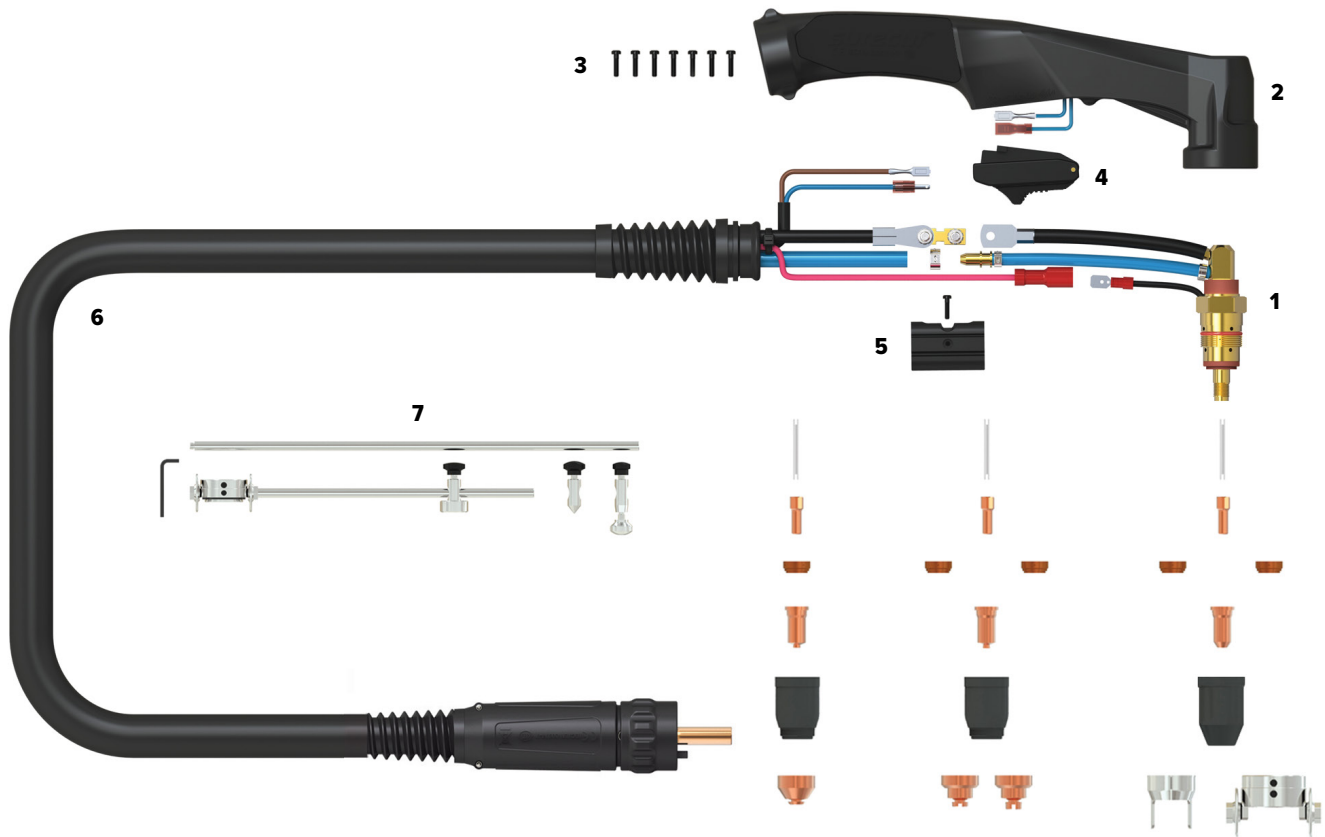

<b>Length</b>	<b>6m</b>
<b>SKU</b>	WGSC1206M

<b>1</b>	SC1201	PLASMA TORCH HEAD SUIT SC120
<b>2</b>	SC8014	PLASMA HANDLE
<b>3</b>	SCSP1	SCREW PACK
<b>4</b>	SC2516	PLASMA TRIGGER
<b>5</b>	SC8015	LOCATION BLOCK
<b>6</b>	SC8019-60-CF4	CABLE ASSEMBLY
<b>7</b>	U43004	CIRCLE CUTTING KIT SUIT SC120 QTY 1

COOLING METHOD	Air-Cooled
DUTY CYCLE	60% @ 120A
CUTTING THICKNESS	30-35mm
GAS	Air/N2
GAS PRESSURE	4.5-5.0 Bar / 65-75 psi
GAS FLOW	200L/min
IGNITION	Pilot Arc
POST FLOW	90s
STANDARD	EN60974-7

# SC120 Plasma Torch Consumables

## Gouging

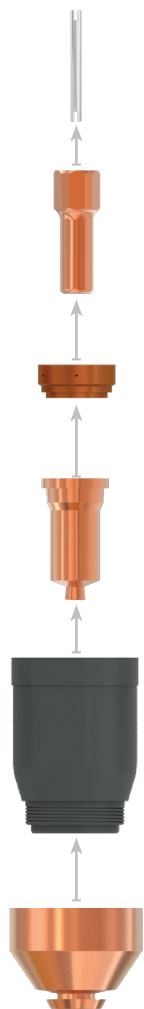

### Cooling Tube

<b>SC1202</b>	COOLING TUBE SUIT SC120 QTY 1
---------------	-------------------------------

### Electrode

<b>PSC1204</b>	ELECTRODES SUIT SC120 QTY 5
----------------	-----------------------------

### Swirl Ring

<b>SC1206</b>	SWIRL RING HEAVY DUTY SUIT SC120 QTY 1
<b>SC1207</b>	SWIRL RING SUIT SC120 QTY 1

### Gouging Tips

<b>PSC1228-22</b>	GOUGING TIPS SUIT SC120 2.2MM QTY 5
-------------------	-------------------------------------

### Shield Cap Body

<b>SC1232</b>	SHIELD CAP BODY SUIT SC120 QTY 1
---------------	----------------------------------

### Shield Cap Gouging

<b>SC8043</b>	SHIELD CAP GOUGING SUIT SC80/SC120 QTY 1
---------------	--

## Contact Cutting



### Cooling Tube

<b>SC1202</b>	COOLING TUBE SUIT SC120 QTY 1
---------------	-------------------------------

### Electrode

<b>PSC1204</b>	ELECTRODES SUIT SC120 QTY 5
----------------	-----------------------------

### Swirl Ring

<b>SC1206</b>	SWIRL RING HEAVY DUTY SUIT SC120 QTY 1
<b>SC1207</b>	SWIRL RING SUIT SC120 QTY 1

### Contact Cutting Tips

<b>PSC1222-09</b>	CONTACT CUTTING TIPS SUIT SC120 0.9MM 30-40A QTY 5
<b>PSC1226-10</b>	CONTACT CUTTING TIPS SUIT SC120 1.0MM 40-50A QTY 5
<b>PSC1226-11</b>	CONTACT CUTTING TIPS SUIT SC120 1.1MM 50-60A QTY 5
<b>PSC1226-12</b>	CONTACT CUTTING TIPS SUIT SC120 1.2MM 60-70A QTY 5
<b>PSC1227-14</b>	CONTACT CUTTING TIPS SUIT SC120 1.4MM 80-90A QTY 5
<b>PSC1227-15</b>	CONTACT CUTTING TIPS SUIT SC120 1.5MM 100-110A QTY 5
<b>PSC1227-16</b>	CONTACT CUTTING TIPS SUIT SC120 1.6MM 110-120A QTY 5

### Shield Cap Body

<b>SC1232</b>	SHIELD CAP BODY SUIT SC120 QTY 1
---------------	----------------------------------

### Shield Cap Contact Cutting

<b>SC1241</b>	SHEILD CAP CONTACT CUTTING SUIT SC120 QTY 1
---------------	---

## Standoff Cutting

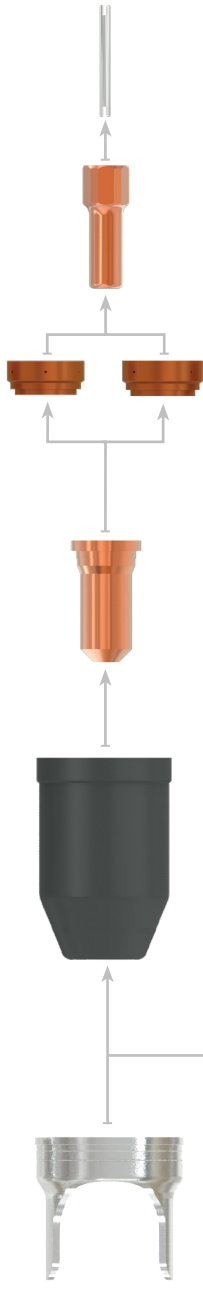

### Cooling Tube

<b>SC1202</b>	COOLING TUBE SUIT SC120 QTY 1
---------------	-------------------------------

### Electrode

<b>PSC1204</b>	ELECTRODES SUIT SC120 QTY 5
----------------	-----------------------------

### Swirl Ring

<b>SC1206</b>	SWIRL RING HEAVY DUTY SUIT SC120 QTY 1
<b>SC1207</b>	SWIRL RING SUIT SC120 QTY 1

### Cutting Tips

<b>PSC1220-10</b>	CUTTING TIPS SUIT SC120 1.0MM 40-50A QTY 5
<b>PSC1220-11</b>	CUTTING TIPS SUIT SC120 1.1MM 50-60A QTY 5
<b>PSC1220-12</b>	CUTTING TIPS SUIT SC120 1.2MM 60-70A QTY 5
<b>PSC1221-14</b>	CUTTING TIPS SUIT SC120 1.4MM 80-90A QTY 5
<b>PSC1221-15</b>	CUTTING TIPS SUIT SC120 1.5MM 100-110A QTY 5
<b>PSC1221-16</b>	CUTTING TIPS SUIT SC120 1.6MM 110-120A QTY 5

### Retaining Cap Body

<b>SC1230</b>	RETAINING CAP SUIT SC120 30-70A QTY 1
<b>SC1231</b>	RETAINING CAP HEAVY DUTY SUIT SC120 80-120A QTY 1

### Standoff Guide

<b>SC1240</b>	STANDOFF GUIDE SUIT SC120 QTY 1
---------------	---------------------------------

### Cutting Guide

<b>SC1251</b>	CUTTING GUIDE SUIT SC120 QTY 1
---------------	--------------------------------