

UNIMIG



STANDARD TIG TORCHES

Contents

1. Installation	4
1.1 Standard Consumables.....	4
1.2 APEX & Gas Lens Consumables.....	6
2. TIG Torch & Consumables	8
2.1 9V TIG Torch.....	8
2.2 9V TIG Torch Consumables.....	9
2.2.1 Standard.....	9
2.2.2 Gas Lens.....	10
2.2.3 APEX.....	11
2.3 17V TIG Torch.....	12
2.4 17V TIG Torch Consumables.....	13
2.4.1 Standard.....	13
2.4.2 Gas Lens.....	14
2.4.3 APEX.....	15
2.4.4 Stubby.....	16
2.4.5 Stubby Gas Lens.....	17
2.5 26V TIG Torch.....	18
2.6 26V TIG Torch Consumables.....	19
2.6.1 Standard.....	19
2.6.2 Gas Lens.....	20
2.6.3 APEX.....	21
2.6.4 Stubby.....	22
2.6.5 Stubby Gas Lens.....	23
2.7 SR9 TIG Torch.....	24
2.8 SR9 TIG Torch Consumables.....	25
2.8.1 Standard.....	25
2.8.2 Gas Lens.....	26
2.8.3 APEX.....	27
2.9 SR17 TIG Torch.....	28
2.10 SR17 TIG Torch Consumables.....	29
2.10.1 Standard.....	29
2.10.2 Gas Lens.....	30
2.10.3 APEX.....	31
2.10.4 Stubby.....	32
2.10.5 Stubby Gas Lens.....	33
2.11 SR18 TIG Torch.....	34
2.12 SR18 TIG Torch Consumables.....	35
2.12.1 Standard.....	35
2.12.2 Gas Lens.....	36

2.12.3 APEX.....	37
2.12.4 Stubby.....	38
2.12.5 Stubby Gas Lens.....	39
2.13 SR26 TIG Torch.....	40
2.14 SR26 TIG Torch Consumables.....	41
2.14.1 Standard.....	41
2.14.2 Gas Lens.....	42
2.14.3 APEX.....	43
2.14.4 Stubby.....	44
2.14.5 Stubby Gas Lens.....	45

1. Installation

1.1 Standard Consumables

1. Insert the collet into the collet body.

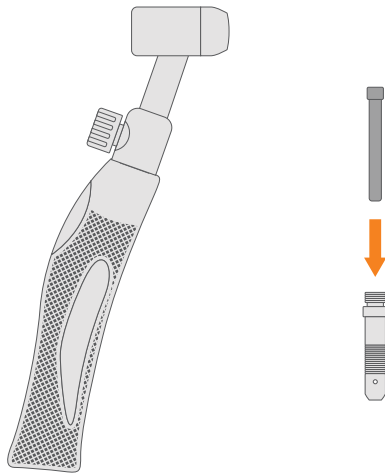

2. Insert the tungsten electrode into the collet/collet body.

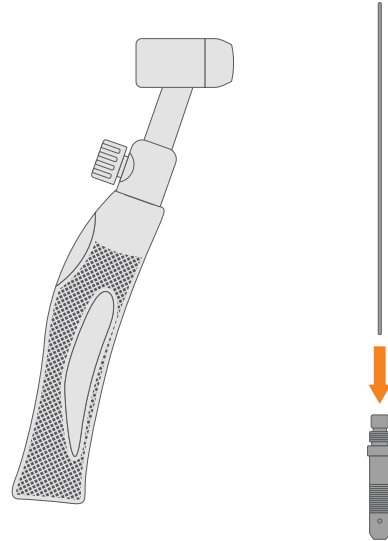

3. Screw the collet body into the torch head. Fasten securely.

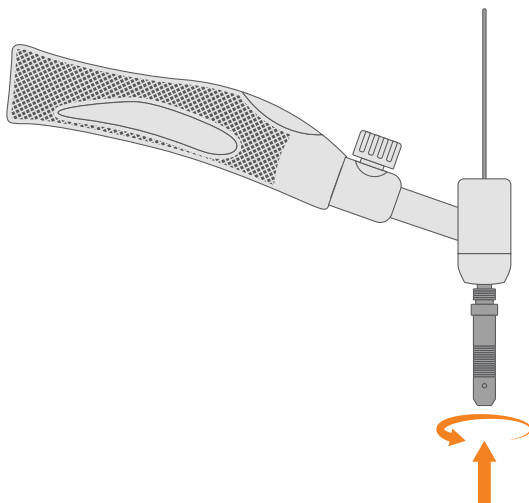

4. Screw the back cap into the torch head, don't tighten completely.

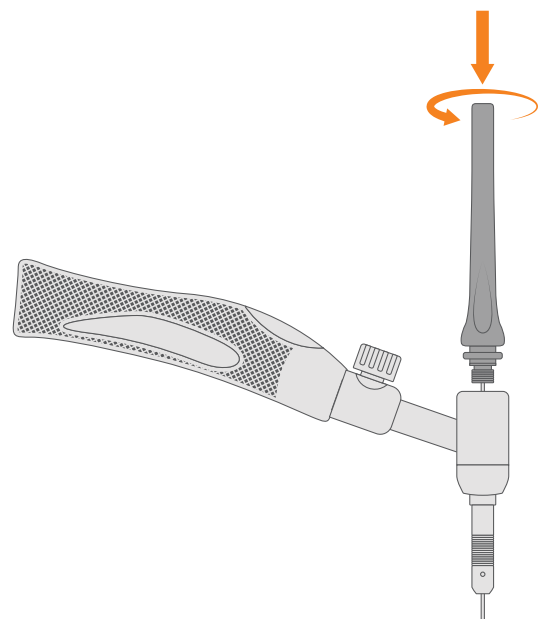

5. Screw the ceramic cup on to the collet body.

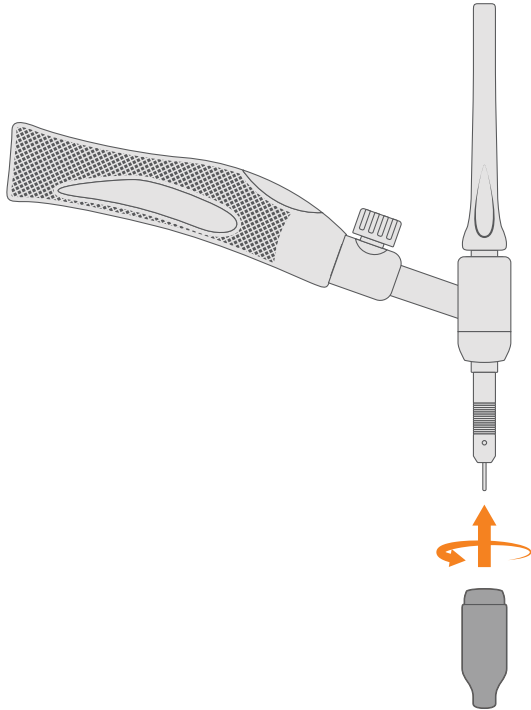

6. Adjust the tungsten to the desired length, then tighten the back cap.

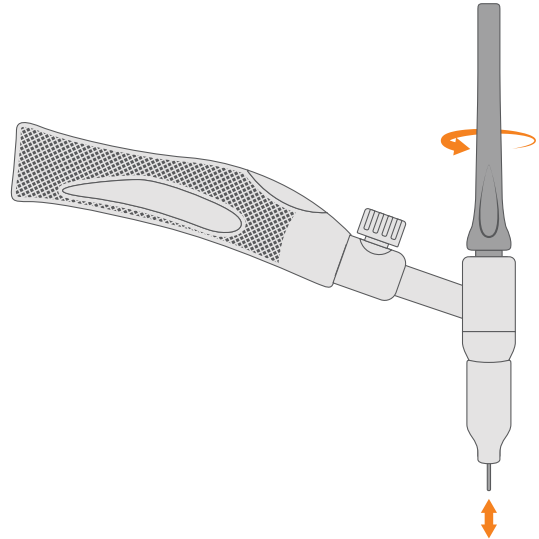

1.2 APEX & Gas Lens Consumables

1. a) If you are installing **Gas Lens** consumables, place the Standard Insulator onto the torch head.

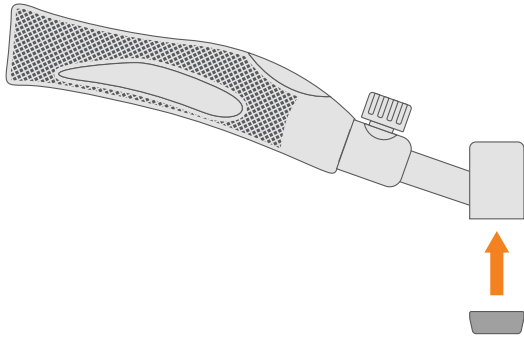

b) If you are installing **APEX** consumables, place the Stubby Insulator onto the torch head.

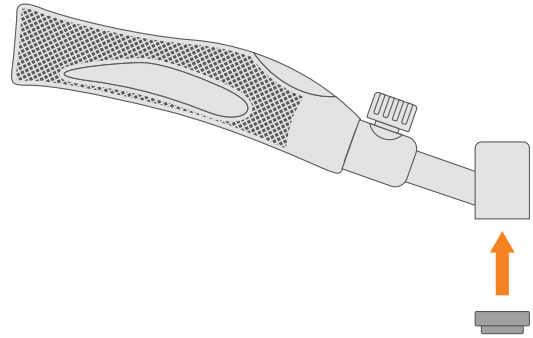

2. Insert the wedge collet into the small end of the gas lens.

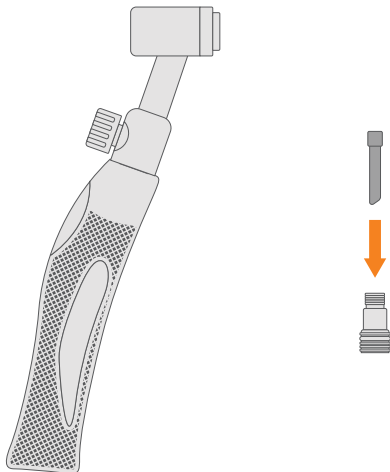

3. Insert the tungsten electrode into the collet/stubby gas lens.

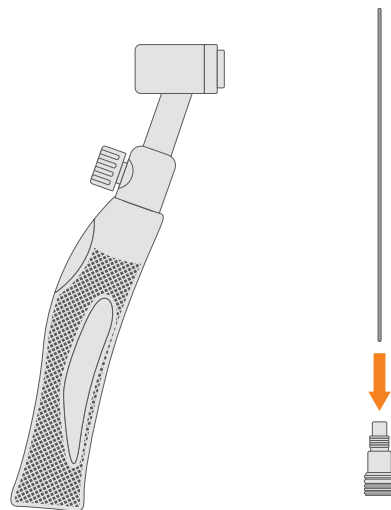

- 4.** Screw the collet body into the torch head. Fasten securely. Ensure that the o-ring is in the correct position on the collet body.

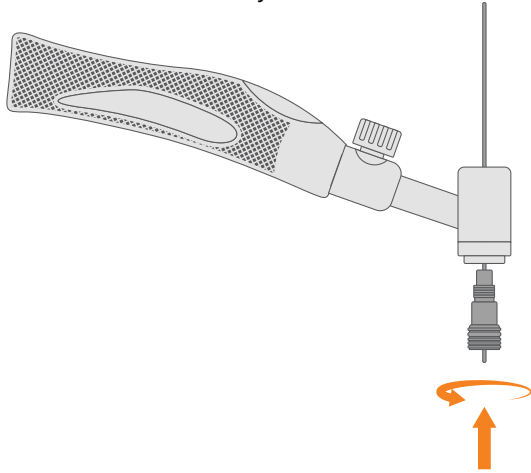

- 5.** Screw the back cap into the torch head, don't tighten all of the way.

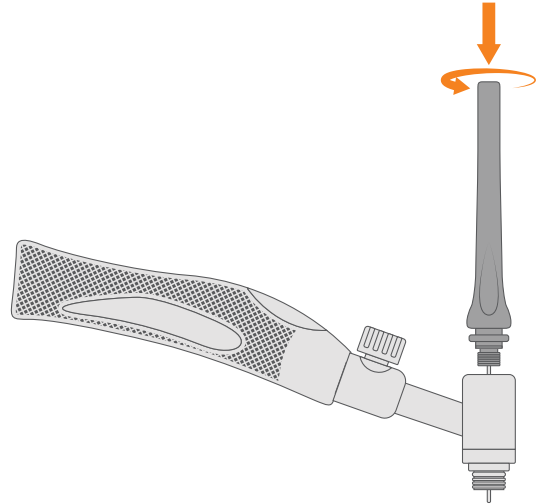

- 6. a)** Screw the ceramic cup onto the stubby gas lens. **OR b)** Slide the quartz cup onto the stubby gas lens.

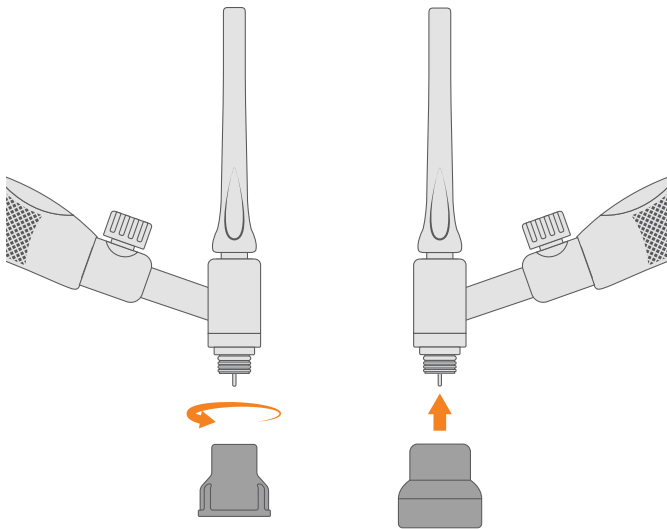

- 7.** Adjust the tungsten to the desired length, then tighten the back cap.

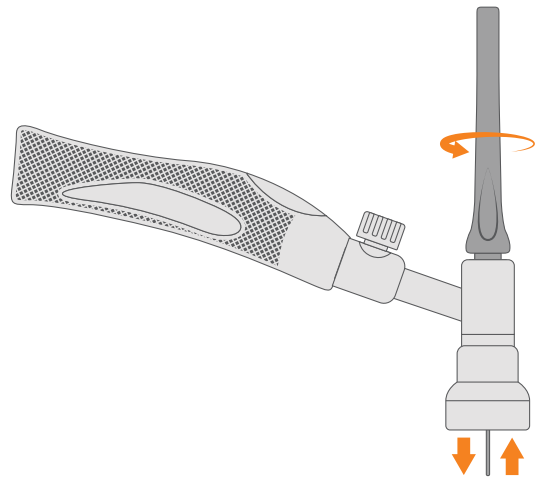

2. TIG Torch & Consumables

2.1 9V TIG Torch

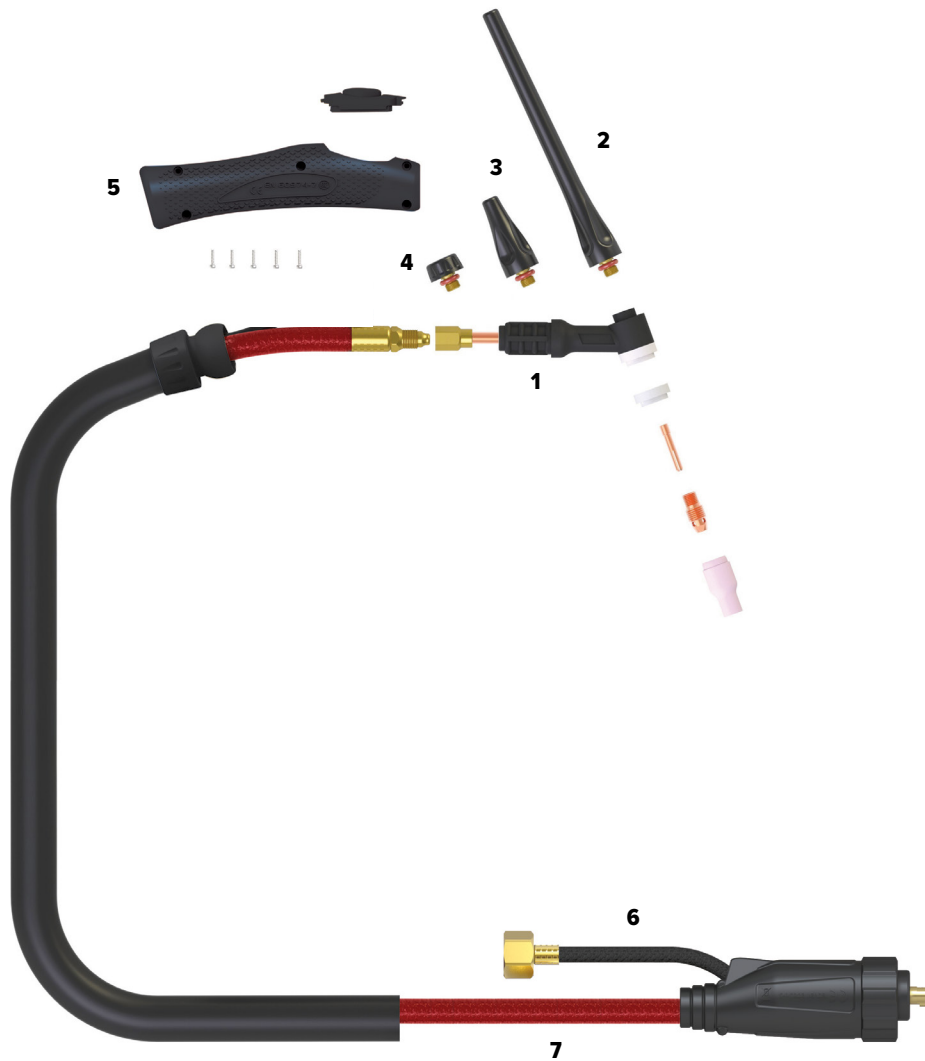

Length	10/25 Dinse 4m	10/25 Dinse 8m	35/50 Dinse 4m	35/50 Dinse 8m
SKU	9V-4MCP25	9V-8MCP25	9V-4MCP50	9V-8MCP50

1	WP9V	TORCH HEAD VALVE SUIT 9V
1	WP9VF	TORCH HEAD FLEXIBLE VALVE SUIT 9V
2	P41V24	LONG BACK CAP SUIT 9/20 QTY 2
3	P41V35	MEDIUM BACK CAP SUIT 9/20 QTY 2
4	P41V33	SHORT BACK CAP SUIT 9/20 QTY 2
5	UERH100	SMALL ERGO TIG HANDLE
6	ML3550H-M	"SURELOK" HOUSING SMALL
7	USL57Y01AR	POWER CABLE X 12.5FT SURELOK
7	USL57Y03AR	POWER CABLE X 25FT SURELOK

COOLING METHOD	Air-Cooled
DUTY CYCLE - DC	35% @ 125A
DUTY CYCLE - AC	35% @ 90A
DINSE SIZE	10/25, 35/50
ELECTRODE SIZE	1.0-2.4mm
STANDARD	EN60974-7

2.2 9V TIG Torch Consumables

2.2.1 Standard



Insulator

P598882	INSULATOR SUIT 9/20 QTY 2
----------------	---------------------------

Collet

P13N22	COLLET SUIT 9/20 1.6MM QTY 2
P13N23	COLLET SUIT 9/20 2.4MM QTY 2
P13N24	COLLET SUIT 9/20 3.2MM QTY 2

Collet Body

P13N27	COLLET BODY SUIT 9/20 1.6MM QTY 2
P13N28	COLLET BODY SUIT 9/20 2.4MM QTY 2
P13N29	COLLET BODY SUIT 9/20 3.2MM QTY 2

Ceramic Cup

P13N08	CERAMIC CUP SUIT 9/20 SIZE 4 QTY 2
P13N09	CERAMIC CUP SUIT 9/20 SIZE 5 QTY 2
P13N10	CERAMIC CUP SUIT 9/20 SIZE 6 QTY 2
P13N11	CERAMIC CUP SUIT 9/20 SIZE 7 QTY 2
P13N12	CERAMIC CUP SUIT 9/20 SIZE 8 QTY 2
P13N13	CERAMIC CUP SUIT 9/20 SIZE 10 QTY 2

2.2.2 Gas Lens



Insulator

P598882	INSULATOR SUIT 9/20 QTY 2
----------------	---------------------------

Collet

P13N22	COLLET SUIT 9/20 1.6MM QTY 2
P13N23	COLLET SUIT 9/20 2.4MM QTY 2
P13N24	COLLET SUIT 9/20 3.2MM QTY 2

Gas Lens

P45V43	GAS LENS SUIT 9/20 1.6MM QTY 2
P45V44	GAS LENS SUIT 9/20 2.4MM QTY 2
P45V45	GAS LENS SUIT 9/20 3.2MM QTY 2

Ceramic Cup

P53N58	GAS LENS CERAMIC CUP SUIT 9/17/18/20/26 SIZE 4 QTY 2
P53N59	GAS LENS CERAMIC CUP SUIT 9/17/18/20/26 SIZE 5 QTY 2
P53N60	GAS LENS CERAMIC CUP SUIT 9/17/18/20/26 SIZE 6 QTY 2
P53N61	GAS LENS CERAMIC CUP SUIT 9/17/18/20/26 SIZE 7 QTY 2
P53N61S	GAS LENS CERAMIC CUP SUIT 9/17/18/20/26 SIZE 8 QTY 2

2.2.3 APEX

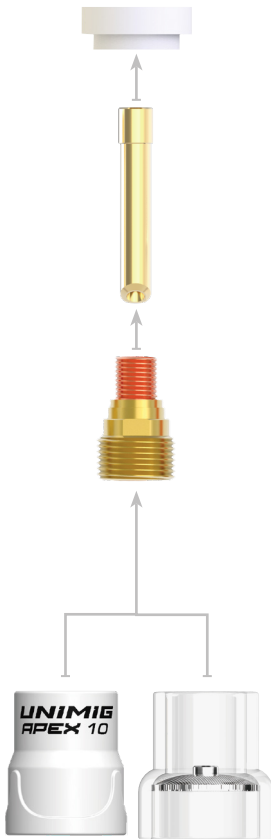

Insulator

P598882	INSULATOR SUIT 9/20 QTY 2
----------------	---------------------------

Wedge Collet

U11169	WEDGE COLLET SUIT 9/20 1.6MM QTY 2
U11170	WEDGE COLLET SUIT 9/20 2.4MM QTY 2

Gas Lens

U11190	GAS LENS BODY WITH O RING SUIT 9/20 1.6MM QTY 2
U11191	GAS LENS BODY WITH O RING SUIT 9/20 2.4MM QTY 2
U42029	APEX SILICONE RUBBER 'O'-RING QTY 5

Ceramic Cup

U42020	CERAMIC CUP APEX10 SUIT 9/17/18/20/26 SIZE 10 QTY 1
U42021	CERAMIC CUP APEX12 SUIT 9/17/18/20/26 SIZE 12 QTY 1
U42022	CERAMIC CUP APEX14 SUIT 9/17/18/20/26 SIZE 14 QTY 1
U42023	CERAMIC CUP APEX19 SUIT 9/17/18/20/26 SIZE 19 QTY 1
U11017	FILTER SCREEN KIT APEX10 1.6MM, 2.4MM, 3.2MM QTY 1
U11018	FILTER SCREEN KIT APEX12 1.6MM, 2.4MM, 3.2MM QTY 1
U11019	FILTER SCREEN KIT APEX14 1.6MM, 2.4MM, 3.2MM QTY 1
U11020	FILTER SCREEN KIT APEX19 1.6MM, 2.4MM, 3.2MM QTY 1

Quartz Cup

U42024	QUARTZ CUP APEX12 SUIT 9/17/18/20/26 SIZE 12 QTY 1
U42025	QUARTZ CUP APEX19 SUIT 9/17/18/20/26 SIZE 19 QTY 1

2.3 17V TIG Torch

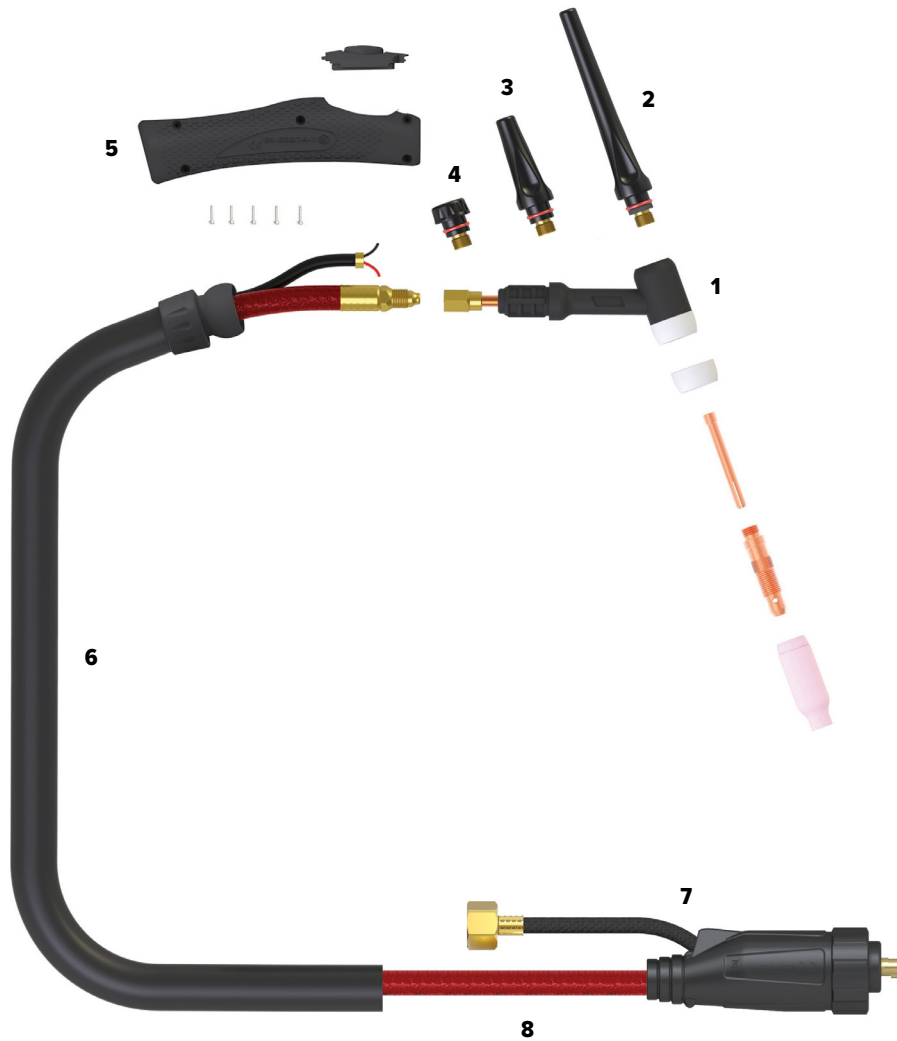

Length	10/25 Dinse 4m	10/25 Dinse 8m	35/50 Dinse 4m	35/50 Dinse 8m
SKU	17V-4MCP25	17V-8MCP25	17V-4MCP50	17V-8MCP50

1	WP17V	TORCH HEAD VALVE SUIT 17V
1	WP17VF	TORCH HEAD FLEXIBLE VALVE SUIT 17V
2	P57Y02	LONG BACK CAP SUIT 17/18/26 QTY 2
3	P57Y03	MEDIUM BACK CAP SUIT 17/18/26 QTY 2
4	P57Y04	SHORT BACK CAP SUIT 17/18/26 QTY 2
5	UERH100	SMALL ERGO TIG HANDLE
6	UERO100-40	SHEATH X 12.5FT INC LEATHER COVER
7	ML3550H-M	"SURELOK" HOUSING SMALL
8	USL57Y01AR	POWER CABLE X 12.5FT SURELOK
8	USL57Y03AR	POWER CABLE X 25FT SURELOK

COOLING METHOD	Air-Cooled
DUTY CYCLE - DC	35% @ 150A
DUTY CYCLE - AC	35% @ 105A
DINSE SIZE	35/50
ELECTRODE SIZE	1.0-3.2mm
STANDARD	EN60974-7

2.4 17V TIG Torch Consumables

2.4.1 Standard



Insulator

P18CG	INSULATOR SUIT 17/18/26 QTY 2
--------------	-------------------------------

Collet

P10N22	COLLET SUIT 17/18/26 1.0MM QTY 2
P10N23	COLLET SUIT 17/18/26 1.6MM QTY 2
P10N24	COLLET SUIT 17/18/26 2.4MM QTY 2
P10N25	COLLET SUIT 17/18/26 3.2MM QTY 2

Collet Body

P10N30	COLLET BODY SUIT 17/18/26 1.0MM QTY 2
P10N31	COLLET BODY SUIT 17/18/26 1.6MM QTY 2
P10N32	COLLET BODY SUIT 17/18/26 2.4MM QTY 2
P10N28	COLLET BODY SUIT 17/18/26 3.2MM QTY 2

Ceramic Cup

P10N50	CERAMIC CUP SUIT 17/18/26 SIZE 4 QTY 2
P10N49	CERAMIC CUP SUIT 17/18/26 SIZE 5 QTY 2
P10N48	CERAMIC CUP SUIT 17/18/26 SIZE 6 QTY 2
P10N47	CERAMIC CUP SUIT 17/18/26 SIZE 7 QTY 2
P10N46	CERAMIC CUP SUIT 17/18/26 SIZE 8 QTY 2
P10N45	CERAMIC CUP SUIT 17/18/26 SIZE 10 QTY 2
P10N44	CERAMIC CUP SUIT 17/18/26 SIZE 12 QTY 2

2.4.2 Gas Lens

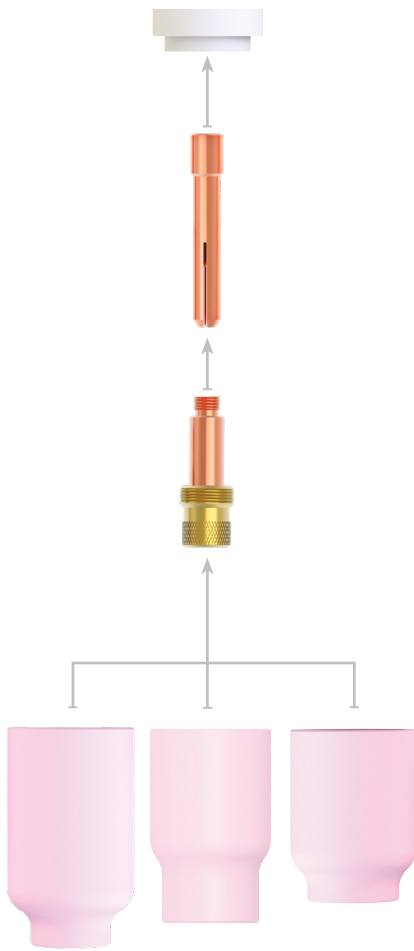

Insulator

P54N01	GAS LENS INSULATOR SUIT 17/18/26 QTY 2
---------------	--

Collet

P10N22	COLLET SUIT 17/18/26 1.0MM QTY 2
P10N23	COLLET SUIT 17/18/26 1.6MM QTY 2
P10N24	COLLET SUIT 17/18/26 2.4MM QTY 2
P10N25	COLLET SUIT 17/18/26 3.2MM QTY 2

Gas Lens

P45V25	GAS LENS SUIT 17/18/26 1.6MM QTY2
P45V26	GAS LENS SUIT 17/18/26 2.4MM QTY2
P45V27	GAS LENS SUIT 17/18/26 3.2MM QTY2

Ceramic Cup

P54N17	GAS LENS CERAMIC CUP SUIT 17/18/26 SIZE 5 QTY 2
P54N15	GAS LENS CERAMIC CUP SUIT 17/18/26 SIZE 7 QTY 2
P54N14	GAS LENS CERAMIC CUP SUIT 17/18/26 SIZE 8 QTY 2

Short Ceramic Cup

P54N15SW	GAS LENS CERAMIC CUP SHORT SUIT 17/18/26 SIZE 7 QTY 2
P54N14SW	GAS LENS CERAMIC CUP SHORT SUIT 17/18/26 SIZE 8 QTY 2
P54N12SW	GAS LENS CERAMIC CUP SHORT SUIT 17/18/26 SIZE 10 QTY 2

Stubby Ceramic Cup

P53N58	GAS LENS CERAMIC CUP SUIT 9/17/18/20/26 SIZE 4 QTY 2
P53N59	GAS LENS CERAMIC CUP SUIT 9/17/18/20/26 SIZE 5 QTY 2
P53N60	GAS LENS CERAMIC CUP SUIT 9/17/18/20/26 SIZE 6 QTY 2
P53N61	GAS LENS CERAMIC CUP SUIT 9/17/18/20/26 SIZE 7 QTY 2
P53N61S	GAS LENS CERAMIC CUP SUIT 9/17/18/20/26 SIZE 8 QTY 2

2.4.3 APEX

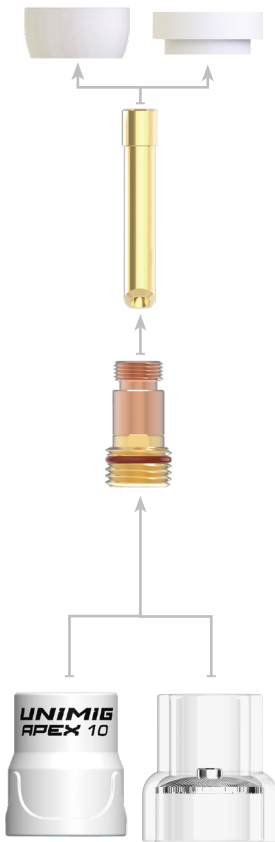

Insulator

USTB80300236	INSULATOR QUARTZ SUIT 17/18/26 QTY 2
P18CG	INSULATOR CERAMIC SUIT 17/18/26 QTY 2

Wedge Collet

U11166	WEDGE COLLET SUIT 17/18/26 1.6MM QTY 2
U11167	WEDGE COLLET SUIT 17/18/26 2.4MM QTY 2
U11168	WEDGE COLLET SUIT 17/18/26 3.2MM QTY 2

Stubby Gas Lens

U11187	GAS LENS BODY STUBBY WITH O RING SUIT 17/18/26 1.6MM QTY 2
U11188	GAS LENS BODY STUBBY WITH O RING SUIT 17/18/26 2.4MM QTY 2
U11189	GAS LENS BODY STUBBY WITH O RING SUIT 17/18/26 3.2MM QTY 2
U42029	SILICONE RUBBER O-RING SUIT APEX QTY 5

Ceramic Cup

U42020	CERAMIC CUP APEX10 SUIT 9/17/18/20/26 SIZE 10 QTY 1
U42021	CERAMIC CUP APEX12 SUIT 9/17/18/20/26 SIZE 12 QTY 1
U42022	CERAMIC CUP APEX14 SUIT 9/17/18/20/26 SIZE 14 QTY 1
U42023	CERAMIC CUP APEX19 SUIT 9/17/18/20/26 SIZE 19 QTY 1
U11017	FILTER SCREEN KIT APEX10 1.6MM, 2.4MM, 3.2MM QTY 1
U11018	FILTER SCREEN KIT APEX12 1.6MM, 2.4MM, 3.2MM QTY 1
U11019	FILTER SCREEN KIT APEX14 1.6MM, 2.4MM, 3.2MM QTY 1
U11020	FILTER SCREEN KIT APEX19 1.6MM, 2.4MM, 3.2MM QTY 1

Quartz Cup

U42024	QUARTZ CUP APEX12 SUIT 9/17/18/20/26 SIZE 12 QTY 1
U42025	QUARTZ CUP APEX19 SUIT 9/17/18/20/26 SIZE 19 QTY 1

2.4.4 Stubby

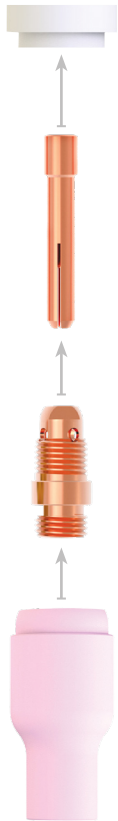

Insulator

USTB80300236	STUBBY GAS LENS INSULATOR SUIT 17/18/26 QTY 2
---------------------	---

Collet

P10N22S	COLLET STUBBY SUIT 17/18/26 1.0MM QTY 2
P10N23S	COLLET STUBBY SUIT 17/18/26 1.6MM QTY 2
P10N24S	COLLET STUBBY SUIT 17/18/26 2.4MM QTY 2
P10N25S	COLLET STUBBY SUIT 17/18/26 3.2MM QTY 2

Collet Body

P17CB20	COLLET BODY STUBBY SUIT 17/18/26 QTY 2
----------------	--

Ceramic Cup

P13N08	CERAMIC CUP SUIT 9/20 SIZE 4 QTY 2
P13N09	CERAMIC CUP SUIT 9/20 SIZE 5 QTY 2
P13N10	CERAMIC CUP SUIT 9/20 SIZE 6 QTY 2
P13N11	CERAMIC CUP SUIT 9/20 SIZE 7 QTY 2
P13N12	CERAMIC CUP SUIT 9/20 SIZE 8 QTY 2
P13N13	CERAMIC CUP SUIT 9/20 SIZE 10 QTY 2

2.4.5 Stubby Gas Lens

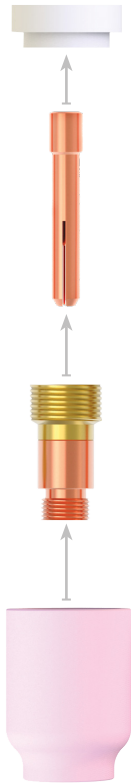

Insulator

USTB80300236	STUBBY GAS LENS INSULATOR SUIT 17/18/26 QTY 2
---------------------	---

Collet

PSTB13N21	GAS LENS COLLET STUBBY SUIT 17/18/26 1.0MM QTY 2
PSTB13N22	GAS LENS COLLET STUBBY SUIT 17/18/26 1.6MM QTY 2
PSTB13N23	GAS LENS COLLET STUBBY SUIT 17/18/26 2.4MM QTY 2

Collet Body

PSTB45V43	GAS LENS BODY STUBBY SUIT 17/18/26 1.6MM QTY 2
PSTB45V44	GAS LENS BODY STUBBY SUIT 17/18/26 2.4MM QTY 2
PSTB45V45	GAS LENS BODY STUBBY SUIT 17/18/26 3.2MM QTY 2

Ceramic Cup

P53N58	GAS LENS CERAMIC CUP SUIT 9/17/18/20/26 SIZE 4 QTY 2
P53N59	GAS LENS CERAMIC CUP SUIT 9/17/18/20/26 SIZE 5 QTY 2
P53N60	GAS LENS CERAMIC CUP SUIT 9/17/18/20/26 SIZE 6 QTY 2
P53N61	GAS LENS CERAMIC CUP SUIT 9/17/18/20/26 SIZE 7 QTY 2
P53N61S	GAS LENS CERAMIC CUP SUIT 9/17/18/20/26 SIZE 8 QTY 2

2.5 26V TIG Torch

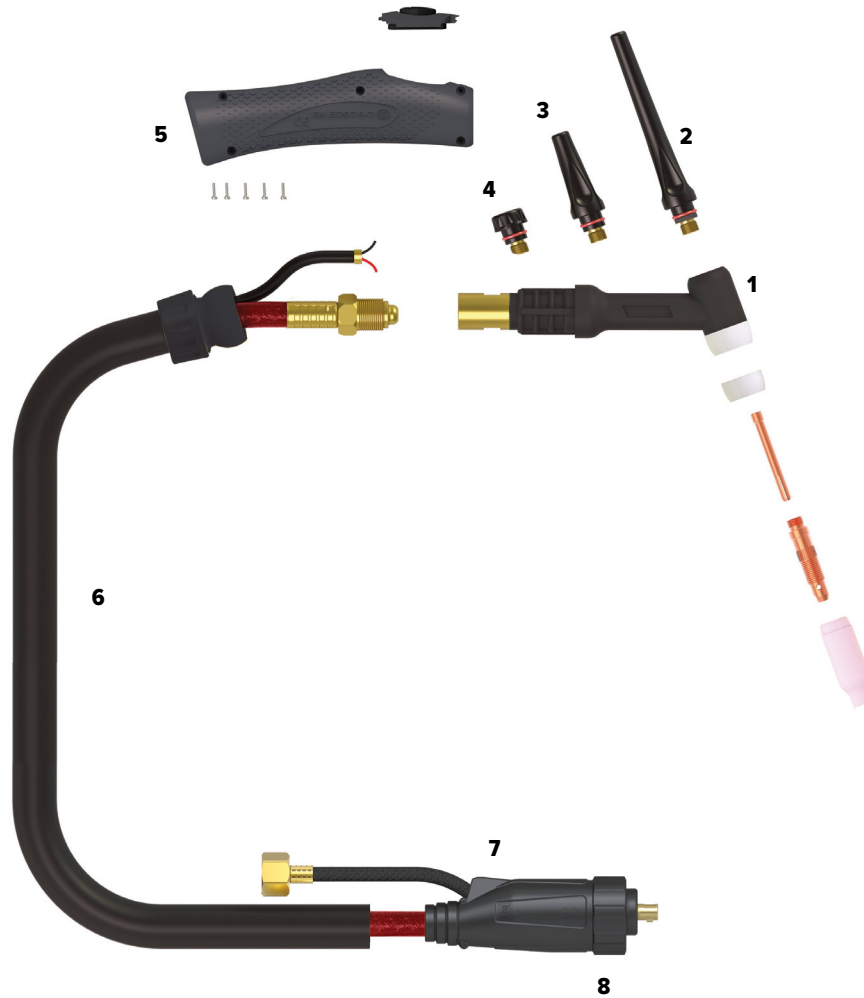

Length	4m	8m
SKU	SR-26-4MCP50-1	SR-26-8MCP50

1	WP26	TORCH HEAD SUIT 26V
1	WP26F	TORCH HEAD FLEXIBLE SUIT 26V
2	P57Y02	LONG BACK CAP SUIT 17/18/26 QTY 2
3	P57Y03	MEDIUM BACK CAP 17/18/26 QTY 2
4	P57Y04	SHORT BACK CAP 17/18/26 QTY 2
5	UER1MS	MOMENTARY KIT
6	UERSWL4	TRIGGER LEAD 12.5FT
6	UERSWL8	TRIGGER LEAD 25FT
7	UERH200	LARGE ERGO TIG HANDLE
8	UERCO200-40	SHEATH X 12.5FT INC LEATHER COVER
9	ML3550H-L	"SURELOK" HOUSING LARGE
10	USL46V28AR	POWER CABLE X 12.5FT SURELOK
10	USL46V30AR	POWER CABLE X 25FT SURELOK

COOLING METHOD	Air-Cooled
DUTY CYCLE - DC	35% @ 180A
DUTY CYCLE - AC	35% @ 125A
DINSE SIZE	35/50
ELECTRODE SIZE	1.0-4.0mm
STANDARD	EN60974-7

2.6 26V TIG Torch Consumables

2.6.1 Standard



Insulator

P18CG	INSULATOR SUIT 17/18/26 QTY 2
--------------	-------------------------------

Collet

P10N22	COLLET SUIT 17/18/26 1.0MM QTY 2
P10N23	COLLET SUIT 17/18/26 1.6MM QTY 2
P10N24	COLLET SUIT 17/18/26 2.4MM QTY 2
P10N25	COLLET SUIT 17/18/26 3.2MM QTY 2

Collet Body

P10N30	COLLET BODY SUIT 17/18/26 1.0MM QTY 2
P10N31	COLLET BODY SUIT 17/18/26 1.6MM QTY 2
P10N32	COLLET BODY SUIT 17/18/26 2.4MM QTY 2
P10N28	COLLET BODY SUIT 17/18/26 3.2MM QTY 2

Ceramic Cup

P10N50	CERAMIC CUP SUIT 17/18/26 SIZE 4 QTY 2
P10N49	CERAMIC CUP SUIT 17/18/26 SIZE 5 QTY 2
P10N48	CERAMIC CUP SUIT 17/18/26 SIZE 6 QTY 2
P10N47	CERAMIC CUP SUIT 17/18/26 SIZE 7 QTY 2
P10N46	CERAMIC CUP SUIT 17/18/26 SIZE 8 QTY 2
P10N45	CERAMIC CUP SUIT 17/18/26 SIZE 10 QTY 2
P10N44	CERAMIC CUP SUIT 17/18/26 SIZE 12 QTY 2
P10N44	CERAMIC CUP SUIT 17/18/26 SIZE 12 QTY 2

2.6.2 Gas Lens

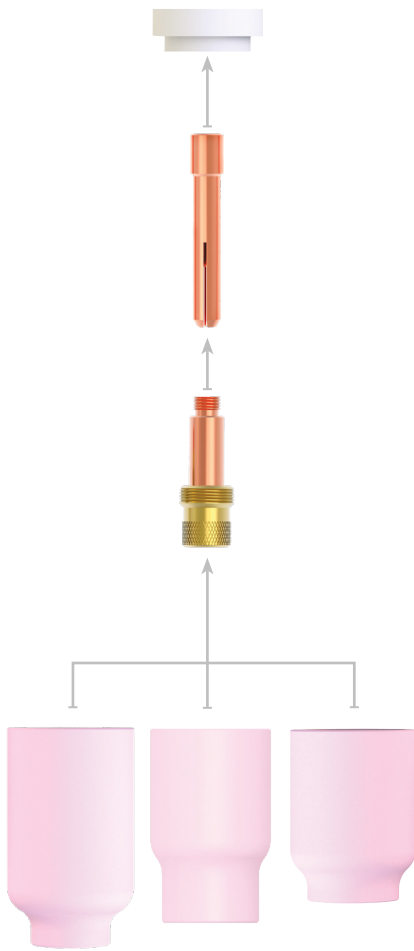

Insulator

P54N01	GAS LENS INSULATOR SUIT 17/18/26 QTY 2
---------------	--

Collet

P10N22	COLLET SUIT 17/18/26 1.0MM QTY 2
P10N23	COLLET SUIT 17/18/26 1.6MM QTY 2
P10N24	COLLET SUIT 17/18/26 2.4MM QTY 2
P10N25	COLLET SUIT 17/18/26 3.2MM QTY 2

Gas Lens

P45V25	GAS LENS SUIT 17/18/26 1.6MM QTY2
P45V26	GAS LENS SUIT 17/18/26 2.4MM QTY2
P45V27	GAS LENS SUIT 17/18/26 3.2MM QTY2

Ceramic Cup

P54N17	GAS LENS CERAMIC CUP SUIT 17/18/26 SIZE 5 QTY 2
P54N15	GAS LENS CERAMIC CUP SUIT 17/18/26 SIZE 7 QTY 2
P54N14	GAS LENS CERAMIC CUP SUIT 17/18/26 SIZE 8 QTY 2

Short Ceramic Cup

P54N15SW	GAS LENS CERAMIC CUP SHORT SUIT 17/18/26 SIZE 7 QTY 2
P54N14SW	GAS LENS CERAMIC CUP SHORT SUIT 17/18/26 SIZE 8 QTY 2
P54N12SW	GAS LENS CERAMIC CUP SHORT SUIT 17/18/26 SIZE 10 QTY 2

Stubby Ceramic Cup

P53N58	GAS LENS CERAMIC CUP SUIT 9/17/18/20/26 SIZE 4 QTY 2
P53N59	GAS LENS CERAMIC CUP SUIT 9/17/18/20/26 SIZE 5 QTY 2
P53N60	GAS LENS CERAMIC CUP SUIT 9/17/18/20/26 SIZE 6 QTY 2
P53N61	GAS LENS CERAMIC CUP SUIT 9/17/18/20/26 SIZE 7 QTY 2
P53N61S	GAS LENS CERAMIC CUP SUIT 9/17/18/20/26 SIZE 8 QTY 2

2.6.3 APEX

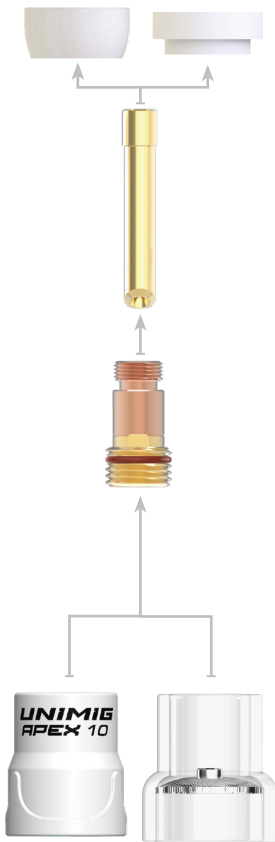

Insulator

USTB80300236	INSULATOR QUARTZ SUIT 17/18/26 QTY 2
P18CG	INSULATOR CERAMIC SUIT 17/18/26 QTY 2

Wedge Collet

U11166	WEDGE COLLET SUIT 17/18/26 1.6MM QTY 2
U11167	WEDGE COLLET SUIT 17/18/26 2.4MM QTY 2
U11168	WEDGE COLLET SUIT 17/18/26 3.2MM QTY 2

Stubby Gas Lens

U11187	GAS LENS BODY STUBBY WITH O RING SUIT 17/18/26 1.6MM QTY 2
U11188	GAS LENS BODY STUBBY WITH O RING SUIT 17/18/26 2.4MM QTY 2
U11189	GAS LENS BODY STUBBY WITH O RING SUIT 17/18/26 3.2MM QTY 2
U42029	SILICONE RUBBER O-RING SUIT APEX QTY 5

Ceramic Cup

U42020	CERAMIC CUP APEX10 SUIT 9/17/18/20/26 SIZE 10 QTY 1
U42021	CERAMIC CUP APEX12 SUIT 9/17/18/20/26 SIZE 12 QTY 1
U42022	CERAMIC CUP APEX14 SUIT 9/17/18/20/26 SIZE 14 QTY 1
U42023	CERAMIC CUP APEX19 SUIT 9/17/18/20/26 SIZE 19 QTY 1
U11017	FILTER SCREEN KIT APEX10 1.6MM, 2.4MM, 3.2MM QTY 1
U11018	FILTER SCREEN KIT APEX12 1.6MM, 2.4MM, 3.2MM QTY 1
U11019	FILTER SCREEN KIT APEX14 1.6MM, 2.4MM, 3.2MM QTY 1
U11020	FILTER SCREEN KIT APEX19 1.6MM, 2.4MM, 3.2MM QTY 1

Quartz Cup

U42024	QUARTZ CUP APEX12 SUIT 9/17/18/20/26 SIZE 12 QTY 1
U42025	QUARTZ CUP APEX19 SUIT 9/17/18/20/26 SIZE 19 QTY 1

2.6.4 Stubby

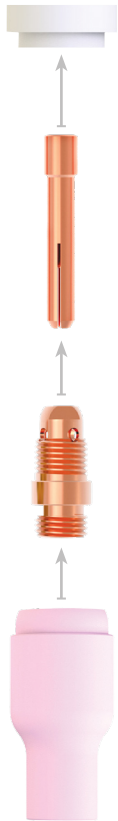

Insulator

USTB80300236	STUBBY GAS LENS INSULATOR SUIT 17/18/26 QTY 2
---------------------	---

Collet

P10N22S	COLLET STUBBY SUIT 17/18/26 1.0MM QTY 2
P10N23S	COLLET STUBBY SUIT 17/18/26 1.6MM QTY 2
P10N24S	COLLET STUBBY SUIT 17/18/26 2.4MM QTY 2
P10N25S	COLLET STUBBY SUIT 17/18/26 3.2MM QTY 2

Collet Body

P17CB20	COLLET BODY STUBBY SUIT 17/18/26 QTY 2
----------------	--

Ceramic Cup

P13N08	CERAMIC CUP SUIT 9/20 SIZE 4 QTY 2
P13N09	CERAMIC CUP SUIT 9/20 SIZE 5 QTY 2
P13N10	CERAMIC CUP SUIT 9/20 SIZE 6 QTY 2
P13N11	CERAMIC CUP SUIT 9/20 SIZE 7 QTY 2
P13N12	CERAMIC CUP SUIT 9/20 SIZE 8 QTY 2
P13N13	CERAMIC CUP SUIT 9/20 SIZE 10 QTY 2

2.6.5 Stubby Gas Lens

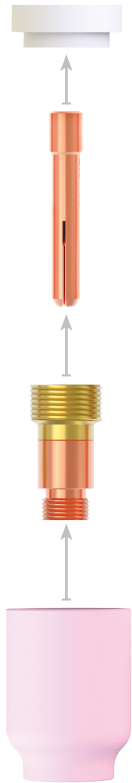

Insulator

USTB80300236	STUBBY GAS LENS INSULATOR SUIT 17/18/26 QTY 2
---------------------	---

Collet

PSTB13N22	GAS LENS COLLET STUBBY SUIT 17/18/26 1.6MM QTY 2
PSTB13N23	GAS LENS COLLET STUBBY SUIT 17/18/26 2.4MM QTY 2

Collet Body

PSTB45V43	GAS LENS BODY STUBBY SUIT 17/18/26 1.6MM QTY 2
PSTB45V44	GAS LENS BODY STUBBY SUIT 17/18/26 2.4MM QTY 2
PSTB45V45	GAS LENS BODY STUBBY SUIT 17/18/26 3.2MM QTY 2

Ceramic Cup

P53N58	GAS LENS CERAMIC CUP SUIT 9/17/18/20/26 SIZE 4 QTY 2
P53N59	GAS LENS CERAMIC CUP SUIT 9/17/18/20/26 SIZE 5 QTY 2
P53N60	GAS LENS CERAMIC CUP SUIT 9/17/18/20/26 SIZE 6 QTY 2
P53N61	GAS LENS CERAMIC CUP SUIT 9/17/18/20/26 SIZE 7 QTY 2
P53N61S	GAS LENS CERAMIC CUP SUIT 9/17/18/20/26 SIZE 8 QTY 2

2.7 SR9 TIG Torch

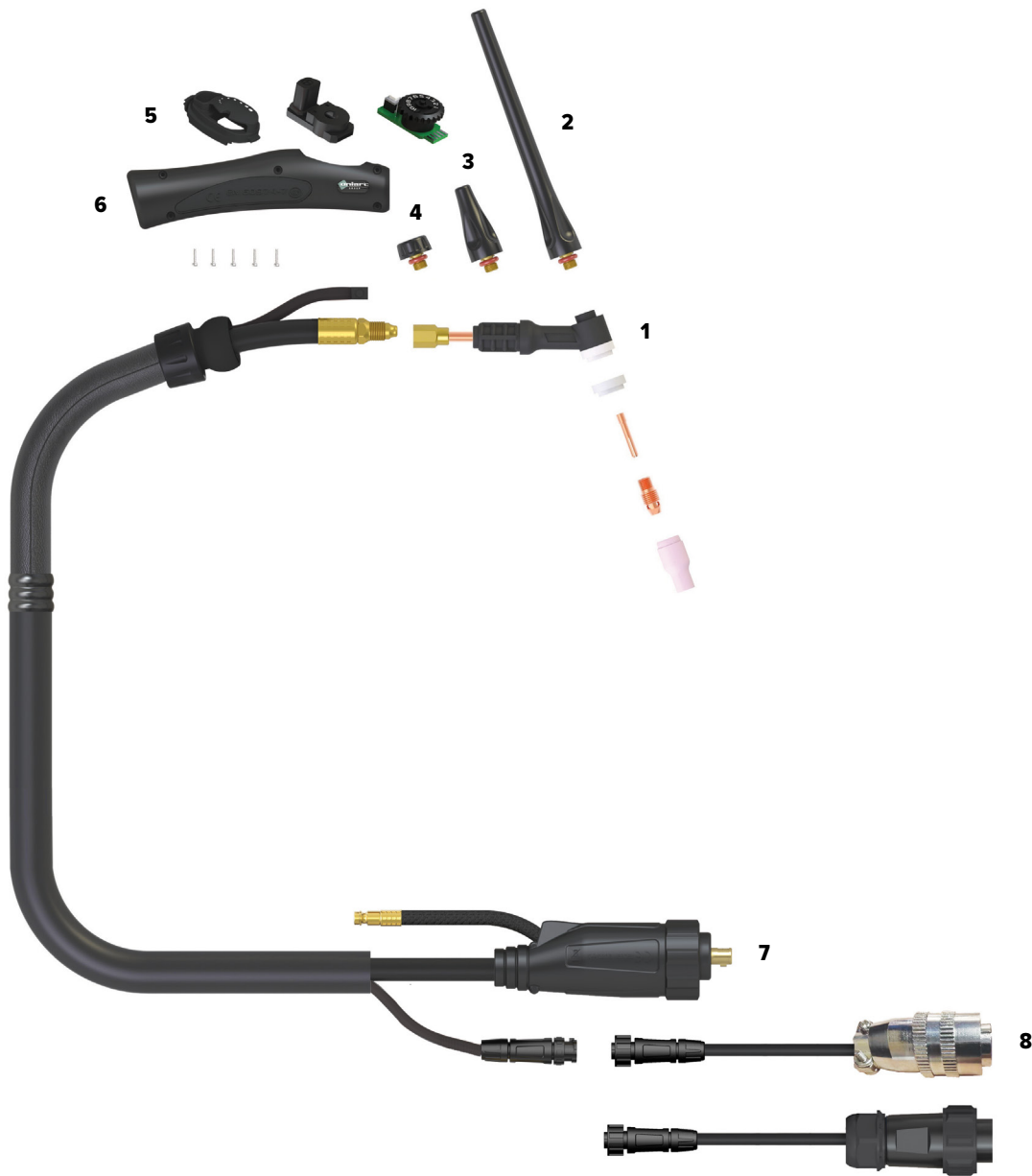

Length	4m	8m
SKU	SR-9-4MCP50	SR-9-8MCP50

1	WP9	TORCH HEAD SUIT SR9
1	WP9F	TORCH HEAD FLEXIBLE SUIT SR9
2	P41V24	LONG BACK CAP SUIT 9/20 QTY 2
3	P41V35	MEDIUM BACK CAP SUIT 9/20 QTY 2
4	P41V33	SHORT BACK CAP SUIT 9/20 QTY 2
5	UER1MS	TIG TORCH SWITCH SINGLE BUTTON SUIT SR
6	UERSWL4	TRIGGER LEAD 12.5FT
6	UERSWL8	TRIGGER LEAD 25FT
7	ML3550H-M	"SURELOK" HOUSING SMALL
8	USL57Y01AR	POWER CABLE X 12.5FT SURELOK
8	USL57Y03AR	POWER CABLE X 25FT SURELOK

COOLING METHOD	Air-Cooled
DUTY CYCLE - DC	35% @ 125A
DUTY CYCLE - AC	35% @ 90A
DINSE SIZE	35/50
ELECTRODE SIZE	1.0-2.4mm
STANDARD	EN60974-7

2.8 SR9 TIG Torch Consumables

2.8.1 Standard



Insulator

P598882	INSULATOR SUIT 9/20 QTY 2
----------------	---------------------------

Collet

P13N22	COLLET SUIT 9/20 1.6MM QTY 2
P13N23	COLLET SUIT 9/20 2.4MM QTY 2
P13N24	COLLET SUIT 9/20 3.2MM QTY 2

Collet Body

P13N27	COLLET BODY SUIT 9/20 1.6MM QTY 2
P13N28	COLLET BODY SUIT 9/20 2.4MM QTY 2
P13N29	COLLET BODY SUIT 9/20 3.2MM QTY 2

Ceramic Cup

P13N08	CERAMIC CUP SUIT 9/20 SIZE 4 QTY 2
P13N09	CERAMIC CUP SUIT 9/20 SIZE 5 QTY 2
P13N10	CERAMIC CUP SUIT 9/20 SIZE 6 QTY 2
P13N11	CERAMIC CUP SUIT 9/20 SIZE 7 QTY 2
P13N12	CERAMIC CUP SUIT 9/20 SIZE 8 QTY 2
P13N13	CERAMIC CUP SUIT 9/20 SIZE 10 QTY 2

2.8.2 Gas Lens



Insulator

P598882	INSULATOR SUIT 9/20 QTY 2
----------------	---------------------------

Collet

P13N22	COLLET SUIT 9/20 1.6MM QTY 2
P13N23	COLLET SUIT 9/20 2.4MM QTY 2
P13N24	COLLET SUIT 9/20 3.2MM QTY 2

Gas Lens

P45V43	GAS LENS SUIT 9/20 1.6MM QTY 2
P45V44	GAS LENS SUIT 9/20 2.4MM QTY 2
P45V45	GAS LENS SUIT 9/20 3.2MM QTY 2

Ceramic Cup

P53N58	GAS LENS CERAMIC CUP SUIT 9/17/18/20/26 SIZE 4 QTY 2
P53N59	GAS LENS CERAMIC CUP SUIT 9/17/18/20/26 SIZE 5 QTY 2
P53N60	GAS LENS CERAMIC CUP SUIT 9/17/18/20/26 SIZE 6 QTY 2
P53N61	GAS LENS CERAMIC CUP SUIT 9/17/18/20/26 SIZE 7 QTY 2
P53N61S	GAS LENS CERAMIC CUP SUIT 9/17/18/20/26 SIZE 8 QTY 2

2.8.3 APEX

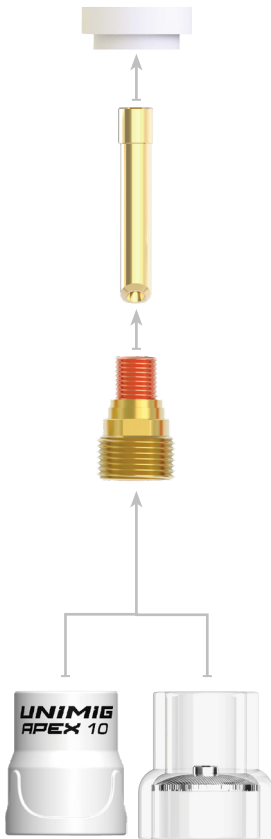

Insulator

P598882	INSULATOR SUIT 9/20 QTY 2
----------------	---------------------------

Wedge Collet

U11169	WEDGE COLLET SUIT 9/20 1.6MM QTY 2
U11170	WEDGE COLLET SUIT 9/20 2.4MM QTY 2

Gas Lens

U11190	GAS LENS BODY WITH O RING SUIT 9/20 1.6MM QTY 2
U11191	GAS LENS BODY WITH O RING SUIT 9/20 2.4MM QTY 2
U42029	APEX SILICONE RUBBER 'O'-RING QTY 5

Ceramic Cup

U42020	CERAMIC CUP APEX10 SUIT 9/17/18/20/26 SIZE 10 QTY 1
U42021	CERAMIC CUP APEX12 SUIT 9/17/18/20/26 SIZE 12 QTY 1
U42022	CERAMIC CUP APEX14 SUIT 9/17/18/20/26 SIZE 14 QTY 1
U42023	CERAMIC CUP APEX19 SUIT 9/17/18/20/26 SIZE 19 QTY 1
U11017	FILTER SCREEN KIT APEX10 1.6MM, 2.4MM, 3.2MM QTY 1
U11018	FILTER SCREEN KIT APEX12 1.6MM, 2.4MM, 3.2MM QTY 1
U11019	FILTER SCREEN KIT APEX14 1.6MM, 2.4MM, 3.2MM QTY 1
U11020	FILTER SCREEN KIT APEX19 1.6MM, 2.4MM, 3.2MM QTY 1

Quartz Cup

U42024	QUARTZ CUP APEX12 SUIT 9/17/18/20/26 SIZE 12 QTY 1
U42025	QUARTZ CUP APEX19 SUIT 9/17/18/20/26 SIZE 19 QTY 1

2.9 SR17 TIG Torch

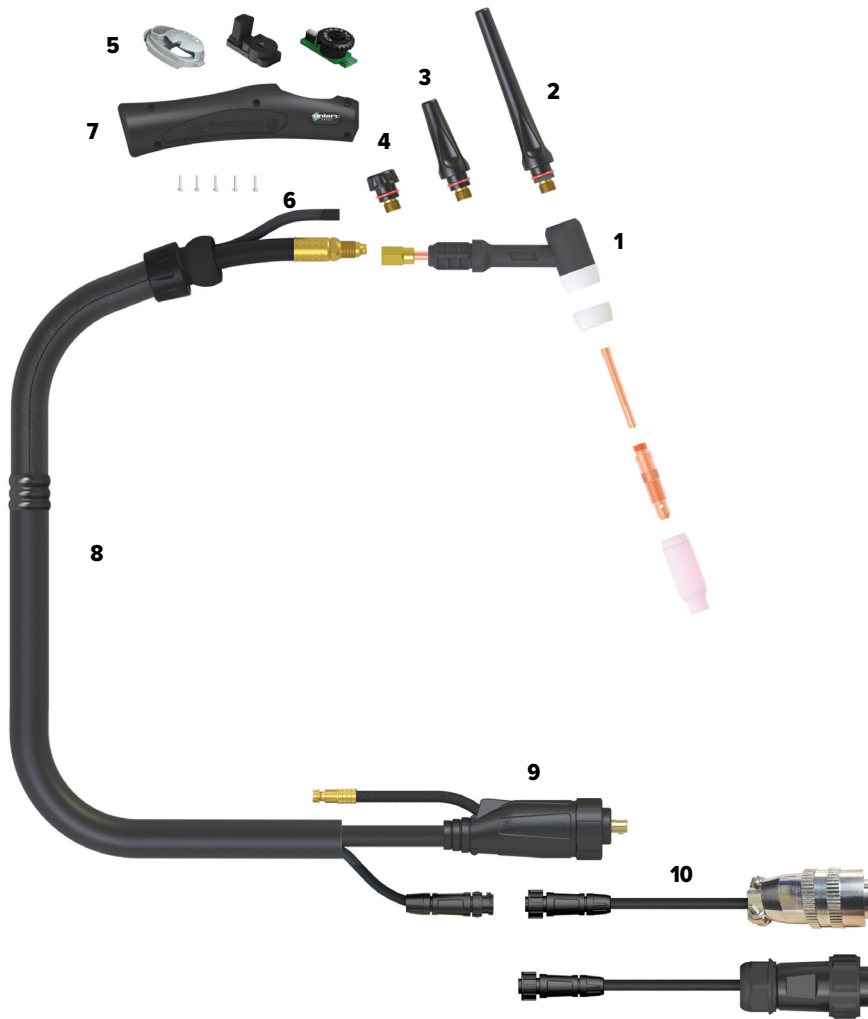

Length	4m	8m
SKU	SR-17-4MCP50-1	SR-17-8MCP50

1	WP17	TORCH HEAD SUIT SR17
1	WP17F	TORCH HEAD FLEXIBLE SUIT SR17
2	P57Y02	LONG BACK CAP SUIT 17/18/26 QTY 2
3	P57Y03	MEDIUM BACK CAP SUIT 17/18/26 QTY 2
4	P57Y04	SHORT BACK CAP SUIT 17/18/26 QTY 2
5	UER1MS	TIG TORCH SWITCH SINGLE BUTTON SUIT SR
6	UERSWL4	TRIGGER LEAD 12.5FT
6	UERSWL8	TRIGGER LEAD 25FT
7	UERH200	LARGE ERGO TIG HANDLE
8	UERCO200-40	SHEATH X 12.5FT INC LEATHER COVER
9	ML3550H-L	SURELOK HOUSING LARGE
10	USL46V28AR	POWER CABLE X 12.5FT SURELOK
10	USL46V30AR	POWER CABLE X 25FT SURELOK

COOLING METHOD	Air-Cooled
DUTY CYCLE - DC	35% @ 150A
DUTY CYCLE - AC	35% @ 105A
DINSE SIZE	35/50
ELECTRODE SIZE	1.0-3.2mm
STANDARD	EN60974-7

2.10 SR17 TIG Torch Consumables

2.10.1 Standard



Insulator

P18CG	INSULATOR SUIT 17/18/26 QTY 2
--------------	-------------------------------

Collet

P10N22	COLLET SUIT 17/18/26 1.0MM QTY 2
P10N23	COLLET SUIT 17/18/26 1.6MM QTY 2
P10N24	COLLET SUIT 17/18/26 2.4MM QTY 2
P10N25	COLLET SUIT 17/18/26 3.2MM QTY 2

Collet Body

P10N30	COLLET BODY SUIT 17/18/26 1.0MM QTY 2
P10N31	COLLET BODY SUIT 17/18/26 1.6MM QTY 2
P10N32	COLLET BODY SUIT 17/18/26 2.4MM QTY 2
P10N28	COLLET BODY SUIT 17/18/26 3.2MM QTY 2

Ceramic Cup

P10N50	CERAMIC CUP SUIT 17/18/26 SIZE 4 QTY 2
P10N49	CERAMIC CUP SUIT 17/18/26 SIZE 5 QTY 2
P10N48	CERAMIC CUP SUIT 17/18/26 SIZE 6 QTY 2
P10N47	CERAMIC CUP SUIT 17/18/26 SIZE 7 QTY 2
P10N46	CERAMIC CUP SUIT 17/18/26 SIZE 8 QTY 2
P10N45	CERAMIC CUP SUIT 17/18/26 SIZE 10 QTY 2
P10N44	CERAMIC CUP SUIT 17/18/26 SIZE 12 QTY 2

2.10.2 Gas Lens

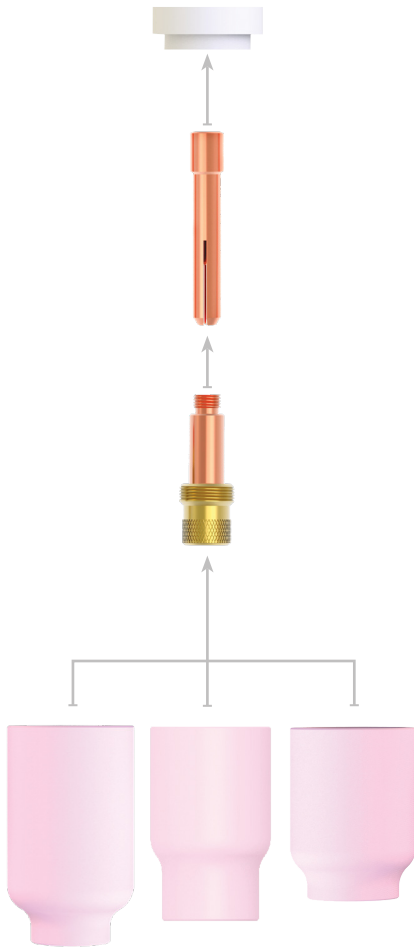

Insulator

P54N01	GAS LENS INSULATOR SUIT 17/18/26 QTY 2
---------------	--

Collet

P10N22	COLLET SUIT 17/18/26 1.0MM QTY 2
P10N23	COLLET SUIT 17/18/26 1.6MM QTY 2
P10N24	COLLET SUIT 17/18/26 2.4MM QTY 2
P10N25	COLLET SUIT 17/18/26 3.2MM QTY 2

Gas Lens

P45V25	GAS LENS SUIT 17/18/26 1.6MM QTY2
P45V26	GAS LENS SUIT 17/18/26 2.4MM QTY2
P45V27	GAS LENS SUIT 17/18/26 3.2MM QTY2

Ceramic Cup

P54N17	GAS LENS CERAMIC CUP SUIT 17/18/26 SIZE 5 QTY 2
P54N15	GAS LENS CERAMIC CUP SUIT 17/18/26 SIZE 7 QTY 2
P54N14	GAS LENS CERAMIC CUP SUIT 17/18/26 SIZE 8 QTY 2

Short Ceramic Cup

P54N15SW	GAS LENS CERAMIC CUP SHORT SUIT 17/18/26 SIZE 7 QTY 2
P54N14SW	GAS LENS CERAMIC CUP SHORT SUIT 17/18/26 SIZE 8 QTY 2
P54N12SW	GAS LENS CERAMIC CUP SHORT SUIT 17/18/26 SIZE 10 QTY 2

Stubby Ceramic Cup

P53N58	GAS LENS CERAMIC CUP SUIT 9/17/18/20/26 SIZE 4 QTY 2
P53N59	GAS LENS CERAMIC CUP SUIT 9/17/18/20/26 SIZE 5 QTY 2
P53N60	GAS LENS CERAMIC CUP SUIT 9/17/18/20/26 SIZE 6 QTY 2
P53N61	GAS LENS CERAMIC CUP SUIT 9/17/18/20/26 SIZE 7 QTY 2
P53N61S	GAS LENS CERAMIC CUP SUIT 9/17/18/20/26 SIZE 8 QTY 2

2.10.3 APEX

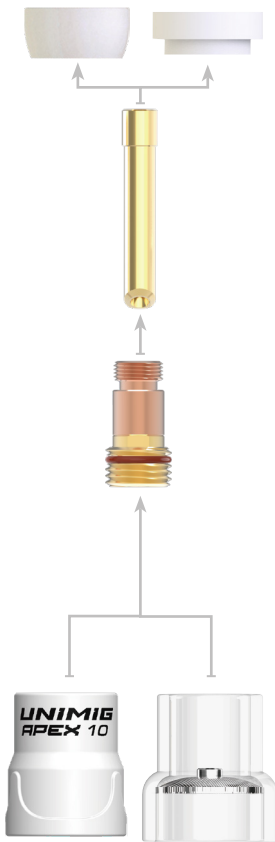

Insulator

USTB80300236	INSULATOR QUARTZ SUIT 17/18/26 QTY 2
P18CG	INSULATOR CERAMIC SUIT 17/18/26 QTY 2

Wedge Collet

U11166	WEDGE COLLET SUIT 17/18/26 1.6MM QTY 2
U11167	WEDGE COLLET SUIT 17/18/26 2.4MM QTY 2
U11168	WEDGE COLLET SUIT 17/18/26 3.2MM QTY 2

Stubby Gas Lens

U11187	GAS LENS BODY STUBBY WITH O RING SUIT 17/18/26 1.6MM QTY 2
U11188	GAS LENS BODY STUBBY WITH O RING SUIT 17/18/26 2.4MM QTY 2
U11189	GAS LENS BODY STUBBY WITH O RING SUIT 17/18/26 3.2MM QTY 2
U42029	SILICONE RUBBER O-RING SUIT APEX QTY 5

Ceramic Cup

U42020	CERAMIC CUP APEX10 SUIT 9/17/18/20/26 SIZE 10 QTY 1
U42021	CERAMIC CUP APEX12 SUIT 9/17/18/20/26 SIZE 12 QTY 1
U42022	CERAMIC CUP APEX14 SUIT 9/17/18/20/26 SIZE 14 QTY 1
U42023	CERAMIC CUP APEX19 SUIT 9/17/18/20/26 SIZE 19 QTY 1
U11017	FILTER SCREEN KIT APEX10 1.6MM, 2.4MM, 3.2MM QTY 1
U11018	FILTER SCREEN KIT APEX12 1.6MM, 2.4MM, 3.2MM QTY 1
U11019	FILTER SCREEN KIT APEX14 1.6MM, 2.4MM, 3.2MM QTY 1
U11020	FILTER SCREEN KIT APEX19 1.6MM, 2.4MM, 3.2MM QTY 1

Quartz Cup

U42024	QUARTZ CUP APEX12 SUIT 9/17/18/20/26 SIZE 12 QTY 1
U42025	QUARTZ CUP APEX19 SUIT 9/17/18/20/26 SIZE 19 QTY 1

2.10.4 Stubby

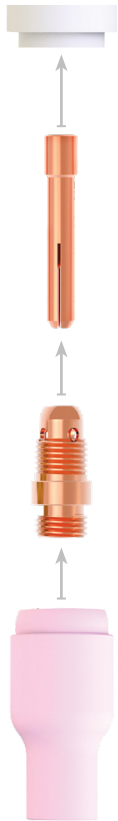

Insulator

USTB80300236	STUBBY GAS LENS INSULATOR SUIT 17/18/26 QTY 2
---------------------	---

Collet

P10N22S	COLLET STUBBY SUIT 17/18/26 1.0MM QTY 2
P10N23S	COLLET STUBBY SUIT 17/18/26 1.6MM QTY 2
P10N24S	COLLET STUBBY SUIT 17/18/26 2.4MM QTY 2
P10N25S	COLLET STUBBY SUIT 17/18/26 3.2MM QTY 2

Collet Body

P17CB20	COLLET BODY STUBBY SUIT 17/18/26 QTY 2
----------------	--

Ceramic Cup

P13N08	CERAMIC CUP SUIT 9/20 SIZE 4 QTY 2
P13N09	CERAMIC CUP SUIT 9/20 SIZE 5 QTY 2
P13N10	CERAMIC CUP SUIT 9/20 SIZE 6 QTY 2
P13N11	CERAMIC CUP SUIT 9/20 SIZE 7 QTY 2
P13N12	CERAMIC CUP SUIT 9/20 SIZE 8 QTY 2
P13N13	CERAMIC CUP SUIT 9/20 SIZE 10 QTY 2

2.10.5 Stubby Gas Lens

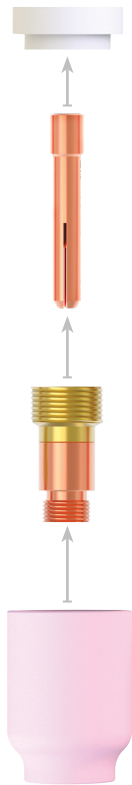

Insulator

USTB80300236	STUBBY GAS LENS INSULATOR SUIT 17/18/26 QTY 2
---------------------	---

Collet

PSTB13N21	GAS LENS COLLET STUBBY SUIT 17/18/26 1.0MM QTY 2
PSTB13N22	GAS LENS COLLET STUBBY SUIT 17/18/26 1.6MM QTY 2
PSTB13N23	GAS LENS COLLET STUBBY SUIT 17/18/26 2.4MM QTY 2

Collet Body

PSTB45V43	GAS LENS BODY STUBBY SUIT 17/18/26 1.6MM QTY 2
PSTB45V44	GAS LENS BODY STUBBY SUIT 17/18/26 2.4MM QTY 2
PSTB45V45	GAS LENS BODY STUBBY SUIT 17/18/26 3.2MM QTY 2

Ceramic Cup

P53N58	GAS LENS CERAMIC CUP SUIT 9/17/18/20/26 SIZE 4 QTY 2
P53N59	GAS LENS CERAMIC CUP SUIT 9/17/18/20/26 SIZE 5 QTY 2
P53N60	GAS LENS CERAMIC CUP SUIT 9/17/18/20/26 SIZE 6 QTY 2
P53N61	GAS LENS CERAMIC CUP SUIT 9/17/18/20/26 SIZE 7 QTY 2
P53N61S	GAS LENS CERAMIC CUP SUIT 9/17/18/20/26 SIZE 8 QTY 2

2.11 SR18 TIG Torch

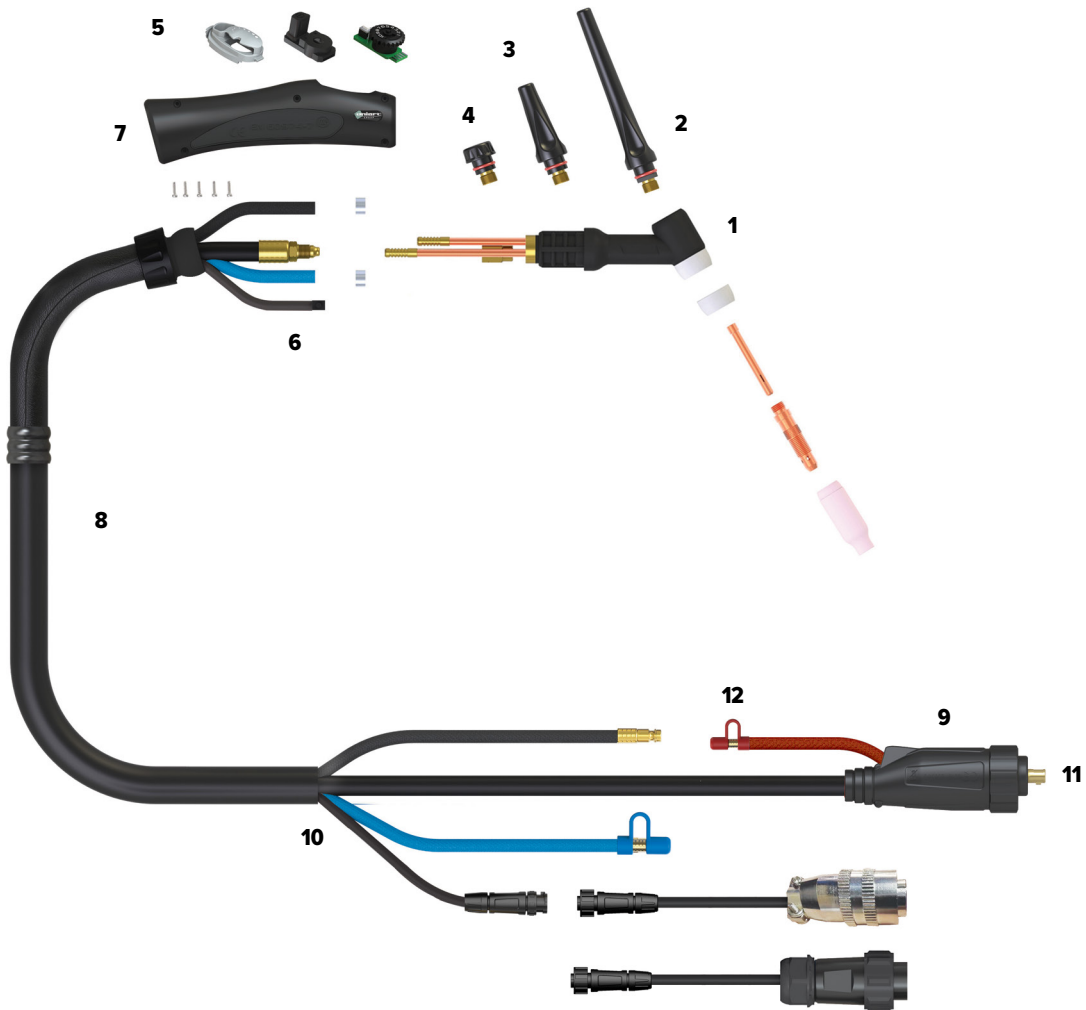

Length	4m	8m
SKU	SR-18-4MCP50	SR-18-8MCP50

1	WP18	TORCH HEAD SUIT SR18
1	WP18FX	TORCH HEAD FLEXIBLE SUIT SR18
2	P57Y02	LONG BACK CAP SUIT 17/18/26 QTY 2
3	P57Y03	MEDIUM BACK CAP SUIT 17/18/26 QTY 2
4	P57Y04	SHORT BACK CAP SUIT 17/18/26 QTY 2
5	UER1MS	TIG TORCH SWITCH SINGLE BUTTON SUIT SR
6	UERSWL4	TRIGGER LEAD 12.5FT
6	UERSWL8	TRIGGER LEAD 25FT
7	UERH200	LARGE ERGO TIG HANDLE
8	UERCO200-40	SHEATH X 12.5FT INC LEATHER COVER
9	USLH26-S	CABLE SUPPORT LARGE
10	USLH26-H	"SURELOK" HOUSING LARGE
11	USL40V64AR	POWER CABLE X 12.5FT "SURELOK" RUBBER
11	USL41V29AR	POWER CABLE X 25FT "SURELOK" RUBBER
12	USL3550	"SURELOK" BODY & SUPPORT

COOLING METHOD	Water-Cooled
DUTY CYCLE - DC	100% @ 380A
DUTY CYCLE - AC	100% @ 270A
DINSE SIZE	35/50
ELECTRODE SIZE	1.0-4.0mm
STANDARD	EN60974-7
MINIMUM WATER FLOW	1.0L/min
MINIMUM WATER INLET PRESSURE	2.0 Bar
MAXIMUM WATER INLET PRESSURE	5.0 Bar
MAXIMUM WATER INLET TEMPERATURE	50°C
MINIMUM COOLING POWER	900W

2.12 SR18 TIG Torch Consumables

2.12.1 Standard



Insulator

P18CG	INSULATOR SUIT 17/18/26 QTY 2
--------------	-------------------------------

Collet

P10N22	COLLET SUIT 17/18/26 1.0MM QTY 2
P10N23	COLLET SUIT 17/18/26 1.6MM QTY 2
P10N24	COLLET SUIT 17/18/26 2.4MM QTY 2
P10N25	COLLET SUIT 17/18/26 3.2MM QTY 2

Collet Body

P10N30	COLLET BODY SUIT 17/18/26 1.0MM QTY 2
P10N31	COLLET BODY SUIT 17/18/26 1.6MM QTY 2
P10N32	COLLET BODY SUIT 17/18/26 2.4MM QTY 2
P10N28	COLLET BODY SUIT 17/18/26 3.2MM QTY 2

Ceramic Cup

P10N50	CERAMIC CUP SUIT 17/18/26 SIZE 4 QTY 2
P10N49	CERAMIC CUP SUIT 17/18/26 SIZE 5 QTY 2
P10N48	CERAMIC CUP SUIT 17/18/26 SIZE 6 QTY 2
P10N47	CERAMIC CUP SUIT 17/18/26 SIZE 7 QTY 2
P10N46	CERAMIC CUP SUIT 17/18/26 SIZE 8 QTY 2
P10N45	CERAMIC CUP SUIT 17/18/26 SIZE 10 QTY 2
P10N44	CERAMIC CUP SUIT 17/18/26 SIZE 12 QTY 2
P10N44	CERAMIC CUP SUIT 17/18/26 SIZE 12 QTY 2

2.12.2 Gas Lens

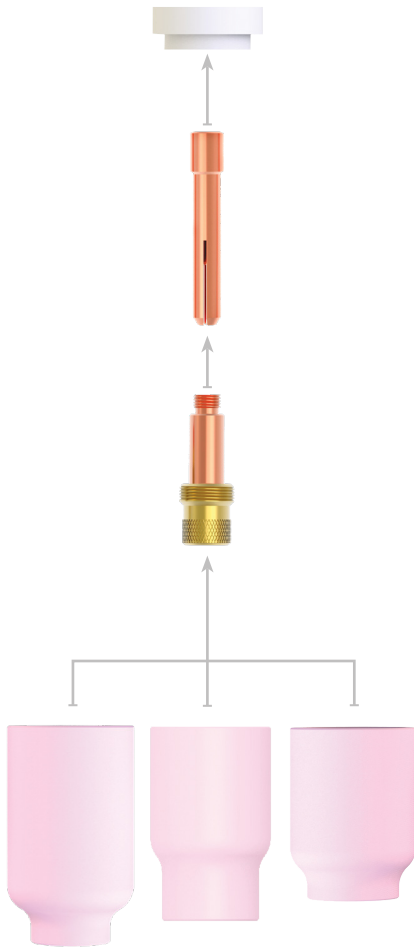

Insulator

P54N01	GAS LENS INSULATOR SUIT 17/18/26 QTY 2
---------------	--

Collet

P10N22	COLLET SUIT 17/18/26 1.0MM QTY 2
P10N23	COLLET SUIT 17/18/26 1.6MM QTY 2
P10N24	COLLET SUIT 17/18/26 2.4MM QTY 2
P10N25	COLLET SUIT 17/18/26 3.2MM QTY 2

Gas Lens

P45V25	GAS LENS SUIT 17/18/26 1.6MM QTY2
P45V26	GAS LENS SUIT 17/18/26 2.4MM QTY2
P45V27	GAS LENS SUIT 17/18/26 3.2MM QTY2

Ceramic Cup

P54N17	GAS LENS CERAMIC CUP SUIT 17/18/26 SIZE 5 QTY 2
P54N15	GAS LENS CERAMIC CUP SUIT 17/18/26 SIZE 7 QTY 2
P54N14	GAS LENS CERAMIC CUP SUIT 17/18/26 SIZE 8 QTY 2

Short Ceramic Cup

P54N15SW	GAS LENS CERAMIC CUP SHORT SUIT 17/18/26 SIZE 7 QTY 2
P54N14SW	GAS LENS CERAMIC CUP SHORT SUIT 17/18/26 SIZE 8 QTY 2
P54N12SW	GAS LENS CERAMIC CUP SHORT SUIT 17/18/26 SIZE 10 QTY 2

Stubby Ceramic Cup

P53N58	GAS LENS CERAMIC CUP SUIT 9/17/18/20/26 SIZE 4 QTY 2
P53N59	GAS LENS CERAMIC CUP SUIT 9/17/18/20/26 SIZE 5 QTY 2
P53N60	GAS LENS CERAMIC CUP SUIT 9/17/18/20/26 SIZE 6 QTY 2
P53N61	GAS LENS CERAMIC CUP SUIT 9/17/18/20/26 SIZE 7 QTY 2
P53N61S	GAS LENS CERAMIC CUP SUIT 9/17/18/20/26 SIZE 8 QTY 2

2.12.3 APEX

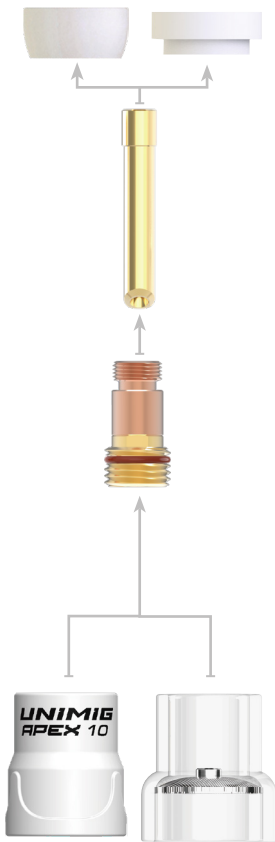

Insulator

USTB80300236	INSULATOR QUARTZ SUIT 17/18/26 QTY 2
P18CG	INSULATOR CERAMIC SUIT 17/18/26 QTY 2

Wedge Collet

U11166	WEDGE COLLET SUIT 17/18/26 1.6MM QTY 2
U11167	WEDGE COLLET SUIT 17/18/26 2.4MM QTY 2
U11168	WEDGE COLLET SUIT 17/18/26 3.2MM QTY 2

Stubby Gas Lens

U11187	GAS LENS BODY STUBBY WITH O RING SUIT 17/18/26 1.6MM QTY 2
U11188	GAS LENS BODY STUBBY WITH O RING SUIT 17/18/26 2.4MM QTY 2
U11189	GAS LENS BODY STUBBY WITH O RING SUIT 17/18/26 3.2MM QTY 2
U42029	SILICONE RUBBER O-RING SUIT APEX QTY 5

Ceramic Cup

U42020	CERAMIC CUP APEX10 SUIT 9/17/18/20/26 SIZE 10 QTY 1
U42021	CERAMIC CUP APEX12 SUIT 9/17/18/20/26 SIZE 12 QTY 1
U42022	CERAMIC CUP APEX14 SUIT 9/17/18/20/26 SIZE 14 QTY 1
U42023	CERAMIC CUP APEX19 SUIT 9/17/18/20/26 SIZE 19 QTY 1
U11017	FILTER SCREEN KIT APEX10 1.6MM, 2.4MM, 3.2MM QTY 1
U11018	FILTER SCREEN KIT APEX12 1.6MM, 2.4MM, 3.2MM QTY 1
U11019	FILTER SCREEN KIT APEX14 1.6MM, 2.4MM, 3.2MM QTY 1
U11020	FILTER SCREEN KIT APEX19 1.6MM, 2.4MM, 3.2MM QTY 1

Quartz Cup

U42024	QUARTZ CUP APEX12 SUIT 9/17/18/20/26 SIZE 12 QTY 1
U42025	QUARTZ CUP APEX19 SUIT 9/17/18/20/26 SIZE 19 QTY 1

2.12.4 Stubby

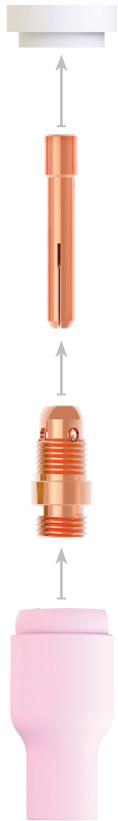

Insulator

USTB80300236	STUBBY GAS LENS INSULATOR SUIT 17/18/26 QTY 2
---------------------	---

Collet

P10N22S	COLLET STUBBY SUIT 17/18/26 1.0MM QTY 2
P10N23S	COLLET STUBBY SUIT 17/18/26 1.6MM QTY 2
P10N24S	COLLET STUBBY SUIT 17/18/26 2.4MM QTY 2
P10N25S	COLLET STUBBY SUIT 17/18/26 3.2MM QTY 2

Collet Body

P17CB20	COLLET BODY STUBBY SUIT 17/18/26 QTY 2
----------------	--

Ceramic Cup

P13N08	CERAMIC CUP SUIT 9/20 SIZE 4 QTY 2
P13N09	CERAMIC CUP SUIT 9/20 SIZE 5 QTY 2
P13N10	CERAMIC CUP SUIT 9/20 SIZE 6 QTY 2
P13N11	CERAMIC CUP SUIT 9/20 SIZE 7 QTY 2
P13N12	CERAMIC CUP SUIT 9/20 SIZE 8 QTY 2
P13N13	CERAMIC CUP SUIT 9/20 SIZE 10 QTY 2

2.12.5 Stubby Gas Lens

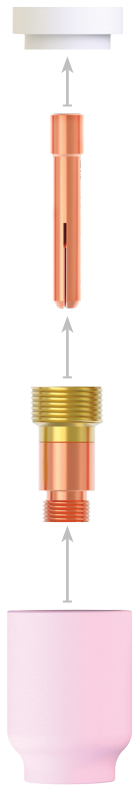

Insulator

USTB80300236	STUBBY GAS LENS INSULATOR SUIT 17/18/26 QTY 2
---------------------	---

Collet

PSTB13N21	GAS LENS COLLET STUBBY SUIT 17/18/26 1.0MM QTY 2
PSTB13N22	GAS LENS COLLET STUBBY SUIT 17/18/26 1.6MM QTY 2
PSTB13N23	GAS LENS COLLET STUBBY SUIT 17/18/26 2.4MM QTY 2

Collet Body

PSTB45V43	GAS LENS BODY STUBBY SUIT 17/18/26 1.6MM QTY 2
PSTB45V44	GAS LENS BODY STUBBY SUIT 17/18/26 2.4MM QTY 2
PSTB45V45	GAS LENS BODY STUBBY SUIT 17/18/26 3.2MM QTY 2

Ceramic Cup

P53N58	GAS LENS CERAMIC CUP SUIT 9/17/18/20/26 SIZE 4 QTY 2
P53N59	GAS LENS CERAMIC CUP SUIT 9/17/18/20/26 SIZE 5 QTY 2
P53N60	GAS LENS CERAMIC CUP SUIT 9/17/18/20/26 SIZE 6 QTY 2
P53N61	GAS LENS CERAMIC CUP SUIT 9/17/18/20/26 SIZE 7 QTY 2
P53N61S	GAS LENS CERAMIC CUP SUIT 9/17/18/20/26 SIZE 8 QTY 2

2.13 SR26 TIG Torch

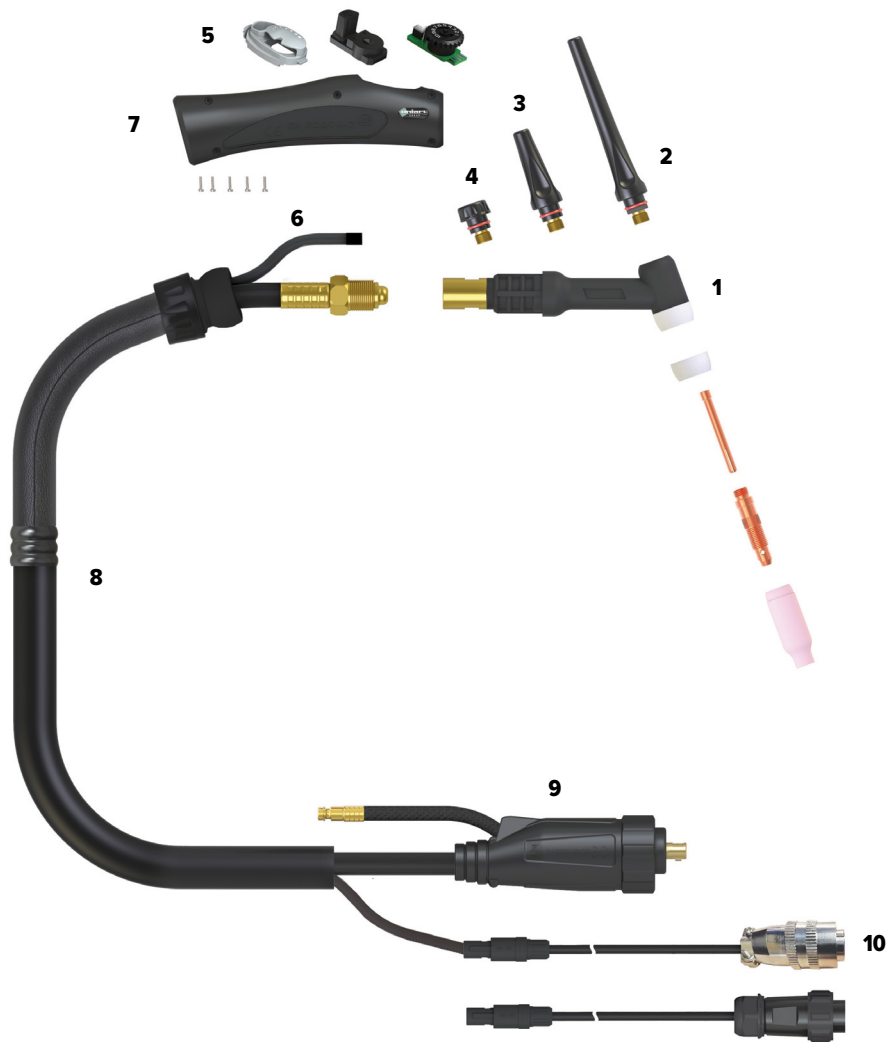

Length	4m	8m
SKU	SR-26-4MCP50-1	SR-26-8MCP50

1	WP26	TORCH HEAD SUIT SR26
1	WP26F	TORCH HEAD FLEXIBLE SUIT SR26
2	P57Y02	LONG BACK CAP SUIT 17/18/26 QTY 2
3	P57Y03	MEDIUM BACK CAP SUIT 17/18/26 QTY 2
4	P57Y04	SHORT BACK CAP SUIT 17/18/26 QTY 2
5	UER1MS	TIG TORCH SWITCH SINGLE BUTTON SUIT SR
6	UERSWL4	TRIGGER LEAD 12.5FT
6	UERSWL8	TRIGGER LEAD 25FT
7	UERH200	LARGE ERGO TIG HANDLE
8	UERCO200-40	SHEATH X 12.5FT INC LEATHER COVER
9	ML3550H-L	"SURELOK" HOUSING LARGE
10	USL46V28AR	POWER CABLE X 12.5FT SURELOK
10	USL46V30AR	POWER CABLE X 25FT SURELOK

COOLING METHOD	Air-Cooled
DUTY CYCLE - DC	35% @ 180A
DUTY CYCLE - AC	35% @ 125A
DINSE SIZE	35/50
ELECTRODE SIZE	1.0-4.0mm
STANDARD	EN60974-7

2.14 SR26 TIG Torch Consumables

2.14.1 Standard



Insulator

P18CG	INSULATOR SUIT 17/18/26 QTY 2
--------------	-------------------------------

Collet

P10N22	COLLET SUIT 17/18/26 1.0MM QTY 2
P10N23	COLLET SUIT 17/18/26 1.6MM QTY 2
P10N24	COLLET SUIT 17/18/26 2.4MM QTY 2
P10N25	COLLET SUIT 17/18/26 3.2MM QTY 2

Collet Body

P10N30	COLLET BODY SUIT 17/18/26 1.0MM QTY 2
P10N31	COLLET BODY SUIT 17/18/26 1.6MM QTY 2
P10N32	COLLET BODY SUIT 17/18/26 2.4MM QTY 2
P10N28	COLLET BODY SUIT 17/18/26 3.2MM QTY 2

Ceramic Cup

P10N50	CERAMIC CUP SUIT 17/18/26 SIZE 4 QTY 2
P10N49	CERAMIC CUP SUIT 17/18/26 SIZE 5 QTY 2
P10N48	CERAMIC CUP SUIT 17/18/26 SIZE 6 QTY 2
P10N47	CERAMIC CUP SUIT 17/18/26 SIZE 7 QTY 2
P10N46	CERAMIC CUP SUIT 17/18/26 SIZE 8 QTY 2
P10N45	CERAMIC CUP SUIT 17/18/26 SIZE 10 QTY 2
P10N44	CERAMIC CUP SUIT 17/18/26 SIZE 12 QTY 2
P10N44	CERAMIC CUP SUIT 17/18/26 SIZE 12 QTY 2

2.14.2 Gas Lens

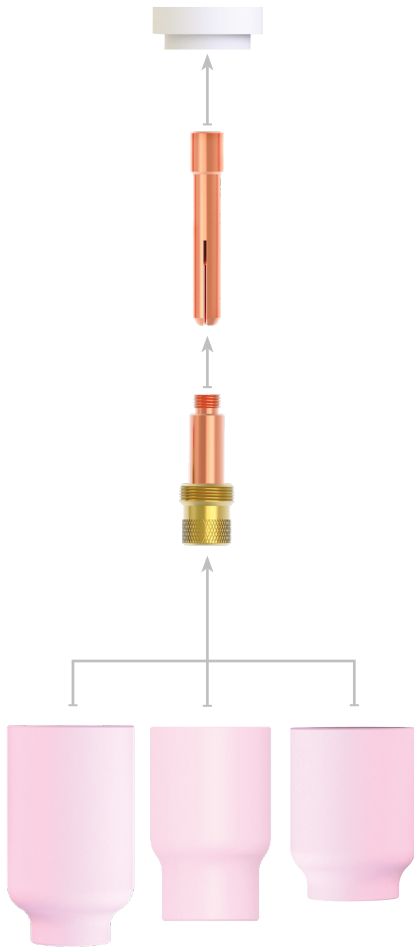

Insulator

P54N01	GAS LENS INSULATOR SUIT 17/18/26 QTY 2
---------------	--

Collet

P10N22	COLLET SUIT 17/18/26 1.0MM QTY 2
P10N23	COLLET SUIT 17/18/26 1.6MM QTY 2
P10N24	COLLET SUIT 17/18/26 2.4MM QTY 2
P10N25	COLLET SUIT 17/18/26 3.2MM QTY 2

Gas Lens

P45V25	GAS LENS SUIT 17/18/26 1.6MM QTY2
P45V26	GAS LENS SUIT 17/18/26 2.4MM QTY2
P45V27	GAS LENS SUIT 17/18/26 3.2MM QTY2

Ceramic Cup

P54N17	GAS LENS CERAMIC CUP SUIT 17/18/26 SIZE 5 QTY 2
P54N15	GAS LENS CERAMIC CUP SUIT 17/18/26 SIZE 7 QTY 2
P54N14	GAS LENS CERAMIC CUP SUIT 17/18/26 SIZE 8 QTY 2

Short Ceramic Cup

P54N15SW	GAS LENS CERAMIC CUP SHORT SUIT 17/18/26 SIZE 7 QTY 2
P54N14SW	GAS LENS CERAMIC CUP SHORT SUIT 17/18/26 SIZE 8 QTY 2
P54N12SW	GAS LENS CERAMIC CUP SHORT SUIT 17/18/26 SIZE 10 QTY 2

Stubby Ceramic Cup

P53N58	GAS LENS CERAMIC CUP SUIT 9/17/18/20/26 SIZE 4 QTY 2
P53N59	GAS LENS CERAMIC CUP SUIT 9/17/18/20/26 SIZE 5 QTY 2
P53N60	GAS LENS CERAMIC CUP SUIT 9/17/18/20/26 SIZE 6 QTY 2
P53N61	GAS LENS CERAMIC CUP SUIT 9/17/18/20/26 SIZE 7 QTY 2
P53N61S	GAS LENS CERAMIC CUP SUIT 9/17/18/20/26 SIZE 8 QTY 2

2.14.3 APEX

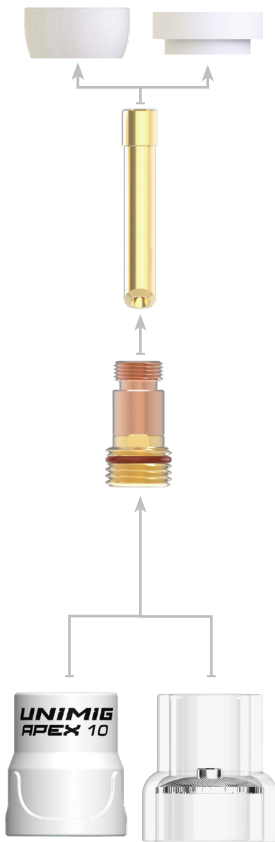

Insulator

USTB80300236	INSULATOR QUARTZ SUIT 17/18/26 QTY 2
P18CG	INSULATOR CERAMIC SUIT 17/18/26 QTY 2

Wedge Collet

U11166	WEDGE COLLET SUIT 17/18/26 1.6MM QTY 2
U11167	WEDGE COLLET SUIT 17/18/26 2.4MM QTY 2
U11168	WEDGE COLLET SUIT 17/18/26 3.2MM QTY 2

Stubby Gas Lens

U11187	GAS LENS BODY STUBBY WITH O RING SUIT 17/18/26 1.6MM QTY 2
U11188	GAS LENS BODY STUBBY WITH O RING SUIT 17/18/26 2.4MM QTY 2
U11189	GAS LENS BODY STUBBY WITH O RING SUIT 17/18/26 3.2MM QTY 2
U42029	SILICONE RUBBER O-RING SUIT APEX QTY 5

Ceramic Cup

U42020	CERAMIC CUP APEX10 SUIT 9/17/18/20/26 SIZE 10 QTY 1
U42021	CERAMIC CUP APEX12 SUIT 9/17/18/20/26 SIZE 12 QTY 1
U42022	CERAMIC CUP APEX14 SUIT 9/17/18/20/26 SIZE 14 QTY 1
U42023	CERAMIC CUP APEX19 SUIT 9/17/18/20/26 SIZE 19 QTY 1
U11017	FILTER SCREEN KIT APEX10 1.6MM, 2.4MM, 3.2MM QTY 1
U11018	FILTER SCREEN KIT APEX12 1.6MM, 2.4MM, 3.2MM QTY 1
U11019	FILTER SCREEN KIT APEX14 1.6MM, 2.4MM, 3.2MM QTY 1
U11020	FILTER SCREEN KIT APEX19 1.6MM, 2.4MM, 3.2MM QTY 1

Quartz Cup

U42024	QUARTZ CUP APEX12 SUIT 9/17/18/20/26 SIZE 12 QTY 1
U42025	QUARTZ CUP APEX19 SUIT 9/17/18/20/26 SIZE 19 QTY 1

2.14.4 Stubby

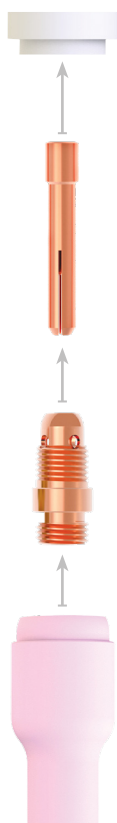

Insulator

USTB80300236	STUBBY GAS LENS INSULATOR SUIT 17/18/26 QTY 2
---------------------	---

Collet

P10N22S	COLLET STUBBY SUIT 17/18/26 1.0MM QTY 2
P10N23S	COLLET STUBBY SUIT 17/18/26 1.6MM QTY 2
P10N24S	COLLET STUBBY SUIT 17/18/26 2.4MM QTY 2
P10N25S	COLLET STUBBY SUIT 17/18/26 3.2MM QTY 2

Collet Body

P17CB20	COLLET BODY STUBBY SUIT 17/18/26 QTY 2
----------------	--

Ceramic Cup

P13N08	CERAMIC CUP SUIT 9/20 SIZE 4 QTY 2
P13N09	CERAMIC CUP SUIT 9/20 SIZE 5 QTY 2
P13N10	CERAMIC CUP SUIT 9/20 SIZE 6 QTY 2
P13N11	CERAMIC CUP SUIT 9/20 SIZE 7 QTY 2
P13N12	CERAMIC CUP SUIT 9/20 SIZE 8 QTY 2
P13N13	CERAMIC CUP SUIT 9/20 SIZE 10 QTY 2

2.14.5 Stubby Gas Lens

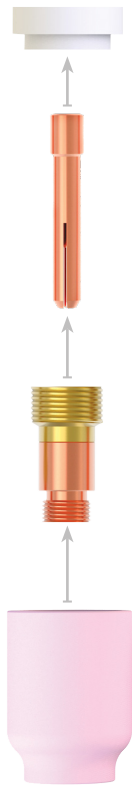

Insulator

USTB80300236	STUBBY GAS LENS INSULATOR SUIT 17/18/26 QTY 2
---------------------	---

Collet

PSTB13N21	GAS LENS COLLET STUBBY SUIT 17/18/26 1.0MM QTY 2
PSTB13N22	GAS LENS COLLET STUBBY SUIT 17/18/26 1.6MM QTY 2
PSTB13N23	GAS LENS COLLET STUBBY SUIT 17/18/26 2.4MM QTY 2

Collet Body

PSTB45V43	GAS LENS BODY STUBBY SUIT 17/18/26 1.6MM QTY 2
PSTB45V44	GAS LENS BODY STUBBY SUIT 17/18/26 2.4MM QTY 2
PSTB45V45	GAS LENS BODY STUBBY SUIT 17/18/26 3.2MM QTY 2

Ceramic Cup

P53N58	GAS LENS CERAMIC CUP SUIT 9/17/18/20/26 SIZE 4 QTY 2
P53N59	GAS LENS CERAMIC CUP SUIT 9/17/18/20/26 SIZE 5 QTY 2
P53N60	GAS LENS CERAMIC CUP SUIT 9/17/18/20/26 SIZE 6 QTY 2
P53N61	GAS LENS CERAMIC CUP SUIT 9/17/18/20/26 SIZE 7 QTY 2
P53N61S	GAS LENS CERAMIC CUP SUIT 9/17/18/20/26 SIZE 8 QTY 2

UNIMIG



100%
AUSTRALIAN
OWNED

unimig.com.au

f @ UNIMIG