

# T4W Water-Cooled TIG Torch

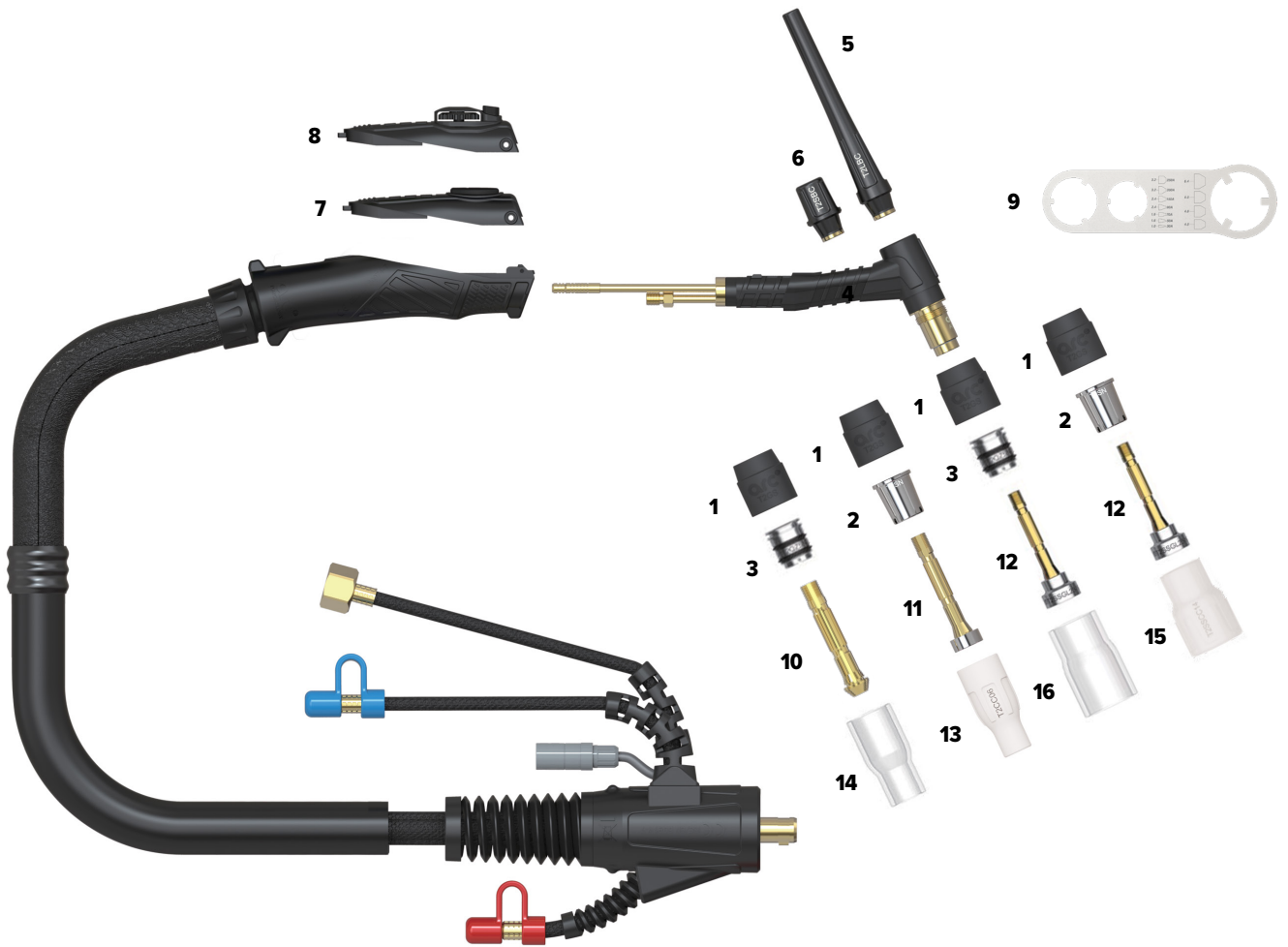

Length	4m	8m
SKU	U11209	U11210

1	UMCT2HG	HEAD GASKET SUIT T2/T3W/T4W QTY 1
2	UMCT2SN	HEAT ZONE ISOLATOR SUIT T2/T3W/T4W QTY 1
3	UMCT2QZSN	QUARTZ ZONE ISOLATOR SUIT T2/T3W/T4W QTY 1
4	UMCT3WTHF	TORCH HEAD FLEXIBLE SUIT T3W/T4W
4	UMCT2TH	TORCH HEAD SUIT T2
5	UMCT2LBC	LONG BACK CAP SUIT T2/T3W/T4W QTY 1
6	UMCT2SBC	SHORT BACK CAP SUIT T2/T3W/T4W QTY 1
7	UMCTMS	TIG TORCH SWITCH SINGLE BUTTON SUIT T2/T3/T3W/T4W
8	UMCTMK10KP	TIG TORCH SWITCH HORIZONTAL ADJUSTMENT 10K POT SUIT T2/T3/T3W/T4W
9	UMCTSPAN	SPANNER SUIT T2/T3/T3W/T4W
10	See page 174	COLLET BODY
11	See page 174	GAS LENS COLLET BODY
12	See page 174	SUPER GAS LENS COLLET BODY
13	See page 174	CERAMIC CUP

14	See page 174	QUARTZ CUP
15	See page 174	SUPER CERAMIC CUP
16	See page 174	SUPER QUARTZ CUP

COOLING METHOD	Water-Cooled
DUTY CYCLE - DC	100% @ 450A
DUTY CYCLE - AC	100% @ 315A
DINSE SIZE	35/50
ELECTRODE SIZE	1.0-4.0mm
STANDARD	EN60974-7
MINIMUM WATER FLOW	1.5L/min
MINIMUM WATER INLET PRESSURE	3.0 Bar
MAXIMUM WATER INLET PRESSURE	5.0 Bar
MAXIMUM WATER INLET TEMPERATURE	50°C
MINIMUM COOLING POWER	1600W

# T2/T3W/T4W TIG Torch Consumables

## Standard

## Quartz

**Head Gasket**

UMCT2HG	HEAD GASKET SUIT T2/T3W/T4W QTY 1
---------	-----------------------------------

**Heat Zone Isolator**

UMCT2SN	HEAT ZONE ISOLATOR SUIT T2/T3W/T4W QTY 1
---------	--

**Collet Body**

UMCT2CB10	COLLET BODY SUIT T2/T3W/T4W 1.0MM QTY 1
UMCT2CB16	COLLET BODY SUIT T2/T3W/T4W 1.6MM QTY 1
UMCT2CB24	COLLET BODY SUIT T2/T3W/T4W 2.4MM QTY 1
UMCT2CB32	COLLET BODY SUIT T2/T3W/T4W 3.2MM QTY 1
UMCT2GL10	GAS LENS COLLET BODY SUIT T2/T3W/T4W 1.0MM QTY 1
UMCT2GL16	GAS LENS COLLET BODY SUIT T2/T3W/T4W 1.6MM QTY 1
UMCT2GL24	GAS LENS COLLET BODY SUIT T2/T3W/T4W 2.4MM QTY 1
UMCT2GL32	GAS LENS COLLET BODY SUIT T2/T3W/T4W 3.2MM QTY 1

**Ceramic Cup**

UMCT2C04	CERAMIC CUP SUIT T2/T3W/T4W SIZE 4 6MM QTY 1
UMCT2C05	CERAMIC CUP SUIT T2/T3W/T4W SIZE 5 8MM QTY 1
UMCT2C06	CERAMIC CUP SUIT T2/T3W/T4W SIZE 6 10MM QTY 1
UMCT2C07	CERAMIC CUP SUIT T2/T3W/T4W SIZE 7 11MM QTY 1
UMCT2C08	CERAMIC CUP SUIT T2/T3W/T4W SIZE 8 12.5MM QTY 1
UMCT2C10	CERAMIC CUP SUIT T2/T3W/T4W SIZE 10 16MM QTY 1

**Head Gasket**

UMCT2HG	HEAD GASKET SUIT T2/T3W/T4W QTY 1
---------	-----------------------------------

**Heat Zone Isolator**

UMCT2QZSN	QUARTZ ZONE ISOLATOR SUIT T2/T3W/T4W QTY 1
-----------	--

**Collet Body**

UMCT2CB10	COLLET BODY SUIT T2/T3W/T4W 1.0MM QTY 1
UMCT2CB16	COLLET BODY SUIT T2/T3W/T4W 1.6MM QTY 1
UMCT2CB24	COLLET BODY SUIT T2/T3W/T4W 2.4MM QTY 1
UMCT2CB32	COLLET BODY SUIT T2/T3W/T4W 3.2MM QTY 1
UMCT2GL10	GAS LENS COLLET BODY SUIT T2/T3W/T4W 1.0MM QTY 1
UMCT2GL16	GAS LENS COLLET BODY SUIT T2/T3W/T4W 1.6MM QTY 1
UMCT2GL24	GAS LENS COLLET BODY SUIT T2/T3W/T4W 2.4MM QTY 1
UMCT2GL32	GAS LENS COLLET BODY SUIT T2/T3W/T4W 3.2MM QTY 1

**Quartz Cup**

UMCT2QZ06	QUARTZ CUP SUIT T2/T3W/T4W SIZE 6 QTY 1
UMCT2QZ08	QUARTZ CUP SUIT T2/T3W/T4W SIZE 8 QTY 1
UMCT2QZ10	QUARTZ CUP SUIT T2/T3W/T4W SIZE 9 QTY 1

# T3 TIG Torch Consumables

**Head Gasket**

UMCT3HG	HEAD GASKET SUIT T3 QTY 1
---------	---------------------------

**Heat Zone Isolator**

UMCT3SN	HEAT ZONE ISOLATOR SUIT T3 QTY 1
---------	----------------------------------

**Collet Body**

UMCT3CB16	COLLET BODY SUIT T3 1.6MM QTY 1
UMCT3CB24	COLLET BODY SUIT T3 2.4MM QTY 1
UMCT3CB32	COLLET BODY SUIT T3 3.2MM QTY 1
UMCT3GL16	GAS LENS COLLET BODY SUIT T3 1.6MM QTY 1
UMCT3GL24	GAS LENS COLLET BODY SUIT T3 2.4MM QTY 1
UMCT3GL32	GAS LENS COLLET BODY SUIT T3 3.2MM QTY 1

**Ceramic Cup**

UMCT3C04	CERAMIC CUP SUIT T3 SIZE 4 6MM QTY 1
UMCT3C05	CERAMIC CUP SUIT T3 SIZE 5 8MM QTY 1
UMCT3C06	CERAMIC CUP SUIT T3 SIZE 6 10MM QTY 1
UMCT3C07	CERAMIC CUP SUIT T3 SIZE 7 11MM QTY 1
UMCT3C08	CERAMIC CUP SUIT T3 SIZE 8 12.5MM QTY 1
UMCT3C10	CERAMIC CUP SUIT T3 SIZE 10 16MM QTY 1

# T2/T3W/T4W TIG Torch Consumables

## SUPER Series

## SUPER Series Quartz



### Head Gasket

<b>UMCT2HG</b>	HEAD GASKET SUIT T2/T3W/T4W QTY 1
----------------	-----------------------------------



### Head Gasket

<b>UMCT2HG</b>	HEAD GASKET SUIT T2/T3W/T4W QTY 1
----------------	-----------------------------------



### Heat Zone Isolator

<b>UMCT2SN</b>	HEAT ZONE ISOLATOR SUIT T2/T3W/T4W QTY 1
----------------	--



### Heat Zone Isolator

<b>UMCT2QZSN</b>	QUARTZ ZONE ISOLATOR SUIT T2/T3W/T4W QTY 1
------------------	--



### Collet Body

<b>UMCT2SSGL2016</b>	GAS LENS COLLET BODY SUPER12 SUIT T2/T3W/T4W 1.6MM QTY 1
<b>UMCT2SSGL2024</b>	GAS LENS COLLET BODY SUPER12 SUIT T2/T3W/T4W 2.4MM QTY 1
<b>UMCT2SSGL2032</b>	GAS LENS COLLET BODY SUPER12 SUIT T2/T3W/T4W 3.2MM QTY 1
<b>UMCT2SSGL2316</b>	GAS LENS COLLET BODY SUPER14 SUIT T2/T3W/T4W 1.6MM QTY 1
<b>UMCT2SSGL2324</b>	GAS LENS COLLET BODY SUPER14 SUIT T2/T3W/T4W 2.4MM QTY 1
<b>UMCT2SSGL2332</b>	GAS LENS COLLET BODY SUPER14 SUIT T2/T3W/T4W 3.2MM QTY 1
<b>UMCT2SSGL2816</b>	GAS LENS COLLET BODY SUPER18 SUIT T2/T3W/T4W 1.6MM QTY 1
<b>UMCT2SSGL2824</b>	GAS LENS COLLET BODY SUPER18 SUIT T2/T3W/T4W 2.4MM QTY 1
<b>UMCT2SSGL2832</b>	GAS LENS COLLET BODY SUPER18 SUIT T2/T3W/T4W 3.2MM QTY 1



### Collet Body

<b>UMCT2SSGL2016</b>	GAS LENS COLLET BODY SUPER12 SUIT T2/T3W/T4W 1.6MM QTY 1
<b>UMCT2SSGL2024</b>	GAS LENS COLLET BODY SUPER12 SUIT T2/T3W/T4W 2.4MM QTY 1
<b>UMCT2SSGL2032</b>	GAS LENS COLLET BODY SUPER12 SUIT T2/T3W/T4W 3.2MM QTY 1
<b>UMCT2SSGL2316</b>	GAS LENS COLLET BODY SUPER14 SUIT T2/T3W/T4W 1.6MM QTY 1
<b>UMCT2SSGL2324</b>	GAS LENS COLLET BODY SUPER14 SUIT T2/T3W/T4W 2.4MM QTY 1
<b>UMCT2SSGL2332</b>	GAS LENS COLLET BODY SUPER14 SUIT T2/T3W/T4W 3.2MM QTY 1
<b>UMCT2SSGL2816</b>	GAS LENS COLLET BODY SUPER18 SUIT T2/T3W/T4W 1.6MM QTY 1
<b>UMCT2SSGL2824</b>	GAS LENS COLLET BODY SUPER18 SUIT T2/T3W/T4W 2.4MM QTY 1
<b>UMCT2SSGL2832</b>	GAS LENS COLLET BODY SUPER18 SUIT T2/T3W/T4W 3.2MM QTY 1



### Ceramic Cup

<b>UMCT2SSCC12</b>	CERAMIC CUP SUPER12 SUIT T2/T3W/T4W SIZE 12 QTY 1
<b>UMCT2SSCC14</b>	CERAMIC CUP SUPER14 SUIT T2/T3W/T4W SIZE 14 QTY 1
<b>UMCT2SSCC18</b>	CERAMIC CUP SUPER18 SUIT T2/T3W/T4W SIZE 18 QTY 1



### Quartz Cup

<b>UMCT2SSQZ12</b>	QUARTZ CUP SUPER12 SUIT T2/T3W/T4W SIZE 12 QTY 1
<b>UMCT2SSQZ14</b>	QUARTZ CUP SUPER14 SUIT T2/T3W/T4W SIZE 14 QTY 1
<b>UMCT2SSQZ18</b>	QUARTZ CUP SUPER18 SUIT T2/T3W/T4W SIZE 18 QTY 1