

## T2 TIG Torch

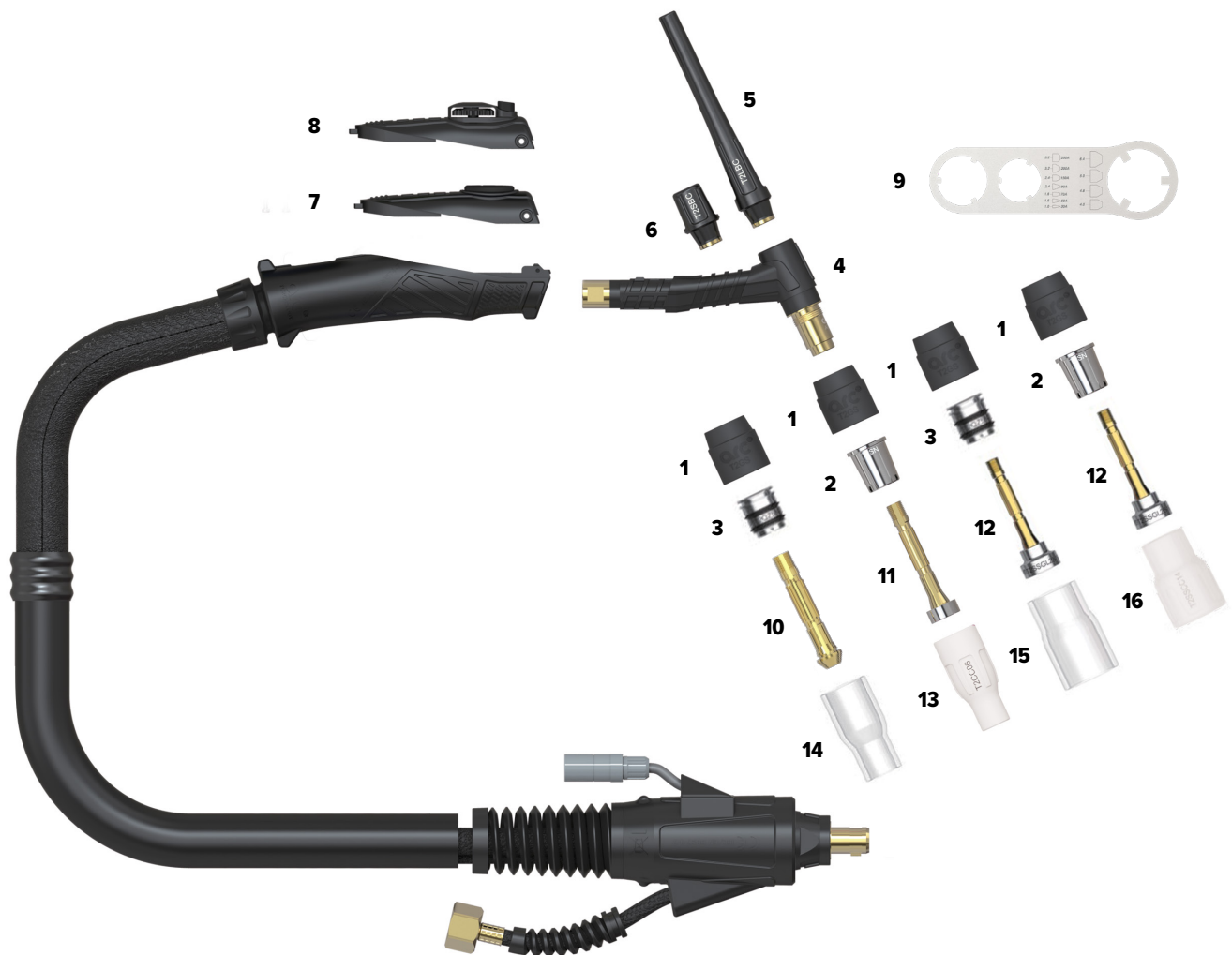

| Length | Dinse 4m | Dinse 8m | Euro 4m |
|--------|----------|----------|---------|
| SKU    | UMT2F4M  | UMT2F8M  | UMT24ME |

|    |              |   |
|----|--------------|---|
| 1  | UMCT2HG      | HEAD GASKET SUIT T2/T3W/T4W QTY 1                                 |
| 2  | UMCT2SN      | HEAT ZONE ISOLATOR SUIT T2/T3W/T4W QTY 1                          |
| 3  | UMCT2QZSN    | QUARTZ ZONE ISOLATOR SUIT T2/T3W/T4W QTY 1                        |
| 4  | UMCT2THF     | TORCH HEAD FLEXIBLE SUIT T2                                       |
| 4  | UMCT2TH      | TORCH HEAD SUIT T2  |
| 5  | UMCT2LBC     | LONG BACK CAP SUIT T2/T3W/T4W QTY 1                               |
| 6  | UMCT2SBC     | SHORT BACK CAP SUIT T2/T3W/T4W QTY 1                              |
| 7  | UMCTMS       | TIG TORCH SWITCH SINGLE BUTTON SUIT T2/T3/T3W/T4W                 |
| 8  | UMCTMK10KP   | TIG TORCH SWITCH HORIZONTAL ADJUSTMENT 10K POT SUIT T2/T3/T3W/T4W |
| 9  | UMCTSPAN     | SPANNER SUIT T2/T3/T3W/T4W  |
| 10 | See page 174 | COLLET BODY   |
| 11 | See page 174 | GAS LENS COLLET BODY  |

|    |              |                            |
|----|--------------|----------------------------|
| 12 | See page 174 | SUPER GAS LENS COLLET BODY |
| 13 | See page 174 | CERAMIC CUP                |
| 14 | See page 174 | QUARTZ CUP                 |
| 15 | See page 174 | SUPER CERAMIC CUP          |
| 16 | See page 174 | SUPER QUARTZ CUP           |

|                        |            |
|------------------------|------------|
| COOLING METHOD         | Air-Cooled |
| DUTY CYCLE - CO2       | 35% @ 190A |
| DUTY CYCLE - MIXED GAS | 35% @ 135A |
| DINSE SIZE             | 35/50      |
| ELECTRODE SIZE         | 1.0-4.0mm  |
| STANDARD               | EN60974-7  |

# T2/T3W/T4W TIG Torch Consumables

## Standard

## Quartz

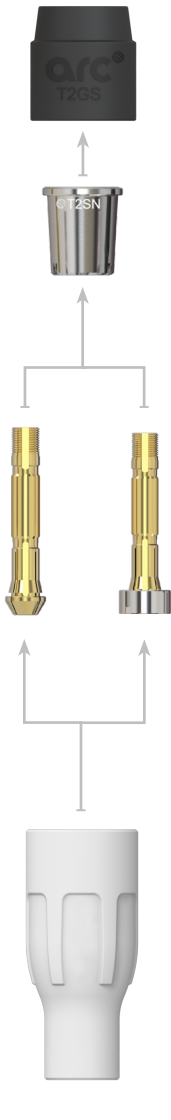

**Head Gasket**

|                |                                   |
|----------------|-----------------------------------|
| <b>UMCT2HG</b> | HEAD GASKET SUIT T2/T3W/T4W QTY 1 |
|----------------|-----------------------------------|

**Heat Zone Isolator**

|                |  |
|----------------|--|
| <b>UMCT2SN</b> | HEAT ZONE ISOLATOR SUIT T2/T3W/T4W QTY 1 |
|----------------|--|

**Collet Body**

|                  |  |
|------------------|--|
| <b>UMCT2CB10</b> | COLLET BODY SUIT T2/T3W/T4W 1.0MM QTY 1          |
| <b>UMCT2CB16</b> | COLLET BODY SUIT T2/T3W/T4W 1.6MM QTY 1          |
| <b>UMCT2CB24</b> | COLLET BODY SUIT T2/T3W/T4W 2.4MM QTY 1          |
| <b>UMCT2CB32</b> | COLLET BODY SUIT T2/T3W/T4W 3.2MM QTY 1          |
| <b>UMCT2GL10</b> | GAS LENS COLLET BODY SUIT T2/T3W/T4W 1.0MM QTY 1 |
| <b>UMCT2GL16</b> | GAS LENS COLLET BODY SUIT T2/T3W/T4W 1.6MM QTY 1 |
| <b>UMCT2GL24</b> | GAS LENS COLLET BODY SUIT T2/T3W/T4W 2.4MM QTY 1 |
| <b>UMCT2GL32</b> | GAS LENS COLLET BODY SUIT T2/T3W/T4W 3.2MM QTY 1 |

**Ceramic Cup**

|                 |   |
|-----------------|---|
| <b>UMCT2C04</b> | CERAMIC CUP SUIT T2/T3W/T4W SIZE 4 6MM QTY 1    |
| <b>UMCT2C05</b> | CERAMIC CUP SUIT T2/T3W/T4W SIZE 5 8MM QTY 1    |
| <b>UMCT2C06</b> | CERAMIC CUP SUIT T2/T3W/T4W SIZE 6 10MM QTY 1   |
| <b>UMCT2C07</b> | CERAMIC CUP SUIT T2/T3W/T4W SIZE 7 11MM QTY 1   |
| <b>UMCT2C08</b> | CERAMIC CUP SUIT T2/T3W/T4W SIZE 8 12.5MM QTY 1 |
| <b>UMCT2C10</b> | CERAMIC CUP SUIT T2/T3W/T4W SIZE 10 16MM QTY 1  |



**Head Gasket**

|                |                                   |
|----------------|-----------------------------------|
| <b>UMCT2HG</b> | HEAD GASKET SUIT T2/T3W/T4W QTY 1 |
|----------------|-----------------------------------|

**Heat Zone Isolator**

|                  |  |
|------------------|--|
| <b>UMCT2QZSN</b> | QUARTZ ZONE ISOLATOR SUIT T2/T3W/T4W QTY 1 |
|------------------|--|

**Collet Body**

|                  |  |
|------------------|--|
| <b>UMCT2CB10</b> | COLLET BODY SUIT T2/T3W/T4W 1.0MM QTY 1          |
| <b>UMCT2CB16</b> | COLLET BODY SUIT T2/T3W/T4W 1.6MM QTY 1          |
| <b>UMCT2CB24</b> | COLLET BODY SUIT T2/T3W/T4W 2.4MM QTY 1          |
| <b>UMCT2CB32</b> | COLLET BODY SUIT T2/T3W/T4W 3.2MM QTY 1          |
| <b>UMCT2GL10</b> | GAS LENS COLLET BODY SUIT T2/T3W/T4W 1.0MM QTY 1 |
| <b>UMCT2GL16</b> | GAS LENS COLLET BODY SUIT T2/T3W/T4W 1.6MM QTY 1 |
| <b>UMCT2GL24</b> | GAS LENS COLLET BODY SUIT T2/T3W/T4W 2.4MM QTY 1 |
| <b>UMCT2GL32</b> | GAS LENS COLLET BODY SUIT T2/T3W/T4W 3.2MM QTY 1 |

**Quartz Cup**

|                  |   |
|------------------|---|
| <b>UMCT2QZ06</b> | QUARTZ CUP SUIT T2/T3W/T4W SIZE 6 QTY 1 |
| <b>UMCT2QZ08</b> | QUARTZ CUP SUIT T2/T3W/T4W SIZE 8 QTY 1 |
| <b>UMCT2QZ10</b> | QUARTZ CUP SUIT T2/T3W/T4W SIZE 9 QTY 1 |

# T3 TIG Torch Consumables

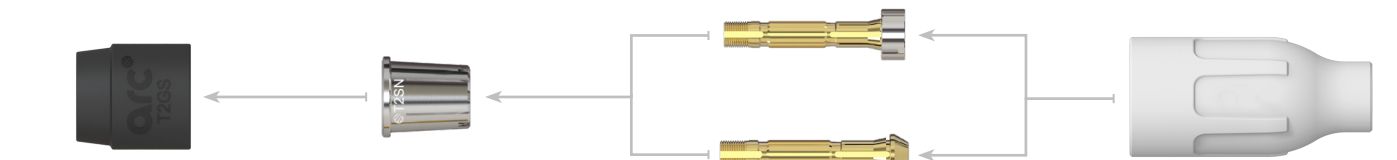

**Head Gasket**

|                |                           |
|----------------|---------------------------|
| <b>UMCT3HG</b> | HEAD GASKET SUIT T3 QTY 1 |
|----------------|---------------------------|

**Heat Zone Isolator**

|                |                                  |
|----------------|----------------------------------|
| <b>UMCT3SN</b> | HEAT ZONE ISOLATOR SUIT T3 QTY 1 |
|----------------|----------------------------------|

**Collet Body**

|                  |  |
|------------------|--|
| <b>UMCT3CB16</b> | COLLET BODY SUIT T3 1.6MM QTY 1          |
| <b>UMCT3CB24</b> | COLLET BODY SUIT T3 2.4MM QTY 1          |
| <b>UMCT3CB32</b> | COLLET BODY SUIT T3 3.2MM QTY 1          |
| <b>UMCT3GL16</b> | GAS LENS COLLET BODY SUIT T3 1.6MM QTY 1 |
| <b>UMCT3GL24</b> | GAS LENS COLLET BODY SUIT T3 2.4MM QTY 1 |
| <b>UMCT3GL32</b> | GAS LENS COLLET BODY SUIT T3 3.2MM QTY 1 |

**Ceramic Cup**

|                 |   |
|-----------------|---|
| <b>UMCT3C04</b> | CERAMIC CUP SUIT T3 SIZE 4 6MM QTY 1    |
| <b>UMCT3C05</b> | CERAMIC CUP SUIT T3 SIZE 5 8MM QTY 1    |
| <b>UMCT3C06</b> | CERAMIC CUP SUIT T3 SIZE 6 10MM QTY 1   |
| <b>UMCT3C07</b> | CERAMIC CUP SUIT T3 SIZE 7 11MM QTY 1   |
| <b>UMCT3C08</b> | CERAMIC CUP SUIT T3 SIZE 8 12.5MM QTY 1 |
| <b>UMCT3C10</b> | CERAMIC CUP SUIT T3 SIZE 10 16MM QTY 1  |

# T2/T3W/T4W TIG Torch Consumables

## SUPER Series

## SUPER Series Quartz



### Head Gasket

|                |                                   |
|----------------|-----------------------------------|
| <b>UMCT2HG</b> | HEAD GASKET SUIT T2/T3W/T4W QTY 1 |
|----------------|-----------------------------------|



### Head Gasket

|                |                                   |
|----------------|-----------------------------------|
| <b>UMCT2HG</b> | HEAD GASKET SUIT T2/T3W/T4W QTY 1 |
|----------------|-----------------------------------|



### Heat Zone Isolator

|                |  |
|----------------|--|
| <b>UMCT2SN</b> | HEAT ZONE ISOLATOR SUIT T2/T3W/T4W QTY 1 |
|----------------|--|



### Heat Zone Isolator

|                  |  |
|------------------|--|
| <b>UMCT2QZSN</b> | QUARTZ ZONE ISOLATOR SUIT T2/T3W/T4W QTY 1 |
|------------------|--|



### Collet Body

|                      |  |
|----------------------|--|
| <b>UMCT2SSGL2016</b> | GAS LENS COLLET BODY SUPER12 SUIT T2/T3W/T4W 1.6MM QTY 1 |
| <b>UMCT2SSGL2024</b> | GAS LENS COLLET BODY SUPER12 SUIT T2/T3W/T4W 2.4MM QTY 1 |
| <b>UMCT2SSGL2032</b> | GAS LENS COLLET BODY SUPER12 SUIT T2/T3W/T4W 3.2MM QTY 1 |
| <b>UMCT2SSGL2316</b> | GAS LENS COLLET BODY SUPER14 SUIT T2/T3W/T4W 1.6MM QTY 1 |
| <b>UMCT2SSGL2324</b> | GAS LENS COLLET BODY SUPER14 SUIT T2/T3W/T4W 2.4MM QTY 1 |
| <b>UMCT2SSGL2332</b> | GAS LENS COLLET BODY SUPER14 SUIT T2/T3W/T4W 3.2MM QTY 1 |
| <b>UMCT2SSGL2816</b> | GAS LENS COLLET BODY SUPER18 SUIT T2/T3W/T4W 1.6MM QTY 1 |
| <b>UMCT2SSGL2824</b> | GAS LENS COLLET BODY SUPER18 SUIT T2/T3W/T4W 2.4MM QTY 1 |
| <b>UMCT2SSGL2832</b> | GAS LENS COLLET BODY SUPER18 SUIT T2/T3W/T4W 3.2MM QTY 1 |



### Collet Body

|                      |  |
|----------------------|--|
| <b>UMCT2SSGL2016</b> | GAS LENS COLLET BODY SUPER12 SUIT T2/T3W/T4W 1.6MM QTY 1 |
| <b>UMCT2SSGL2024</b> | GAS LENS COLLET BODY SUPER12 SUIT T2/T3W/T4W 2.4MM QTY 1 |
| <b>UMCT2SSGL2032</b> | GAS LENS COLLET BODY SUPER12 SUIT T2/T3W/T4W 3.2MM QTY 1 |
| <b>UMCT2SSGL2316</b> | GAS LENS COLLET BODY SUPER14 SUIT T2/T3W/T4W 1.6MM QTY 1 |
| <b>UMCT2SSGL2324</b> | GAS LENS COLLET BODY SUPER14 SUIT T2/T3W/T4W 2.4MM QTY 1 |
| <b>UMCT2SSGL2332</b> | GAS LENS COLLET BODY SUPER14 SUIT T2/T3W/T4W 3.2MM QTY 1 |
| <b>UMCT2SSGL2816</b> | GAS LENS COLLET BODY SUPER18 SUIT T2/T3W/T4W 1.6MM QTY 1 |
| <b>UMCT2SSGL2824</b> | GAS LENS COLLET BODY SUPER18 SUIT T2/T3W/T4W 2.4MM QTY 1 |
| <b>UMCT2SSGL2832</b> | GAS LENS COLLET BODY SUPER18 SUIT T2/T3W/T4W 3.2MM QTY 1 |



### Ceramic Cup

|                    |   |
|--------------------|---|
| <b>UMCT2SSCC12</b> | CERAMIC CUP SUPER12 SUIT T2/T3W/T4W SIZE 12 QTY 1 |
| <b>UMCT2SSCC14</b> | CERAMIC CUP SUPER14 SUIT T2/T3W/T4W SIZE 14 QTY 1 |
| <b>UMCT2SSCC18</b> | CERAMIC CUP SUPER18 SUIT T2/T3W/T4W SIZE 18 QTY 1 |



### Quartz Cup

|                    |  |
|--------------------|--|
| <b>UMCT2SSQZ12</b> | QUARTZ CUP SUPER12 SUIT T2/T3W/T4W SIZE 12 QTY 1 |
| <b>UMCT2SSQZ14</b> | QUARTZ CUP SUPER14 SUIT T2/T3W/T4W SIZE 14 QTY 1 |
| <b>UMCT2SSQZ18</b> | QUARTZ CUP SUPER18 SUIT T2/T3W/T4W SIZE 18 QTY 1 |