

T2 TIG Torch

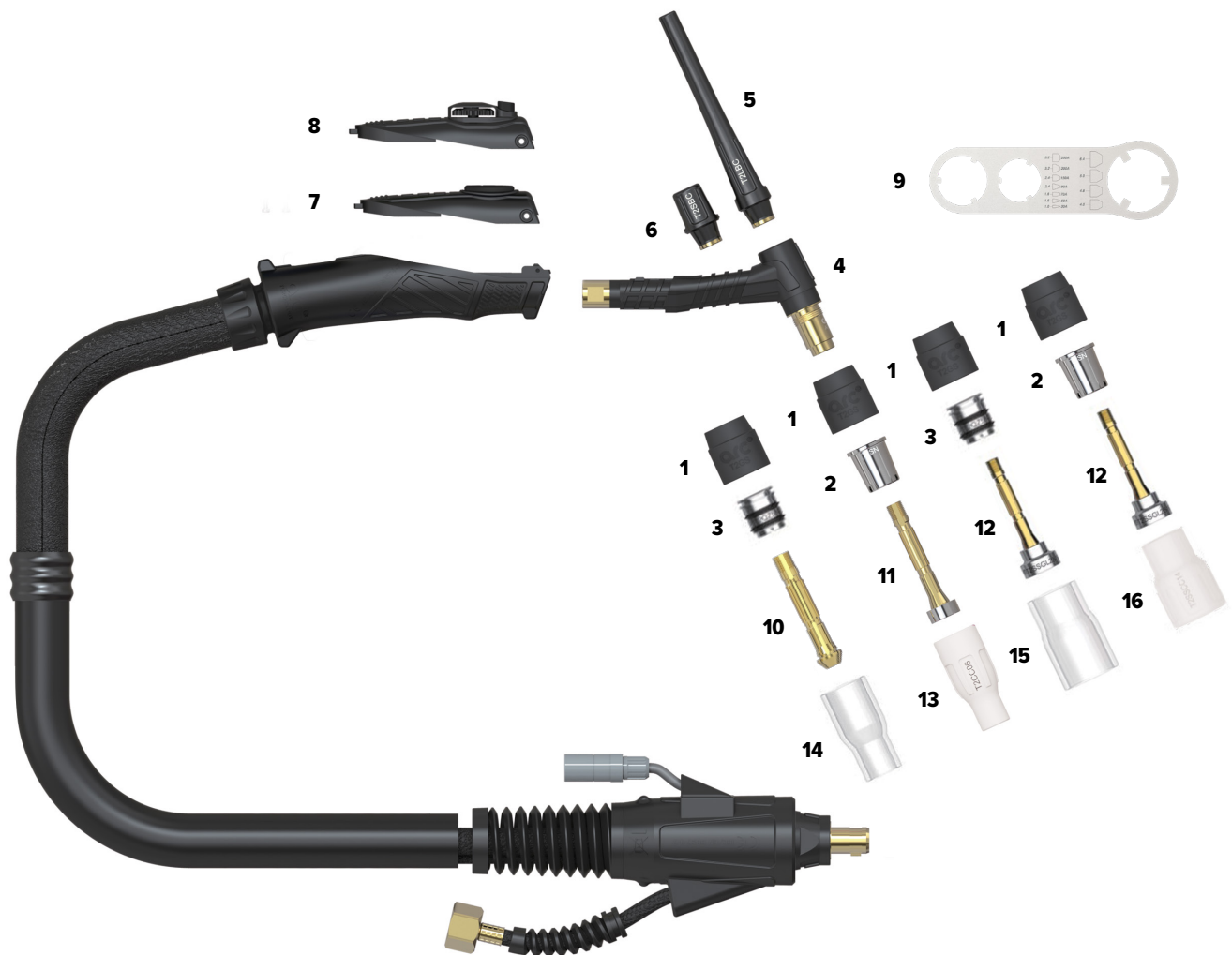

| Length | Dinse 4m | Dinse 8m | Euro 4m |
|--------|----------|----------|---------|
| SKU | UMT2F4M | UMT2F8M | UMT24ME |

| | | |
|----|--------------|-------------------------------------------------------------------|
| 1 | UMCT2HG | HEAD GASKET SUIT T2/T3W/T4W QTY 1 |
| 2 | UMCT2SN | HEAT ZONE ISOLATOR SUIT T2/T3W/T4W QTY 1 |
| 3 | UMCT2QZSN | QUARTZ ZONE ISOLATOR SUIT T2/T3W/T4W QTY 1 |
| 4 | UMCT2THF | TORCH HEAD FLEXIBLE SUIT T2 |
| 4 | UMCT2TH | TORCH HEAD SUIT T2 |
| 5 | UMCT2LBC | LONG BACK CAP SUIT T2/T3W/T4W QTY 1 |
| 6 | UMCT2SBC | SHORT BACK CAP SUIT T2/T3W/T4W QTY 1 |
| 7 | UMCTMS | TIG TORCH SWITCH SINGLE BUTTON SUIT T2/T3/T3W/T4W |
| 8 | UMCTMK10KP | TIG TORCH SWITCH HORIZONTAL ADJUSTMENT 10K POT SUIT T2/T3/T3W/T4W |
| 9 | UMCTSPAN | SPANNER SUIT T2/T3/T3W/T4W |
| 10 | See page 174 | COLLET BODY |
| 11 | See page 174 | GAS LENS COLLET BODY |

| | | |
|----|--------------|----------------------------|
| 12 | See page 174 | SUPER GAS LENS COLLET BODY |
| 13 | See page 174 | CERAMIC CUP |
| 14 | See page 174 | QUARTZ CUP |
| 15 | See page 174 | SUPER CERAMIC CUP |
| 16 | See page 174 | SUPER QUARTZ CUP |

| | |
|------------------------|------------|
| COOLING METHOD | Air-Cooled |
| DUTY CYCLE - CO2 | 35% @ 190A |
| DUTY CYCLE - MIXED GAS | 35% @ 135A |
| DINSE SIZE | 35/50 |
| ELECTRODE SIZE | 1.0-4.0mm |
| STANDARD | EN60974-7 |

T2/T3W/T4W TIG Torch Consumables

Standard

Quartz

Head Gasket

| | |
|---------|-----------------------------------|
| UMCT2HG | HEAD GASKET SUIT T2/T3W/T4W QTY 1 |
|---------|-----------------------------------|

Heat Zone Isolator

| | |
|---------|------------------------------------------|
| UMCT2SN | HEAT ZONE ISOLATOR SUIT T2/T3W/T4W QTY 1 |
|---------|------------------------------------------|

Collet Body

| | |
|-----------|--------------------------------------------------|
| UMCT2CB10 | COLLET BODY SUIT T2/T3W/T4W 1.0MM QTY 1 |
| UMCT2CB16 | COLLET BODY SUIT T2/T3W/T4W 1.6MM QTY 1 |
| UMCT2CB24 | COLLET BODY SUIT T2/T3W/T4W 2.4MM QTY 1 |
| UMCT2CB32 | COLLET BODY SUIT T2/T3W/T4W 3.2MM QTY 1 |
| UMCT2GL10 | GAS LENS COLLET BODY SUIT T2/T3W/T4W 1.0MM QTY 1 |
| UMCT2GL16 | GAS LENS COLLET BODY SUIT T2/T3W/T4W 1.6MM QTY 1 |
| UMCT2GL24 | GAS LENS COLLET BODY SUIT T2/T3W/T4W 2.4MM QTY 1 |
| UMCT2GL32 | GAS LENS COLLET BODY SUIT T2/T3W/T4W 3.2MM QTY 1 |

Ceramic Cup

| | |
|----------|-------------------------------------------------|
| UMCT2C04 | CERAMIC CUP SUIT T2/T3W/T4W SIZE 4 6MM QTY 1 |
| UMCT2C05 | CERAMIC CUP SUIT T2/T3W/T4W SIZE 5 8MM QTY 1 |
| UMCT2C06 | CERAMIC CUP SUIT T2/T3W/T4W SIZE 6 10MM QTY 1 |
| UMCT2C07 | CERAMIC CUP SUIT T2/T3W/T4W SIZE 7 11MM QTY 1 |
| UMCT2C08 | CERAMIC CUP SUIT T2/T3W/T4W SIZE 8 12.5MM QTY 1 |
| UMCT2C10 | CERAMIC CUP SUIT T2/T3W/T4W SIZE 10 16MM QTY 1 |

Head Gasket

| | |
|---------|-----------------------------------|
| UMCT2HG | HEAD GASKET SUIT T2/T3W/T4W QTY 1 |
|---------|-----------------------------------|

Heat Zone Isolator

| | |
|-----------|--------------------------------------------|
| UMCT2QZSN | QUARTZ ZONE ISOLATOR SUIT T2/T3W/T4W QTY 1 |
|-----------|--------------------------------------------|

Collet Body

| | |
|-----------|--------------------------------------------------|
| UMCT2CB10 | COLLET BODY SUIT T2/T3W/T4W 1.0MM QTY 1 |
| UMCT2CB16 | COLLET BODY SUIT T2/T3W/T4W 1.6MM QTY 1 |
| UMCT2CB24 | COLLET BODY SUIT T2/T3W/T4W 2.4MM QTY 1 |
| UMCT2CB32 | COLLET BODY SUIT T2/T3W/T4W 3.2MM QTY 1 |
| UMCT2GL10 | GAS LENS COLLET BODY SUIT T2/T3W/T4W 1.0MM QTY 1 |
| UMCT2GL16 | GAS LENS COLLET BODY SUIT T2/T3W/T4W 1.6MM QTY 1 |
| UMCT2GL24 | GAS LENS COLLET BODY SUIT T2/T3W/T4W 2.4MM QTY 1 |
| UMCT2GL32 | GAS LENS COLLET BODY SUIT T2/T3W/T4W 3.2MM QTY 1 |

Quartz Cup

| | |
|-----------|-----------------------------------------|
| UMCT2QZ06 | QUARTZ CUP SUIT T2/T3W/T4W SIZE 6 QTY 1 |
| UMCT2QZ08 | QUARTZ CUP SUIT T2/T3W/T4W SIZE 8 QTY 1 |
| UMCT2QZ10 | QUARTZ CUP SUIT T2/T3W/T4W SIZE 9 QTY 1 |

T3 TIG Torch Consumables

Head Gasket

| | |
|---------|---------------------------|
| UMCT3HG | HEAD GASKET SUIT T3 QTY 1 |
|---------|---------------------------|

Heat Zone Isolator

| | |
|---------|----------------------------------|
| UMCT3SN | HEAT ZONE ISOLATOR SUIT T3 QTY 1 |
|---------|----------------------------------|

Collet Body

| | |
|-----------|------------------------------------------|
| UMCT3CB16 | COLLET BODY SUIT T3 1.6MM QTY 1 |
| UMCT3CB24 | COLLET BODY SUIT T3 2.4MM QTY 1 |
| UMCT3CB32 | COLLET BODY SUIT T3 3.2MM QTY 1 |
| UMCT3GL16 | GAS LENS COLLET BODY SUIT T3 1.6MM QTY 1 |
| UMCT3GL24 | GAS LENS COLLET BODY SUIT T3 2.4MM QTY 1 |
| UMCT3GL32 | GAS LENS COLLET BODY SUIT T3 3.2MM QTY 1 |

Ceramic Cup

| | |
|----------|-----------------------------------------|
| UMCT3C04 | CERAMIC CUP SUIT T3 SIZE 4 6MM QTY 1 |
| UMCT3C05 | CERAMIC CUP SUIT T3 SIZE 5 8MM QTY 1 |
| UMCT3C06 | CERAMIC CUP SUIT T3 SIZE 6 10MM QTY 1 |
| UMCT3C07 | CERAMIC CUP SUIT T3 SIZE 7 11MM QTY 1 |
| UMCT3C08 | CERAMIC CUP SUIT T3 SIZE 8 12.5MM QTY 1 |
| UMCT3C10 | CERAMIC CUP SUIT T3 SIZE 10 16MM QTY 1 |