

UNIMIG



M-SERIES MIG TORCHES

Contents

1. Installation	3
1.1 M350 MIG Torch.....	3
1.2 M580W MIG Torch.....	5
2. MIG Torch & Consumables	7
2.1 M350 MIG Torch.....	7
2.2 M350 MIG Torch Consumables.....	8
2.3 M580W MIG Torch.....	9
2.4 M580W MIG Torch Consumables.....	10

1. Installation

1.1 M350 MIG Torch

1. Screw in the tip holder into the torch neck, locking the gas diffuser in place. Fasten securely

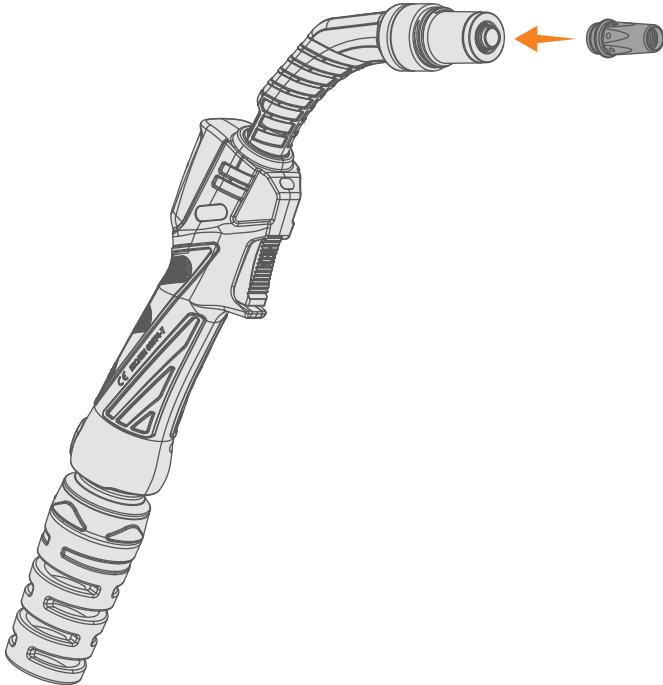

2. Screw the contact tip into the tip holder. Fasten securely.

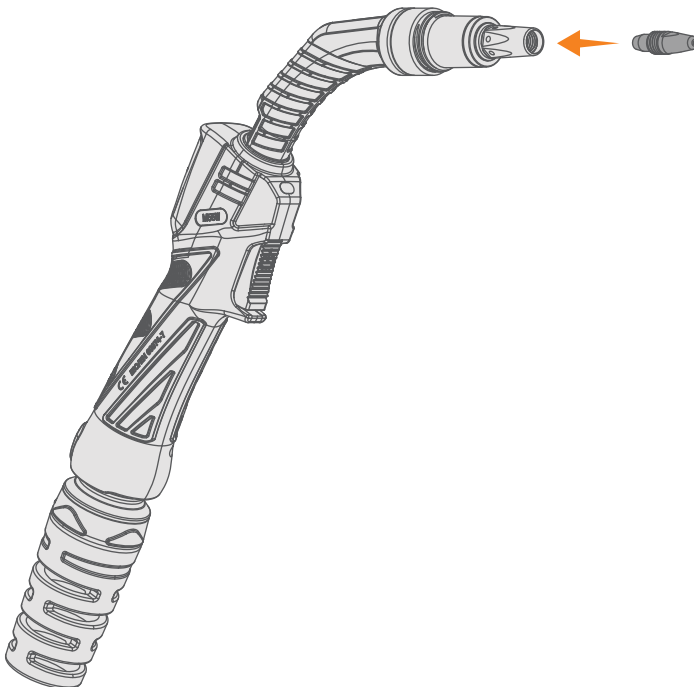

3. Slide on the gas nozzle over the tip holder to complete the torch. Twisting the nozzle can aid in getting the gas nozzle on securely.

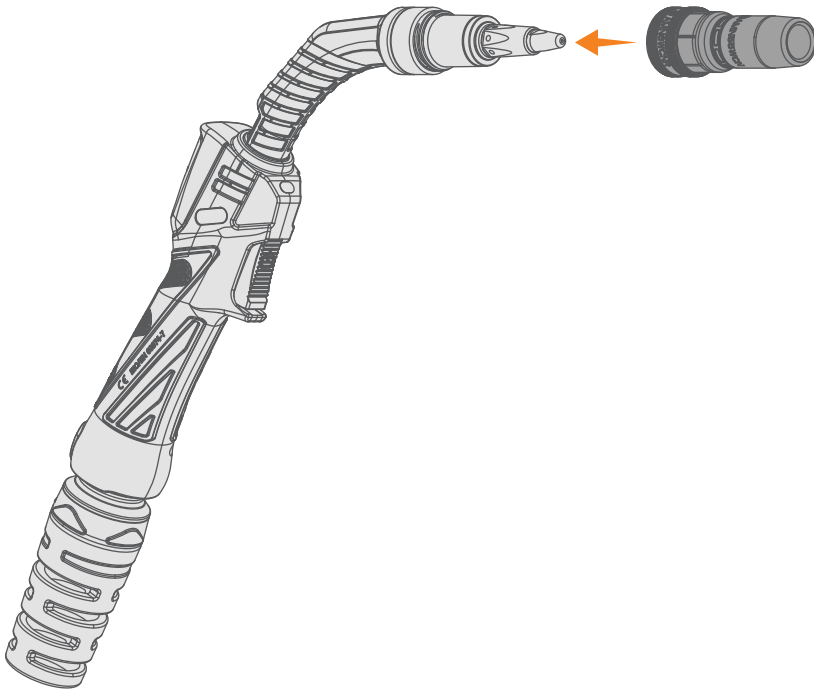

1.2 M580W MIG Torch

1. Place the nozzle insulator onto the torch neck.

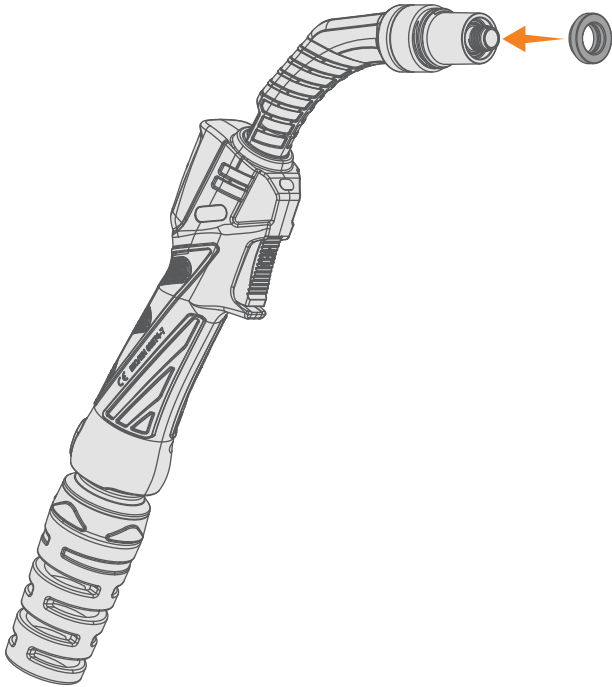

2. Screw in the tip holder into the torch neck, locking the gas diffuser in place. Fasten securely

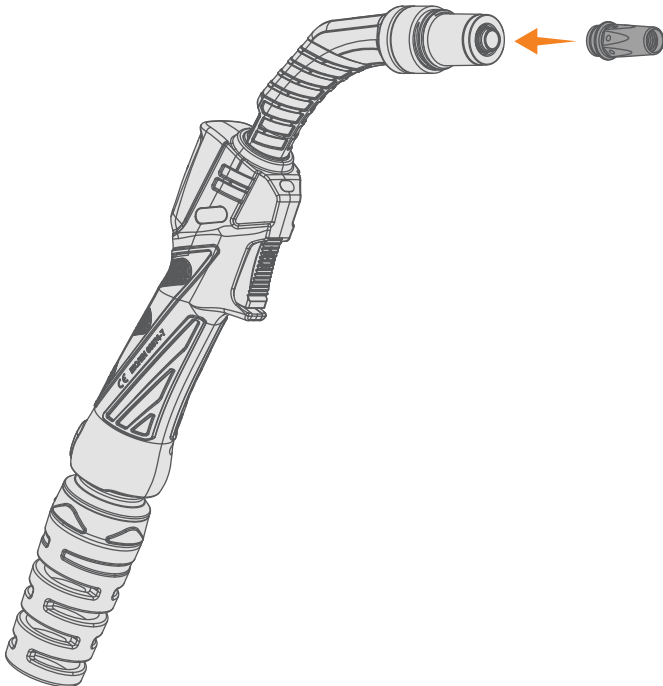

3. Screw the contact tip into the tip holder. Fasten securely.

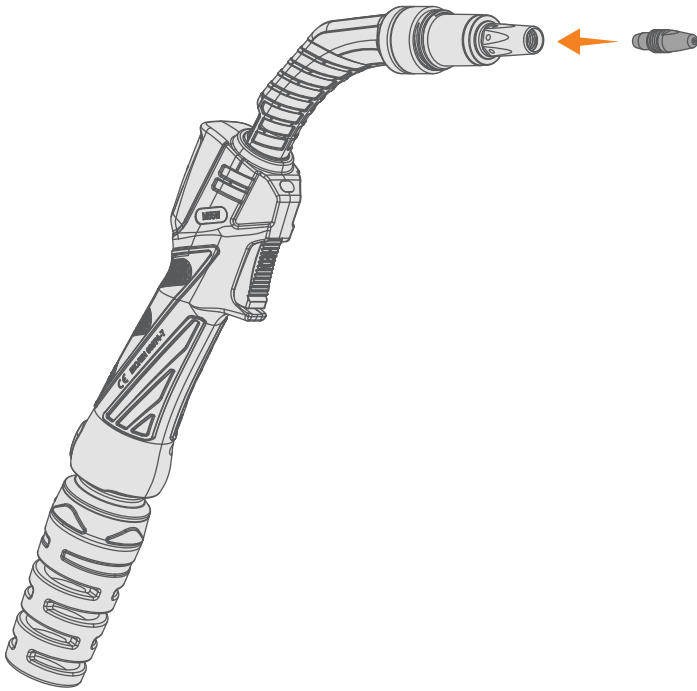

4. Slide on the gas nozzle over the tip holder to complete the torch. Twisting the nozzle can aid in getting the gas nozzle on securely.

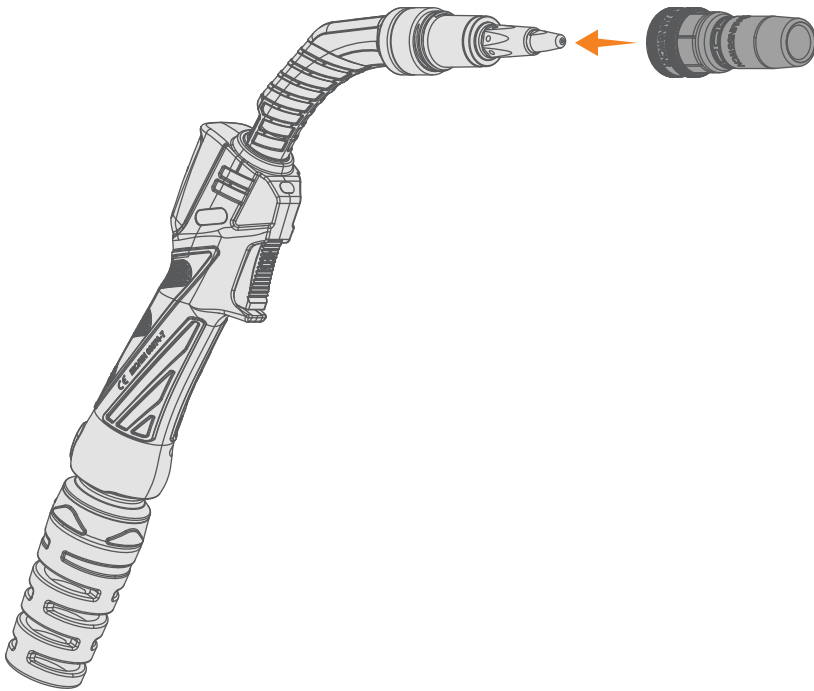

2. MIG Torch & Consumables

2.1 M350 MIG Torch

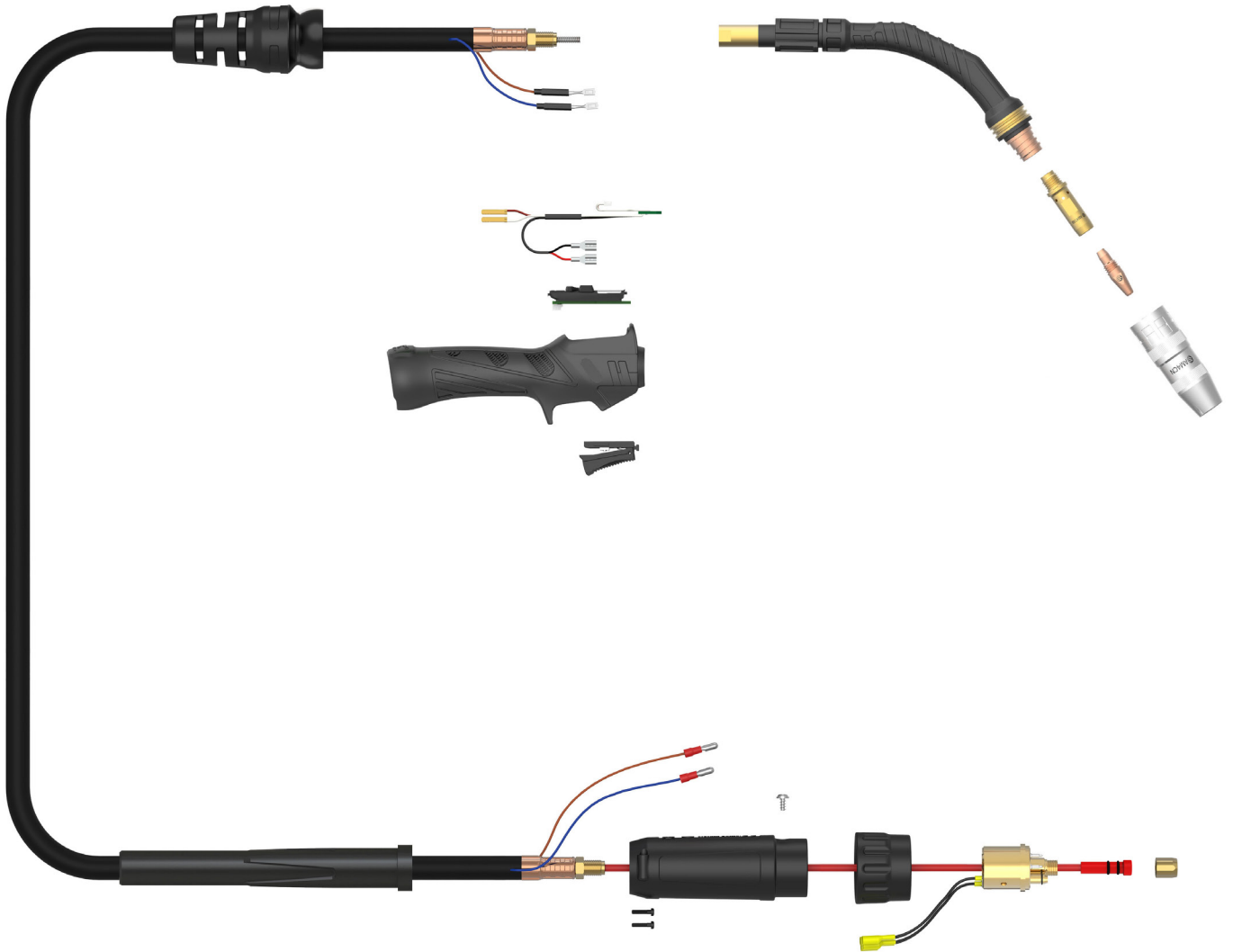

Length	3m	4m
SKU	U11071 (Suit EVOLVE), U11607 (Suit ENVY)	U11072 (Suit EVOLVE), U11608 (Suit ENVY)

COOLING METHOD	Air-Cooled
DUTY CYCLE - CO2	60% @ 350A
DUTY CYCLE - MIXED GAS	60% @ 320A
LENGTHS (m)	3, 4
WIRE SIZE	0.8-1.2mm
STANDARD	EN60974-7

2.2 M350 MIG Torch Consumables



Tip Adapter

U11060	TIP ADAPTER SUIT M350 QTY 2
---------------	-----------------------------



Contact Tips

U11171	CONTACT TIP STEEL 0.8MM SUIT M350/M580W QTY 10
U11045	CONTACT TIP STEEL 0.9MM SUIT M350/M580W QTY 10
U11046	CONTACT TIP STEEL 1.0MM SUIT M350/M580W QTY 10
U11047	CONTACT TIP STEEL 1.2MM SUIT M350/M580W QTY 10
U11050	CONTACT TIP ALUMINIUM 1.0MM SUIT M350/M580W QTY 10
U11051	CONTACT TIP ALUMINIUM 1.2MM SUIT M350/M580W QTY 10



Gas Nozzle

U11055	GAS NOZZLE WITH INSULATOR CONICAL SUIT M350 QTY 2
U11056	GAS NOZZLE WITH INSULATOR CYLINDRICAL SUIT M350 QTY 2
U11054	GAS NOZZLE WITH INSULATOR TAPERED SUIT M350 QTY 2

Liners



U11065	LINER COMBINATION 0.8-1.2MM 3M SUIT M350 QTY 1
U11066	LINER COMBINATION 0.8-1.2MM 4M SUIT M350 QTY 1
U11178	LINER STEEL 0.6-0.9MM 3M SUIT M350 QTY 1
U11179	LINER STEEL 0.6-0.9MM 4M SUIT M350 QTY 1
U11180	LINER STEEL 1.0-1.2MM 3M SUIT M350 QTY 1
U11181	LINER STEEL 1.0-1.2MM 4M SUIT M350 QTY 1

2.3 M580W MIG Torch

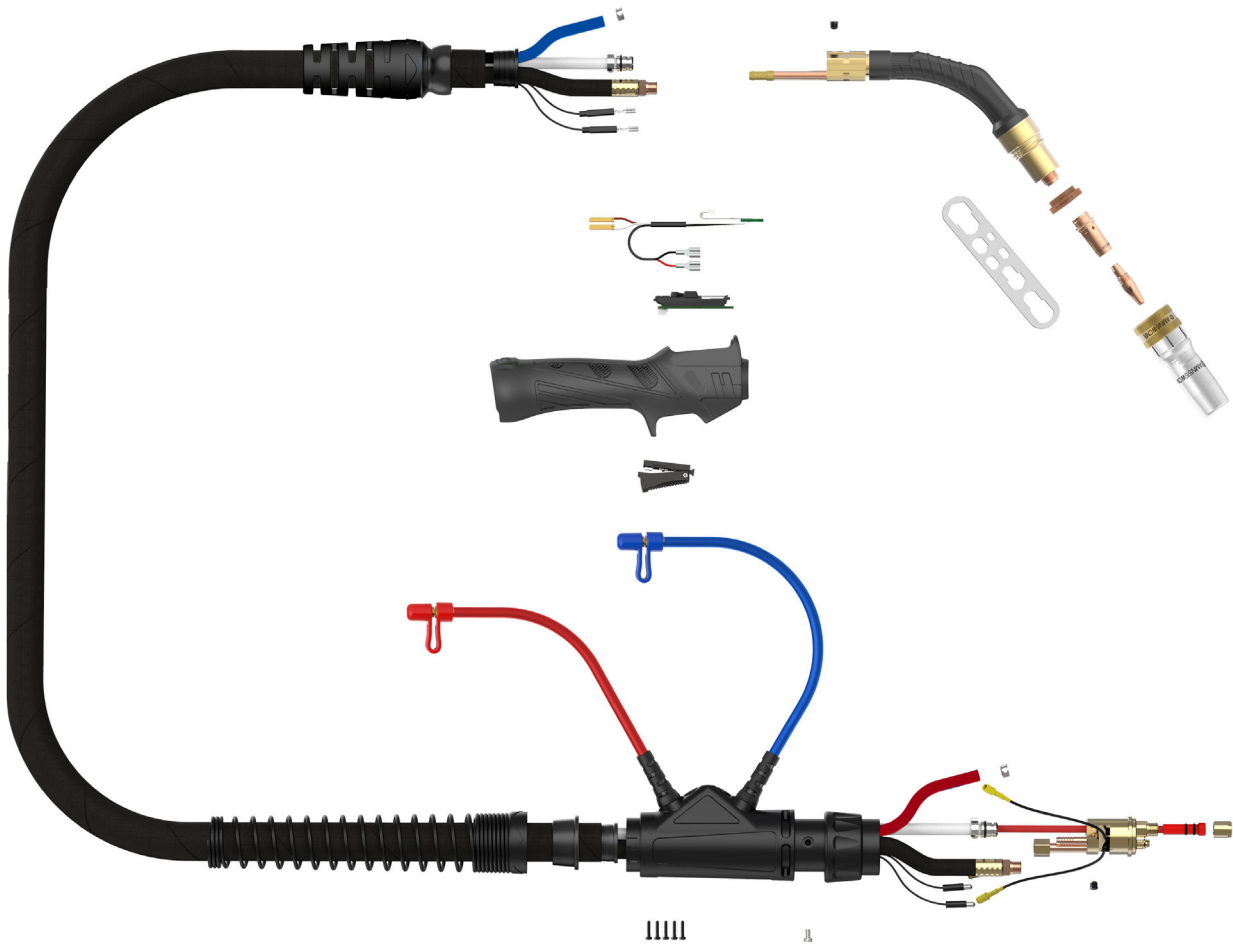

Length	3m	4m
SKU	U11073 (Suit EVOLVE), U11609 (Suit ENVY)	U11074 (Suit EVOLVE), U11610 (Suit ENVY)

COOLING METHOD	Water-Cooled
DUTY CYCLE - CO2	100% @ 580A
DUTY CYCLE - MIXED GAS	100% @ 560A
DUTY CYCLE - PULSE	100% @ 400A
LENGTHS (m)	3, 4
WIRE SIZE	0.8-1.6mm
STANDARD	EN60974-7

2.4 M580W MIG Torch Consumables



Tip Adapter Insulator

U11064	TIP ADAPTER INSULATOR SUIT M580W QTY 2
---------------	--

Tip Adapter

U11063	TIP ADAPTER SUIT M580W QTY 2
---------------	------------------------------

Contact Tips

U11171	CONTACT TIP STEEL 0.8MM SUIT M350/M580W QTY 10
U11045	CONTACT TIP STEEL 0.9MM SUIT M350/M580W QTY 10
U11046	CONTACT TIP STEEL 1.0MM SUIT M350/M580W QTY 10
U11047	CONTACT TIP STEEL 1.2MM SUIT M350/M580W QTY 10
U11048	CONTACT TIP STEEL 1.6MM SUIT M350/M580W QTY 10
U11050	CONTACT TIP ALUMINIUM 1.0MM SUIT M350/M580W QTY 10
U11051	CONTACT TIP ALUMINIUM 1.2MM SUIT M350/M580W QTY 10
U11052	CONTACT TIP ALUMINIUM 1.6MM SUIT M350/M580W QTY 10

Gas Nozzle

U11057	GAS NOZZLE WITH INSULATOR CONICAL SUIT M580W QTY 2
U11058	GAS NOZZLE WITH INSULATOR TAPERED SUIT M580W QTY 2
U11059	GAS NOZZLE WITH INSULATOR CYLINDRICAL SUIT M580W QTY 2

Liners

U11067	LINER COMBINATION 1.0-1.2MM 3M SUIT M580W QTY 1
U11068	LINER COMBINATION 1.0-1.2MM 4M SUIT M580W QTY 1
U11069	LINER COMBINATION 1.6-2.0MM 3M SUIT M580W QTY 1
U11070	LINER COMBINATION 1.6-2.0MM 4M SUIT M580W QTY 1
U11174	LINER STEEL 0.8-1.2MM 3M SUIT M580W QTY 1
U11175	LINER STEEL 0.8-1.2MM 4M SUIT M580W QTY 1

A series of horizontal dotted lines for taking notes.

UNIMIG



100%
AUSTRALIAN
OWNED

unimig.com.au

f @ UNIMIG