

UNIMIG

ARC TORCHHOLOGY
TIG TORCHES



RANGE OVERVIEW



Force Cool Technology.

Stay cooler for longer. A series of passages and wells are built into the consumables, effectively force-cooling the collet, maximising conductivity and extending consumable life.

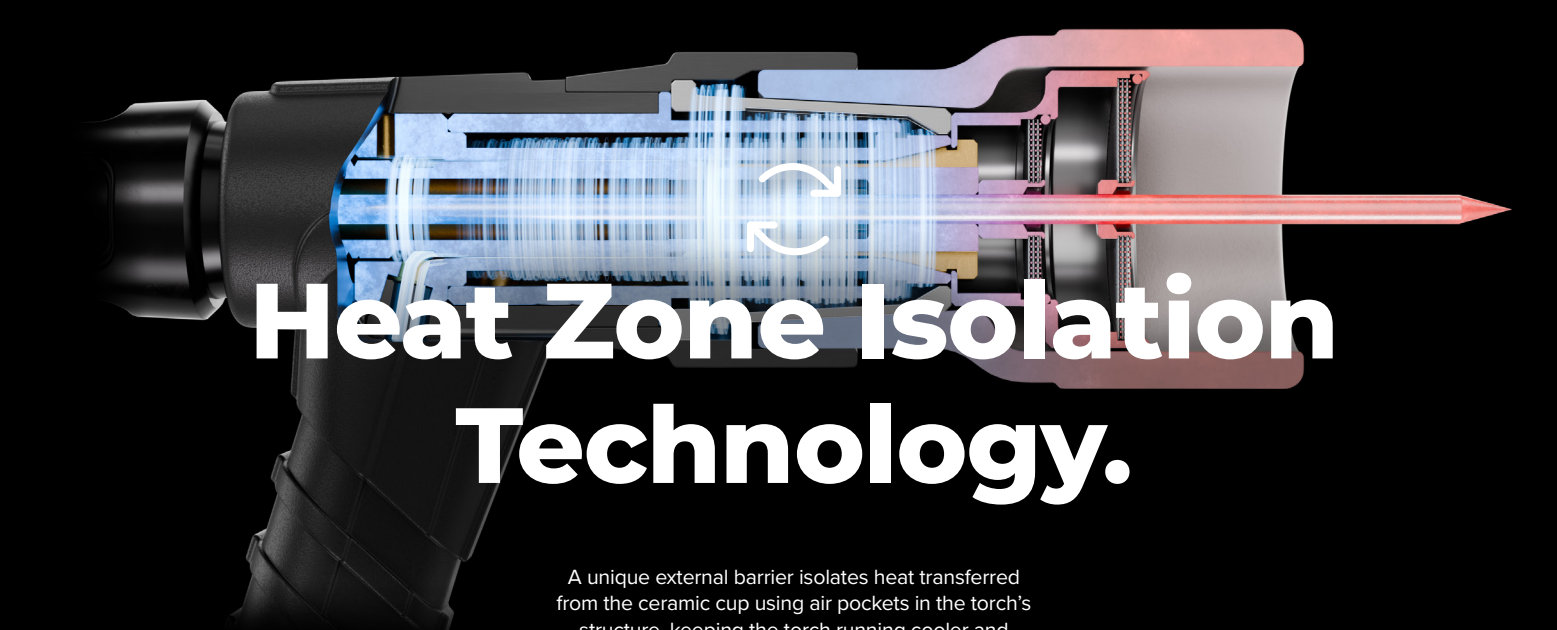

Heat Zone Isolation Technology.

A unique external barrier isolates heat transferred from the ceramic cup using air pockets in the torch's structure, keeping the torch running cooler and enhancing its power-to-weight performance ratio.



Tungsten Release System.

Instantly release your tungsten with a twist. With a 180° twist of the back cap, you get a trouble-free extension of the electrode with no need to remove any other parts to extend it.



Bi-flow Technology.

Eliminate excessive heat from your torch. High-capacity cooling chambers remove any excess heat at the source, boosting the performance of a smaller torch body.

Only available on the T3W & T4W Water-Cooled TIG Torches.

T2 TIG TORCH



**190A
OUTPUT**

PERFORMS EFFORTLESSLY ON EVERY WELD



**17% BETTER POWER-
TO-WEIGHT RATIO**

SAME SIZE AS AN SR17, WITH MORE PERFORMANCE THAN AN SR26



**UP TO 20X LONGER
CONSUMABLE LIFE**

SUPERIOR LIFE & BETTER PERFORMANCE

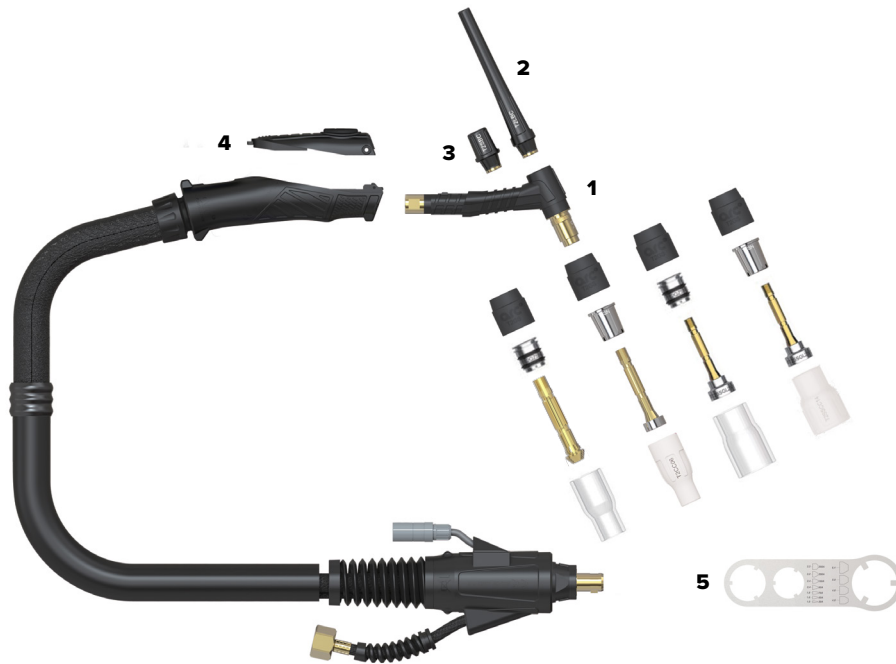

UMT2F4M TIG TORCH T2 35/50 4M

UMT2F8M TIG TORCH T2 35/50 8M

UMT24ME TIG TORCH T2 EURO 4M

Torch Spares

1	UMCT2THF	TORCH HEAD FLEXIBLE SUIT T2
	UMCT2TH	TORCH HEAD SUIT T2
2	UMCT2LBC	LONG BACK CAP SUIT T2/T3W/T4W QTY 1
3	UMCT2SBC	SHORT BACK CAP SUIT T2/T3W/T4W QTY 1
4	UMCTMS	TIG TORCH SWITCH SINGLE BUTTON SUIT T2/T3/T3W/T4W
5	UMCTSPAN	SPANNER SUIT T2/T3/T3W/T4W

Specifications

COOLING METHOD	Air-Cooled
DUTY CYCLE - DC	35% @ 190A
DUTY CYCLE - AC	35% @ 135A
DINSE SIZE	35/50
TUNGSTEN RANGE	1.0-4.0mm
STANDARD	EN60974-7

T3 TIG TORCH



**240A
OUTPUT**

PERFORMS EFFORTLESSLY ON EVERY WELD



**35% BETTER POWER-
TO-WEIGHT RATIO**

SAME SIZE AS AN SR17, WITH MORE PERFORMANCE THAN AN SR26



**UP TO 20X LONGER
CONSUMABLE LIFE**

SUPERIOR LIFE & BETTER PERFORMANCE

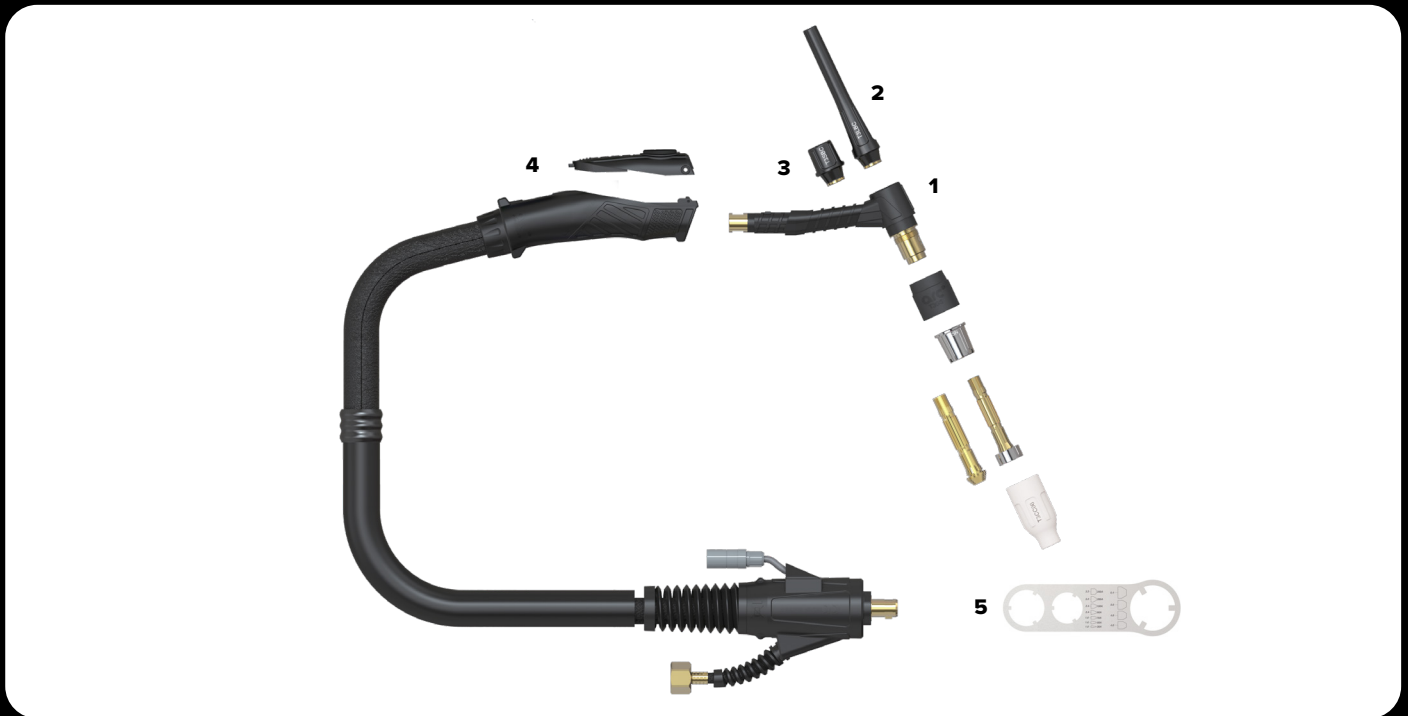

UMT3F4M TIG TORCH T3 35/50 4M

UMT3F8M TIG TORCH T3 35/50 8M

Torch Spares

1	UMCT3THF	TORCH HEAD FLEXIBLE SUIT T3 QTY 1
	UMCT3TH	TORCH HEAD SUIT T3
2	UMCT3LBC	LONG BACK CAP SUIT T3 QTY 1
3	UMCT3SBC	SHORT BACK CAP SUIT T3 QTY 1
4	UMCTMS	TIG TORCH SWITCH SINGLE BUTTON SUIT T2/T3/T3W/T4W
5	UMCTSPAN	SPANNER SUIT T2/T3/T3W/T4W

Specifications

COOLING METHOD	Air-Cooled
DUTY CYCLE - DC	35% @ 240A
DUTY CYCLE - DC	35% @ 170A
DINSE SIZE	35/50
TUNGSTEN RANGE	1.0-4.0mm
STANDARD	EN60974-7

T3W TIG TORCH



**400A
OUTPUT**

PERFORMS EFFORTLESSLY ON EVERY WELD



**28% BETTER POWER-
TO-WEIGHT RATIO**

SAME SIZE AS AN SR17, WITH MORE PERFORMANCE THAN AN SR18



**UP TO 20X LONGER
CONSUMABLE LIFE**

SUPERIOR LIFE & BETTER PERFORMANCE

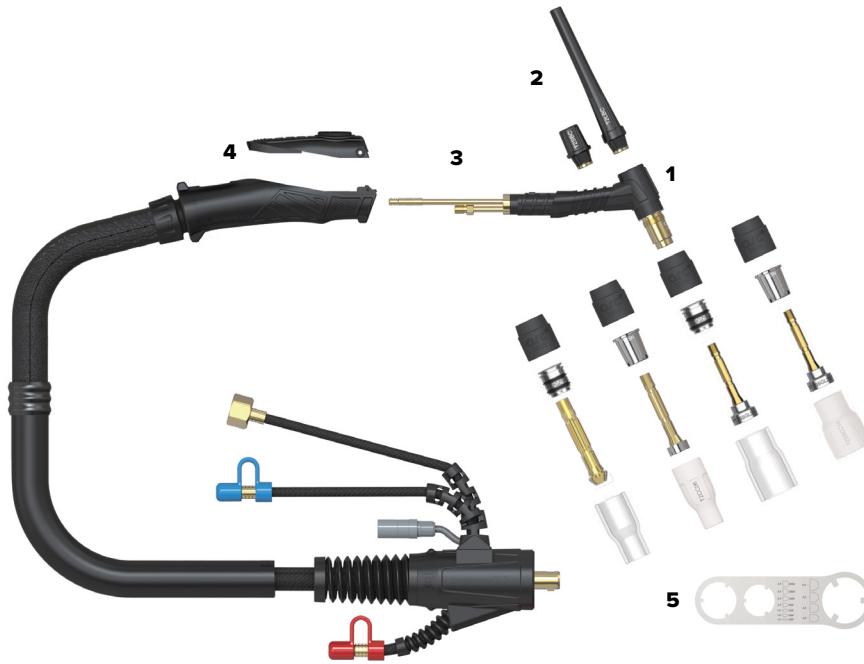

T3W-3KHL-4M TIG TORCH T3W 35/50 4M

T3W-3KHL-8M TIG TORCH T3W 35/50 8M

Torch Spares

1	UMCT3WTHF	TORCH HEAD FLEXIBLE SUIT T3W/T4W
	UMCT3WTH	TORCH HEAD SUIT T3W/T4W
2	UMCT2LBC	LONG BACK CAP SUIT T2/T3W/T4W QTY 1
3	UMCT2SBC	SHORT BACK CAP SUIT T2/T3W/T4W QTY 1
4	UMCTMS	TIG TORCH SWITCH SINGLE BUTTON SUIT T2/T3/T3W/T4W
5	UMCTSPAN	SPANNER SUIT T2/T3/T3W/T4W

Specifications

COOLING METHOD	Water-Cooled	MINIMUM WATER FLOW	1.5L/min
DUTY CYCLE - DC	100% @ 400A	MINIMUM WATER INLET PRESSURE	3.0 Bar
DUTY CYCLE - AC	100% @ 280A	MAXIMUM WATER INLET PRESSURE	5.0 Bar
DINSE SIZE	35/50	MAXIMUM WATER INLET TEMPERATURE	50°C
TUNGSTEN RANGE	1.0-4.0mm	MINIMUM COOLING POWER	900W
STANDARD	EN60974-7		

T4W TIG TORCH



**450A
OUTPUT**

PERFORMS EFFORTLESSLY ON EVERY WELD



**18% BETTER POWER-
TO-WEIGHT RATIO**

SAME SIZE AS AN SR17, WITH MORE PERFORMANCE THAN AN SR18



**UP TO 20X LONGER
CONSUMABLE LIFE**

SUPERIOR LIFE & BETTER PERFORMANCE

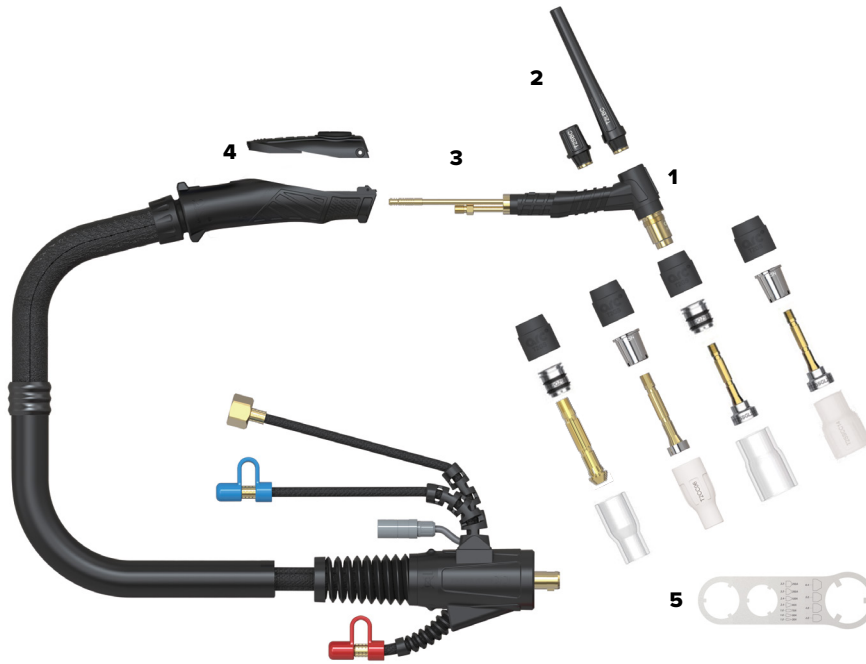

U11209 TIG TORCH T4W 35/50 4M

U11210 TIG TORCH T4W 35/50 8M

Torch Spares

1	UMCT3WTHF	TORCH HEAD FLEXIBLE SUIT T3W/T4W
	UMCT3WTH	TORCH HEAD SUIT T3W/T4W
2	UMCT2LBC	LONG BACK CAP SUIT T2/T3W/T4W QTY 1
3	UMCT2SBC	SHORT BACK CAP SUIT T2/T3W/T4W QTY 1
4	UMCTMS	TIG TORCH SWITCH SINGLE BUTTON SUIT T2/T3/T3W/T4W
5	UMCTSPAN	SPANNER SUIT T2/T3/T3W/T4W

Specifications

COOLING METHOD	Water-Cooled	MINIMUM WATER FLOW	1.5L/min
DUTY CYCLE - DC	100% @ 450A	MINIMUM WATER INLET PRESSURE	3.0 Bar
DUTY CYCLE - AC	100% @ 315A	MAXIMUM WATER INLET PRESSURE	5.0 Bar
DINSE SIZE	35/50	MAXIMUM WATER INLET TEMPERATURE	50°C
TUNGSTEN RANGE	1.6-4.8mm	MINIMUM COOLING POWER	1600W
STANDARD	EN60974-7		

T2/T3W/T4W TIG Torch Consumables

Standard



Head Gasket

UMCT2HG HEAD GASKET SUIT T2/T3W/T4W QTY 1



Heat Zone Isolator

UMCT2SN HEAT ZONE ISOLATOR SUIT T2/T3W/T4W QTY 1

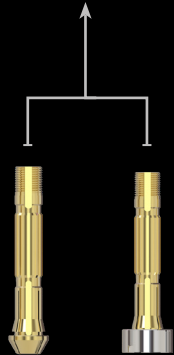

Collet Body

UMCT2CB10	COLLET BODY SUIT T2/T3W/T4W 1.0MM QTY 1
UMCT2CB16	COLLET BODY SUIT T2/T3W/T4W 1.6MM QTY 1
UMCT2CB24	COLLET BODY SUIT T2/T3W/T4W 2.4MM QTY 1
UMCT2CB32	COLLET BODY SUIT T2/T3W/T4W 3.2MM QTY 1
UMCT2GL10	GAS LENS COLLET BODY SUIT T2/T3W/T4W 1.0MM QTY 1
UMCT2GL16	GAS LENS COLLET BODY SUIT T2/T3W/T4W 1.6MM QTY 1
UMCT2GL24	GAS LENS COLLET BODY SUIT T2/T3W/T4W 2.4MM QTY 1
UMCT2GL32	GAS LENS COLLET BODY SUIT T2/T3W/T4W 3.2MM QTY 1



Ceramic Cup

UMCT2C04	CERAMIC CUP SUIT T2/T3W/T4W SIZE 4 6MM QTY 1
UMCT2C05	CERAMIC CUP SUIT T2/T3W/T4W SIZE 5 8MM QTY 1
UMCT2C06	CERAMIC CUP SUIT T2/T3W/T4W SIZE 6 10MM QTY 1
UMCT2C07	CERAMIC CUP SUIT T2/T3W/T4W SIZE 7 11MM QTY 1
UMCT2C08	CERAMIC CUP SUIT T2/T3W/T4W SIZE 8 12.5MM QTY 1
UMCT2C10	CERAMIC CUP SUIT T2/T3W/T4W SIZE 10 16MM QTY 1

Quartz



Head Gasket

UMCT2HG HEAD GASKET SUIT T2/T3W/T4W QTY 1



Heat Zone Isolator

UMCT2QZSN QUARTZ ZONE ISOLATOR SUIT T2/T3W/T4W QTY 1

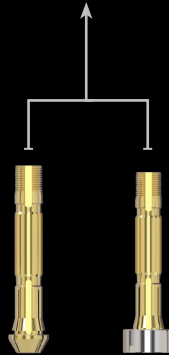

Collet Body

UMCT2CB10	COLLET BODY SUIT T2/T3W/T4W 1.0MM QTY 1
UMCT2CB16	COLLET BODY SUIT T2/T3W/T4W 1.6MM QTY 1
UMCT2CB24	COLLET BODY SUIT T2/T3W/T4W 2.4MM QTY 1
UMCT2CB32	COLLET BODY SUIT T2/T3W/T4W 3.2MM QTY 1
UMCT2GL10	GAS LENS COLLET BODY SUIT T2/T3W/T4W 1.0MM QTY 1
UMCT2GL16	GAS LENS COLLET BODY SUIT T2/T3W/T4W 1.6MM QTY 1
UMCT2GL24	GAS LENS COLLET BODY SUIT T2/T3W/T4W 2.4MM QTY 1
UMCT2GL32	GAS LENS COLLET BODY SUIT T2/T3W/T4W 3.2MM QTY 1



Quartz Cup

UMCT2QZ06	QUARTZ CUP SUIT T2/T3W/T4W SIZE 6 QTY 1
UMCT2QZ08	QUARTZ CUP SUIT T2/T3W/T4W SIZE 8 QTY 1
UMCT2QZ10	QUARTZ CUP SUIT T2/T3W/T4W SIZE 9 QTY 1

T3 TIG Torch Consumables



Head Gasket

UMCT3HG HEAD GASKET SUIT T3 QTY 1



Heat Zone Isolator

UMCT3SN HEAT ZONE ISOLATOR SUIT T3 QTY 1

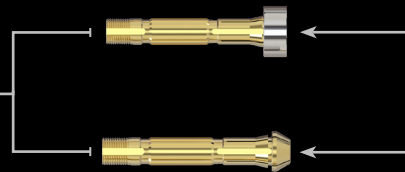

Collet Body

UMCT3CB16	COLLET BODY SUIT T3 1.6MM QTY 1
UMCT3CB24	COLLET BODY SUIT T3 2.4MM QTY 1
UMCT3CB32	COLLET BODY SUIT T3 3.2MM QTY 1
UMCT3GL16	GAS LENS COLLET BODY SUIT T3 1.6MM QTY 1
UMCT3GL24	GAS LENS COLLET BODY SUIT T3 2.4MM QTY 1
UMCT3GL32	GAS LENS COLLET BODY SUIT T3 3.2MM QTY 1



Ceramic Cup

UMCT3C04	CERAMIC CUP SUIT T3 SIZE 4 6MM QTY 1
UMCT3C05	CERAMIC CUP SUIT T3 SIZE 5 8MM QTY 1
UMCT3C06	CERAMIC CUP SUIT T3 SIZE 6 10MM QTY 1
UMCT3C07	CERAMIC CUP SUIT T3 SIZE 7 11MM QTY 1
UMCT3C08	CERAMIC CUP SUIT T3 SIZE 8 12.5MM QTY 1
UMCT3C10	CERAMIC CUP SUIT T3 SIZE 10 16MM QTY 1

T2/T3W/T4W TIG Torch Consumables

SUPER Series



Head Gasket

UMCT2HG	HEAD GASKET SUIT T2/T3W/T4W QTY 1
----------------	-----------------------------------



Heat Zone Isolator

UMCT2SN	HEAT ZONE ISOLATOR SUIT T2/T3W/T4W QTY 1
----------------	--



Collet Body

UMCT2SSGL2016	GAS LENS COLLET BODY SUPER12 SUIT T2/T3W/T4W 1.6MM QTY 1
UMCT2SSGL2024	GAS LENS COLLET BODY SUPER12 SUIT T2/T3W/T4W 2.4MM QTY 1
UMCT2SSGL2032	GAS LENS COLLET BODY SUPER12 SUIT T2/T3W/T4W 3.2MM QTY 1
UMCT2SSGL2316	GAS LENS COLLET BODY SUPER14 SUIT T2/T3W/T4W 1.6MM QTY 1
UMCT2SSGL2324	GAS LENS COLLET BODY SUPER14 SUIT T2/T3W/T4W 2.4MM QTY 1
UMCT2SSGL2332	GAS LENS COLLET BODY SUPER14 SUIT T2/T3W/T4W 3.2MM QTY 1
UMCT2SSGL2816	GAS LENS COLLET BODY SUPER18 SUIT T2/T3W/T4W 1.6MM QTY 1
UMCT2SSGL2824	GAS LENS COLLET BODY SUPER18 SUIT T2/T3W/T4W 2.4MM QTY 1
UMCT2SSGL2832	GAS LENS COLLET BODY SUPER18 SUIT T2/T3W/T4W 3.2MM QTY 1



Ceramic Cup

UMCT2SSCC12	CERAMIC CUP SUPER12 SUIT T2/T3W/T4W SIZE 12 QTY 1
UMCT2SSCC14	CERAMIC CUP SUPER14 SUIT T2/T3W/T4W SIZE 14 QTY 1
UMCT2SSCC18	CERAMIC CUP SUPER18 SUIT T2/T3W/T4W SIZE 18 QTY 1

SUPER Series Quartz



Head Gasket

UMCT2HG	HEAD GASKET SUIT T2/T3W/T4W QTY 1
----------------	-----------------------------------



Heat Zone Isolator

UMCT2QZSN	QUARTZ ZONE ISOLATOR SUIT T2/T3W/T4W QTY 1
------------------	--



Collet Body

UMCT2SSGL2016	GAS LENS COLLET BODY SUPER12 SUIT T2/T3W/T4W 1.6MM QTY 1
UMCT2SSGL2024	GAS LENS COLLET BODY SUPER12 SUIT T2/T3W/T4W 2.4MM QTY 1
UMCT2SSGL2032	GAS LENS COLLET BODY SUPER12 SUIT T2/T3W/T4W 3.2MM QTY 1
UMCT2SSGL2316	GAS LENS COLLET BODY SUPER14 SUIT T2/T3W/T4W 1.6MM QTY 1
UMCT2SSGL2324	GAS LENS COLLET BODY SUPER14 SUIT T2/T3W/T4W 2.4MM QTY 1
UMCT2SSGL2332	GAS LENS COLLET BODY SUPER14 SUIT T2/T3W/T4W 3.2MM QTY 1
UMCT2SSGL2816	GAS LENS COLLET BODY SUPER18 SUIT T2/T3W/T4W 1.6MM QTY 1
UMCT2SSGL2824	GAS LENS COLLET BODY SUPER18 SUIT T2/T3W/T4W 2.4MM QTY 1
UMCT2SSGL2832	GAS LENS COLLET BODY SUPER18 SUIT T2/T3W/T4W 3.2MM QTY 1



Quartz Cup

UMCT2SSQZ12	QUARTZ CUP SUPER12 SUIT T2/T3W/T4W SIZE 12 QTY 1
UMCT2SSQZ14	QUARTZ CUP SUPER14 SUIT T2/T3W/T4W SIZE 14 QTY 1
UMCT2SSQZ18	QUARTZ CUP SUPER18 SUIT T2/T3W/T4W SIZE 18 QTY 1

STARTER KITS

T2/T3W/T4W Consumable Starter Kit



Now more versatile and with a wider range of sizes for ceramic and quartz cups than ever, the T2 TIG Torch Consumable Starter Kit comes with everything you need to get welding across a wide range of applications.

Package Contents

- 1 x Ceramic Cup Size 7 (UMCT2C07)
- 1 x Ceramic Cup Size 8 (UMCT2C08)
- 1 x Ceramic Cup Size 10 (UMCT2C10)
- 1 x Gas Lens Collet Body 1.6mm (UMCT2GL16)
- 1 x Gas Lens Collet Body 2.4mm (UMCT2GL24)
- 1 x Head Gasket (UMCT2HG)
- 1 x Heat Zone Isolator (UMCT2SN)
- 1 x Quartz Cup Size 6 (UMCT2QZ06)
- 1 x Quartz Cup Size 8 (UMCT2QZ08)
- 1 x Quartz Cup Size 10 (UMCT2QZ10)
- 1 x Quartz Zone Isolator (UMCT2QZSN)
- 2 x Rare Earth Tungsten Electrode 1.6mm (TR000516)
- 2 x Rare Earth Tungsten Electrode 2.4mm (TR000524)
- 1 x Short Back Cap (UMCT2SBC)

SKU	DESCRIPTION
U42005	CONSUMABLE STARTER KIT SUIT T2/T3W/T4W

T2/T3W/T4W Super Series Starter Kit



Get the best coverage possible with our range of ceramic and quartz cups in sizes 12, 14 and 18. Paired with the gas lenses and you'll never have another contaminated weld.

Package Contents

- 1 x SUPER12 Gas Lens Collet Body 1.6mm (UMCT2SSGL2016)
- 1 x SUPER12 Gas Lens Collet Body 2.4mm (UMCT2SSGL2024)
- 1 x SUPER14 Gas Lens Collet Body 1.6mm (UMCT2SSGL2316)
- 1 x SUPER14 Gas Lens Collet Body 2.4mm (UMCT2SSGL2324)
- 1 x SUPER18 Gas Lens Collet Body 1.6mm (UMCT2SSGL2816)
- 1 x SUPER18 Gas Lens Collet Body 2.4mm (UMCT2SSGL2824)
- 1 x SUPER12 Ceramic Cup (UMCT2SSCC12)
- 1 x SUPER14 Ceramic Cup (UMCT2SSCC14)
- 1 x SUPER18 Ceramic Cup (UMCT2SSCC18)
- 1 x SUPER12 Quartz Cup (UMCT2SSQZ12)
- 1 x SUPER14 Quartz Cup (UMCT2SSQZ14)
- 1 x SUPER18 Quartz Cup (UMCT2SSQZ18)
- 1 x Quartz Heat Zone Isolator (UMCT2QZSN)

SKU	DESCRIPTION
U42006	SUPER SERIES KIT SUIT T2/T3W/T4W

The **Arc Torchology** TIG consumable range is now complete, featuring both ceramic and quartz cups. The **Standard Series** covers cup sizes 4 to 10, perfect for your everyday TIG welding. Our **Super Series** features larger 12, 14 and 18 cup sizes for maximum gas coverage.

Get unmatched visibility with our quartz cups. Sick of not being able to see what you're doing through your ceramic cup? Swap to a quartz! Made with specially tempered glass, they're extra heat resistant, and they're see-through. On top of great weld visibility, our quartz cups are designed to be used with our gas lens, so the shrouds are wider, giving you greater gas coverage.

The Gas Lens Collet Bodies come with a diffuser and a mesh screen, so they're wider, but distribute gas more evenly and with less turbulence over the weld. You can have the tungsten stick out further, giving you better manoeuvrability and visibility of the weld pool. They're perfect for welding inside corners or in tight spaces.



UNIMIG

B U I L T F O R W E L D E R S



100%
AUSTRALIAN
OWNED

unimig.com.au

    @UNIMIG